

# SIGNATURE

## NORTH EAST

OFFICIALLY RATED THE NO.1 ESTATE AGENT IN THE NORTH EAST





📍 South Park, Morpeth NE61 6NX

# South Park Morpeth NE61 6NX

Asking Price £1,000,000

Signature NorthEast is thrilled to present this exceptional three-bedroom detached home, gracefully situated in the esteemed Hepscott area. Meticulously renovated, the property seamlessly combines original charm with contemporary features. Spanning over an acre of meticulously landscaped grounds, the residence is securely enveloped by electric gates with an intercom system and comprehensive CCTV coverage. This prime location not only offers tranquility but also provides easy access to an array of amenities in the picturesque town of Morpeth, where a delightful selection of local shops and restaurants awaits your exploration.

Stepping into this captivating property, you are greeted by a grand central hallway that gracefully connects to the main principal rooms on the ground floor. The journey begins in the living room, showcasing one of the four stunning log burner fireplaces that adorn this home. This room boasts generous space, providing an ideal canvas for your preferred furnishings. Continuing through, you enter the garden room, bathed in natural light streaming through large windows and elegant French doors leading to the rear garden.

As you explore further, you'll encounter the impressive open-plan kitchen/family/dining room, meticulously redesigned to offer an abundance of space for both living and dining furnishings. Skylight windows bathe the area in natural light, creating an inviting atmosphere. The kitchen, adorned with attractive shaker-style wall and base units, seamlessly blends style with convenience. A central island, complete with a breakfast bar, forms an ideal setting for casual dining. The kitchen is fully equipped with integrated appliances, including 2 ovens, a microwave, a dishwasher, two 60/40 fridges, and a ceramic side burner hob.

Continuing the journey, you'll discover the versatile sitting room, a space ready to be transformed to suit your specific needs. Concluding the ground floor is the shower room, featuring beautiful ornate tiling, a walk-in shower, a hand basin, and a WC, adding a touch of elegance to this meticulously designed home.

Ascending to the first floor, you will be greeted by three generously sized bedrooms, each adorned with a stunning bay window, capable of accommodating a king-size bed alongside your preferred furnishings. The master bedroom stands out with the added convenience of fitted wardrobes, providing ample storage space. Completing this floor is a conveniently located WC, adding a touch of practicality to the elegant design of the home.

Externally, to the rear of the residence, awaits an expansive back garden adorned with a lush, well-maintained lawn. Encircled by mature trees, plants, and greenery, the outdoor space is enhanced by a dedicated play area for older children, offering both beauty and functionality. This garden truly encapsulates a sense of luxury.

Adding to the appeal, a vast driveway provides abundant off-street parking for up to 11 cars, leading to a detached triple garage. This detached annex further elevates the property's charm, boasting its own open-plan kitchen-dining room adorned with high-gloss units. The annex includes a fully tiled shower room and a spacious bedroom area, completing this versatile and stylish addition to the home.





### Why Signature?

Signature North East reach 150,000 per month on social media. We cover 19 locations in the North East. At signature we keep our doors open from 8AM - 8PM, when other estate agents are closed. We are a customer 5 star rated agent on allagents.co.uk. With a dedicated group of negotiators across the region, to the 'behind the scenes' Head Office team, each member of staff is passionate about the industry and cares about every client; you're at the heart of everything we do!

PLEASE NOTE THAT THE VENDOR HAS CERTIFIED THE PROPERTY INFORMATION AND IMAGES.

# PROPERTY FLOORPLAN

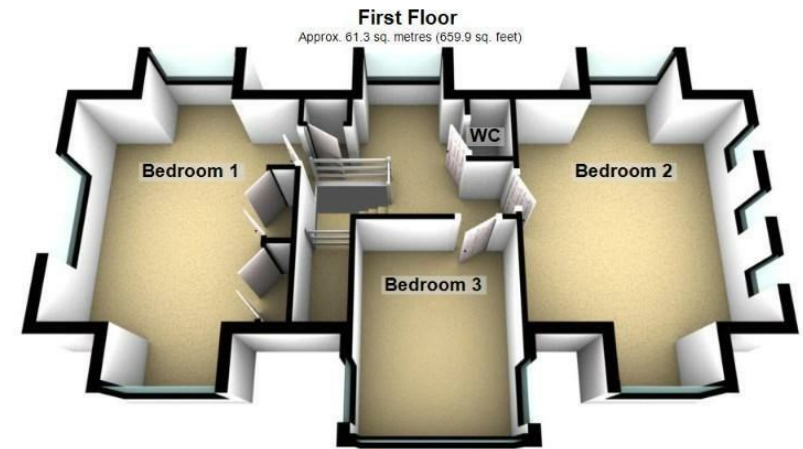
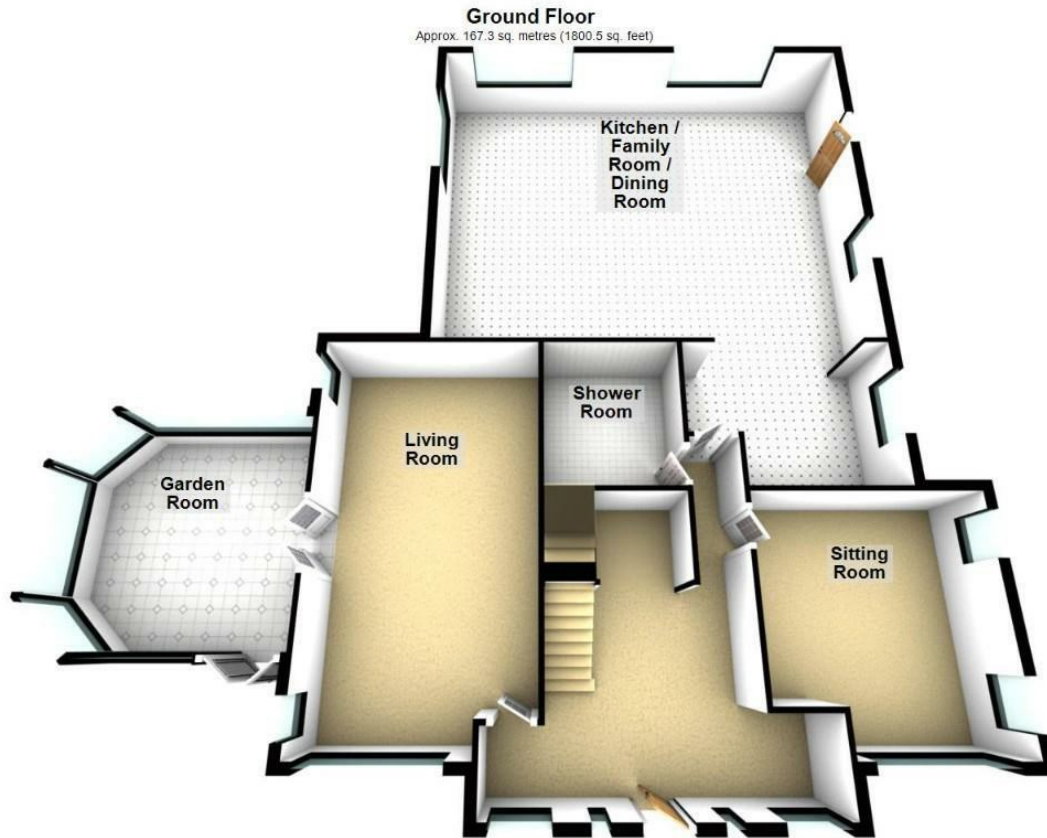

Total area: approx. 228.6 sq. metres (2460.4 sq. feet)

Please be advised the floorplans are not drawn to scale and are to be used to give an idea of the layout of the property.  
Plan produced using PlanUp.

**EPC RATING: D**



More 5 Star Customer Reviews than any other Agent based in the North East on allAgents.co.uk



**SALES**

**LETTINGS**

**FINANCE**

**LAW**

**WE COVER THE WHOLE OF THE NORTH EAST**

Whitley Bay  
0191 251 3344

Cramlington  
01670 897 213

Tynemouth  
0191 296 6689

Morpeth  
01670 513 966

Ponteland  
01661 820 082

Wallsend  
0191 432 4151

Alnwick  
01665 511 800

Heaton  
0191 432 4275

Forest Hall  
0191 266 9966

Other locations  
0191 640 3523

Newcastle  
0191 640 2284

Durham  
0191 303 8252

Gosforth  
0191 640 3523

Sunderland  
0191 543 6390

Whickham  
0191 432 5102

Gateshead  
0191 432 4294

Jesmond  
0191 281 1037

Killingworth  
0191 640 3602

Ryton  
0191 413 9845

Head Office &  
Lettings  
0191 253 4815

\*Highest recommended 5-star reviews than any other Estate Agent based in the North East on allAgents.co.uk - The UK's Largest Customer Review Website for the Property Industry & Awarded Best Estate Agency 2018 & 2019 - North East England by SME News