

SIGNATURE

NORTH EAST

OFFICIALLY RATED THE NO.1 ESTATE AGENT IN THE NORTH EAST





The Turn, Morpeth NE61 2DU

The Turn, Morpeth NE61 2DU

£295,000

Signature North East is delighted to present this charming three-bedroom semi-detached home nestled on The Turn in the highly sought-after Morpeth. This property showcases generously sized rooms throughout, offering comfortable and spacious living. This home benefits from a great location that includes excellent transportation links to the city centre, a plethora of useful amenities such as eateries, shops, and is in close proximity to schools for all ages, making this home a great opportunity for families.

Upon entering the home, you are greeted by a lovely vestibule which then leads to the entrance hallway. From here you are granted access to a conveniently under-stair storage cupboard and the principal ground floor rooms. The first room you enter is the living room, illuminated with natural light thanks to the gorgeous bay window. Adding to the charm the room features a fireplace and surround creating a cosy atmosphere, along with ample space suited for any desired furnishings. This cosy atmosphere leads into the dining room which provides ample space for a dining table and other furnishings. Next is the Conservatory, bathed in natural light, this room offers the perfect retreat to unwind and watch over the garden. The kitchen boasts ample storage space via the charming wall and base units, complimented by a lovely breakfast bench creating a casual dining spot. You then step into the utility room which offers extra storage space for your convenience. Additionally, you are granted access to a convenient W.C. and the back garden.

Ascending to the first floor, you will find three generously sized rooms, two of which can easily accommodate a double bed and other furnishings as well as benefitting from built in storage space. The third bedroom is perfect as a single or could be utilised as a home office/study or dressing room depending on your needs. Completing the floor is the modern family bathroom with a bath, shower, w.c. and sink.

Externally to the rear of the home finds a generous garden which boasts a spacious lawn area and a patio which is perfect for alfresco dining. The garden is surrounded by mature hedges and shrubbery creating a private and tranquil environment. To the front of the home is a block paved driveway and a garage, providing off street parking for multiple vehicles.

****This property has previously had planning permission granted for an extension over garage for a bedroom and en-suite****



PLEASE NOTE THAT THE VENDOR HAS CERTIFIED THE PROPERTY INFORMATION AND IMAGES.

PROPERTY FLOORPLAN

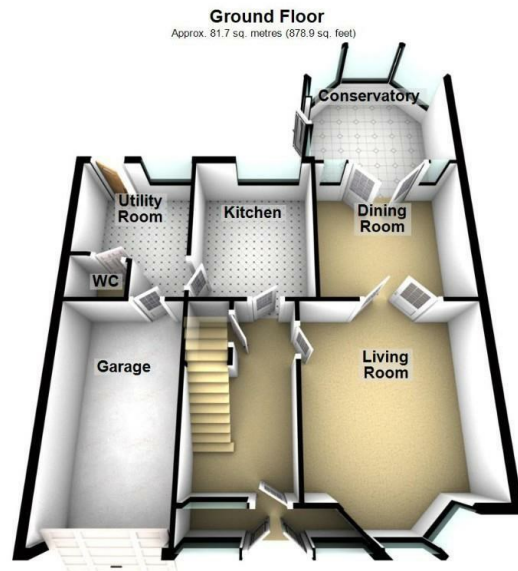

Ground Floor
Approx. 81.7 sq. metres (878.9 sq. feet)



First Floor
Approx. 45.4 sq. metres (488.6 sq. feet)

Total area: approx. 127.0 sq. metres (1367.5 sq. feet)

Please be advised the floorplans are not drawn to scale and are to be used to give an idea of the layout of the property.
Plan produced using PlanUp.

Measurements:

Living Room
15'5" x 12'5"

Dining Room
11'1" x 10'11"

Kitchen
10'11" x 8'11"

Conservatory
11'3" x 11'0"

Utility Room
10'9" x 8'4"

WC
4'2" x 3'1"

Bedroom One
12'6" x 11'6"

Bedroom Two
12'0" x 11'2"

Bedroom Three
9'4" x 8'8"

Bathroom
8'0" x 7'10"

Energy Efficiency Rating

	Current	Potential
Very energy efficient - lower running costs		
(92 plus) A		87
(81-91) B		
(69-80) C	72	
(55-68) D		
(39-54) E		
(21-38) F		
(1-20) G		
Not energy efficient - higher running costs		
England & Wales	EU Directive 2002/91/EC 	





More 5 Star Customer Reviews than any other Agent based in the North East on allAgents.co.uk



SALES

LETTINGS

FINANCE

LAW

WE COVER THE WHOLE OF THE NORTH EAST

Whitley Bay
0191 251 3344

Cramlington
01670 897 213

Tynemouth
0191 296 6689

Morpeth
01670 513 966

Ponteland
01661 820 082

Wallsend
0191 432 4151

Alnwick
01665 511 800

Heaton
0191 432 4275

Forest Hall
0191 266 9966

Other locations
0191 640 3523

Newcastle
0191 640 2284

Durham
0191 303 8252

Gosforth
0191 640 3523

Sunderland
0191 543 6390

Whickham
0191 432 5102

Gateshead
0191 432 4294

Jesmond
0191 281 1037

Killingworth
0191 640 3602

Ryton
0191 413 9845

Head Office &
Lettings
0191 253 4815

*Highest recommended 5-star reviews than any other Estate Agent based in the North East on allAgents.co.uk - The UK's Largest Customer Review Website for the Property Industry & Awarded Best Estate Agency 2018 & 2019 - North East England by SME News