

# SIGNATURE

## NORTH EAST

OFFICIALLY RATED THE NO.1 ESTATE AGENT IN THE NORTH EAST







📍 St Annes Quay, Quayside NE1 3BB



# St Annes Quay, Quayside NE1 3BB

**Asking Price**  
**£110,000**

Ideally located on the Newcastle Quayside is this fantastic top floor flat. This one bedroom property offers stunning views and offers a fantastic opportunity to acquire a property within this area. This property is to be sold to investors only with tenant in situ.

The property begins with a welcoming hallway which provides access to all principal rooms of the property. The property is comprised of a sizable living room which offers views of the Quayside, and a spacious kitchen that benefits from fitted wall, base and drawer units. The property offers one ample sized bedroom that also showcases views of the breathtaking Newcastle Quayside and a modern three piece family bathroom.

Having undergone waves of regeneration, Newcastle Quayside is now a popular residential area on the north bank of the River Tyne in close proximity to Newcastle city centre and directly adjacent to the borough of Gateshead across the river. The area is famed for its versatile range of upmarket bars, cafés and restaurants and the neighbouring and widely renowned Baltic Art Gallery and Sage concert venue.



Council Tax Band: C  
Tenure: Leasehold - 979 years remaining  
Maintenance Charge: Approximately £2000-£2400 per annum  
Ground Rent Charge: £300 per annum

PLEASE NOTE THAT THE VENDOR HAS CERTIFIED THE PROPERTY INFORMATION AND IMAGES.

# PROPERTY FLOORPLAN

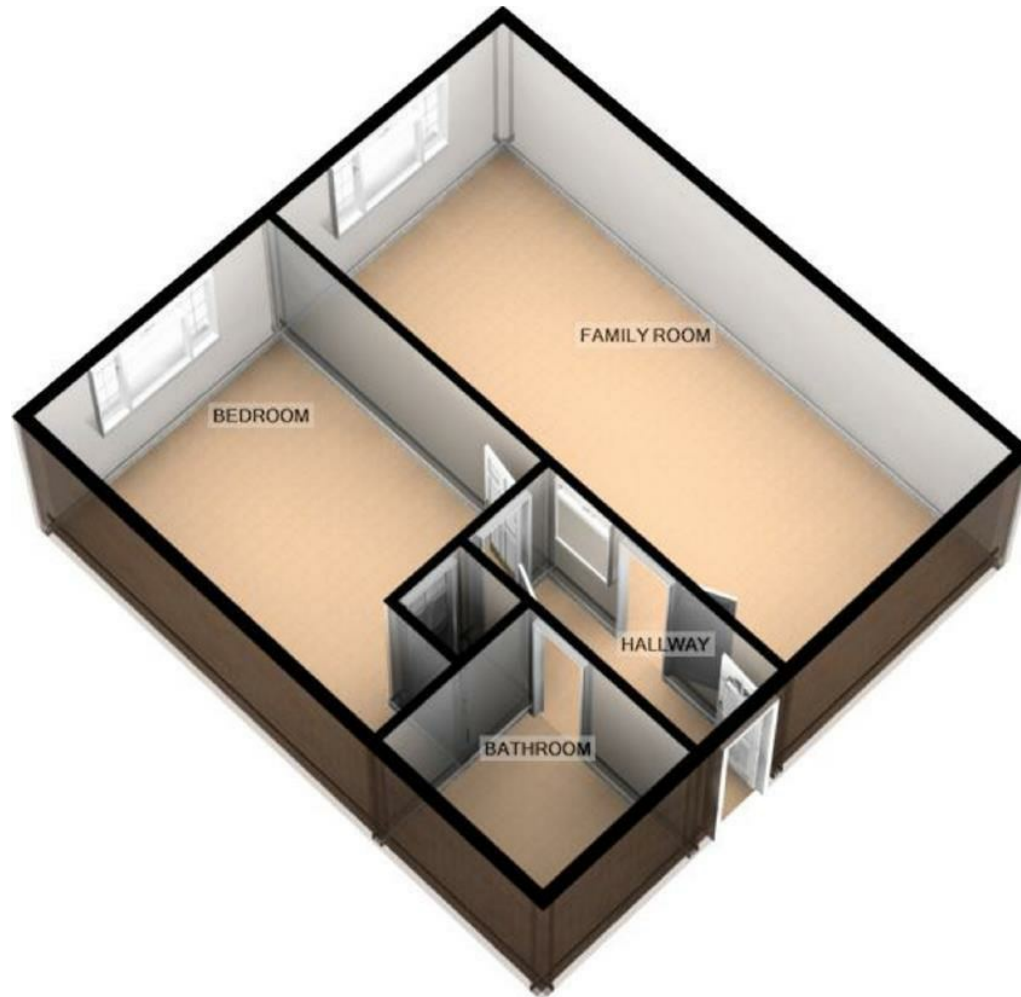

ST. ANNES QUAY, NEWCASTLE

For illustrative purposes only. Decorative finishes, fixtures, fittings and furnishings do not represent the current state of the property. Measurements are approximate. Not to scale  
Made with Metropix ©2016

## Measurements:

LIVING/KITCHEN  
23'5" x 10'6"

BEDROOM  
15'6" x 10'4"

BATHROOM  
7'2" x 5'7"

## Energy Efficiency Rating

	Current	Potential
Very energy efficient - lower running costs		
(92 plus) <b>A</b>		<b>87</b>
(81-91) <b>B</b>	<b>76</b>	
(69-80) <b>C</b>		
(55-68) <b>D</b>		
(39-54) <b>E</b>		
(21-38) <b>F</b>		
(1-20) <b>G</b>		
Not energy efficient - higher running costs		
<b>England &amp; Wales</b>	EU Directive 2002/91/EC	









More 5 Star Customer Reviews than any other Agent based in the North East on [allAgents.co.uk](https://allagents.co.uk)



**SALES**

**LETTINGS**

**FINANCE**

**LAW**

**WE COVER THE WHOLE OF THE NORTH EAST**

Whitley Bay  
0191 251 3344

Cramlington  
01670 897 213

Tynemouth  
0191 296 6689

Morpeth  
01670 513 966

Ponteland  
01661 820 082

Wallsend  
0191 432 4151

Alnwick  
01665 511 800

Heaton  
0191 432 4275

Forest Hall  
0191 266 9966

Other locations  
0191 640 3523

Newcastle  
0191 640 2284

Durham  
0191 303 8252

Gosforth  
0191 640 3523

Sunderland  
0191 543 6390

Whickham  
0191 432 5102

Gateshead  
0191 432 4294

Jesmond  
0191 281 1037

Killingworth  
0191 640 3602

Ryton  
0191 413 9845

Head Office &  
Lettings  
0191 253 4815

\*Highest recommended 5-star reviews than any other Estate Agent based in the North East on [allAgents.co.uk](https://allagents.co.uk) - The UK's Largest Customer Review Website for the Property Industry & Awarded Best Estate Agency 2018 & 2019 - North East England by SME News