

SIGNATURE

NORTH EAST

OFFICIALLY RATED THE NO.1 ESTATE AGENT IN THE NORTH EAST





Haswell Gardens, North Shields NE30 2DR

Haswell Gardens, North Shields NE30 2DR

Asking Price
£189,950

Signature North East welcomes you to this well-presented two-bedroom terraced home, ideally located in the heart of North Shields. Built in 2000, this inviting property is perfectly placed for convenient living, with excellent local amenities. Just a 15-minute stroll from the stunning Long Sands Beach, it's perfectly positioned for those seeking the best of coastal living while enjoying easy access to local amenities, well-regarded schools, and the North Shields Metro station.

This property benefits from no onward chain.

Upon entering, you are welcomed by a hallway that leads into a spacious sitting room, complete with a large, bright window that fills the space with natural light and provides ample room for furnishings. Flowing through to the rear of the property, the kitchen and dining area boasts a range of bright, attractive wall and base units, complemented by sleek countertops. This well-equipped space also features an integrated oven, hob, extractor fan, and a washing/drying machine. Elegant French doors open out to the rear garden, creating a seamless connection between indoor and outdoor living.

Upstairs, the first floor hosts two generously sized bedrooms, with the primary bedroom offering ample space for a double bed and additional furnishings. The stylish shower room features contemporary finishes, including a walk-in shower, wash basin and WC. There is also ample space should you wish to reintroduce a bath, allowing the flexibility to tailor the space to your lifestyle.

Externally, the home benefits from a charming rear garden, laid mainly to lawn with an additional decking area, ideal for outdoor seating or entertaining. Parking is available via a private driveway to the front, with further on-street parking also accessible.



PLEASE NOTE THAT THE VENDOR HAS CERTIFIED THE PROPERTY INFORMATION AND IMAGES.

PROPERTY FLOORPLAN

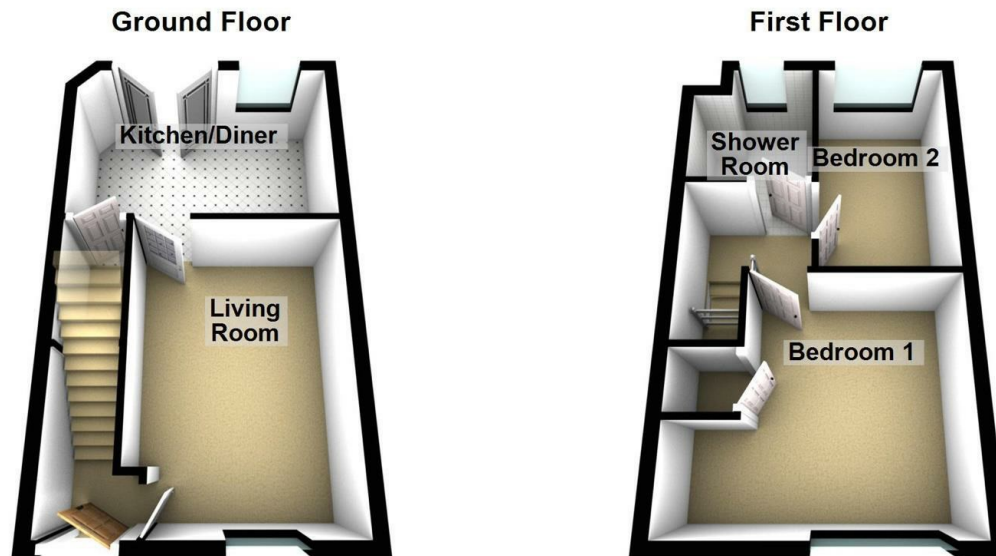

Total area: approx. 54.2 sq. metres (583.5 sq. feet)

Measurements:

Living Room
13'8" x 9'8"

Kitchen/Diner
8'6" x 12'11"

Bedroom One
11'0" x 12'6"

Bedroom Two
11'4" x 6'6"

Shower Room
6'1" x 6'6"

Energy Efficiency Rating

	Current	Potential
Very energy efficient - lower running costs		
(92 plus) A		91
(81-91) B		
(69-80) C	74	
(55-68) D		
(39-54) E		
(21-38) F		
(1-20) G		
Not energy efficient - higher running costs		

England & Wales

EU Directive
2002/91/EC







More 5 Star Customer Reviews than any other Agent based in the North East on allAgents.co.uk



SALES

LETTINGS

FINANCE

LAW

WE COVER THE WHOLE OF THE NORTH EAST

Whitley Bay
0191 251 3344

Cramlington
01670 897 213

Tynemouth
0191 296 6689

Morpeth
01670 513 966

Ponteland
01661 820 082

Wallsend
0191 432 4151

Alnwick
01665 511 800

Heaton
0191 432 4275

Forest Hall
0191 266 9966

Other locations
0191 640 3523

Newcastle
0191 640 2284

Durham
0191 303 8252

Gosforth
0191 640 3523

Sunderland
0191 543 6390

Whickham
0191 432 5102

Gateshead
0191 432 4294

Jesmond
0191 281 1037

Killingworth
0191 640 3602

Ryton
0191 413 9845

Head Office &
Lettings
0191 253 4815

*Highest recommended 5-star reviews than any other Estate Agent based in the North East on allAgents.co.uk - The UK's Largest Customer Review Website for the Property Industry & Awarded Best Estate Agency 2018 & 2019 - North East England by SME News