

# SIGNATURE

## NORTH EAST

OFFICIALLY RATED THE NO.1 ESTATE AGENT IN THE NORTH EAST







 Norham Road, North Shields NE29 7AH



# Norham Road, North Shields NE29 7AH

## £625 Per Calendar Month

Welcome to Signature rental market. Upon entering, you are greeted by a central hallway which leads into a spacious, bright living room, enhanced by a large window that floods the space with natural light. The kitchen boasts a generous array of attractive wall and base units, sleek countertops, and ample room for dining. Moving through the apartment, you'll find two generously sized bedrooms—one comfortably fits a double bed and furnishings, while the second, a spacious single, could easily accommodate a queen bed. Completing the home is a modern bathroom fitted with a bathtub, overhead shower, hand basin, and W.C.

Perfectly positioned in the popular area of North Shields, this property offers generous room sizes and an ideal location. Residents will benefit from a short walk to local shops, schools, bars, and eateries, as well as excellent transport links, with Percy Main Metro station conveniently nearby. An excellent opportunity for comfortable, well-connected living.

Available Now  
Tenancy Term: 12 Months  
£625.00 PCM

### TENANCY APPLICATION FEES:

To apply for a tenancy on this property, a refundable holding deposit of a week's rent is required.

A tenancy damage deposit for the property is compulsory and is to be paid 48 hours before the tenancy commences, along with the first month's rent payment. The tenancy deposit is equivalent to 5 week's rent. An additional tenancy deposit amount may be requested in certain circumstances.



PLEASE NOTE THAT THE VENDOR HAS CERTIFIED THE PROPERTY INFORMATION AND IMAGES.

# PROPERTY FLOORPLAN

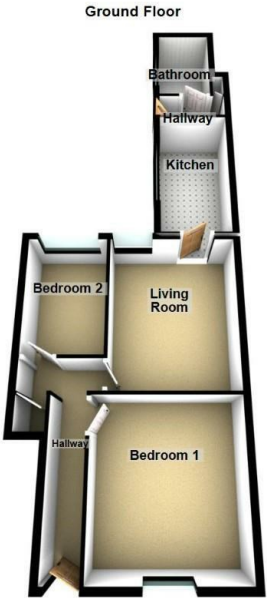

## Measurements:

Hallway  
18'5" x 3'5"

Living Room  
14'3" x 12'1"

Kitchen  
12'7" x 7'0"

Bathroom  
8'0" x 5'7"

Bedroom One  
14'4" x 12'11"

Bedroom Two  
10'10" x 7'8"

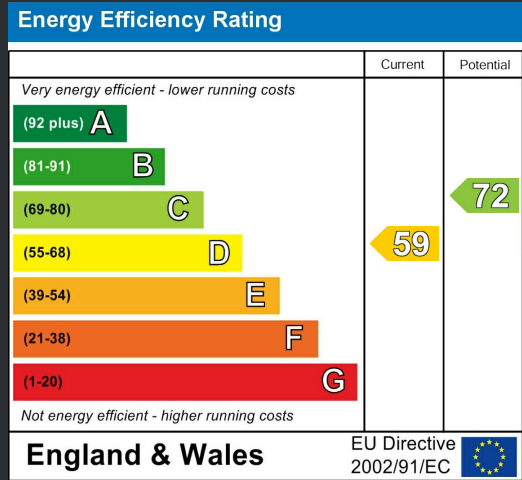









More 5 Star Customer Reviews than any other Agent based in the North East on [allAgents.co.uk](https://allAgents.co.uk)



**SALES**

**LETTINGS**

**FINANCE**

**LAW**

**WE COVER THE WHOLE OF THE NORTH EAST**

Whitley Bay  
0191 251 3344

Cramlington  
01670 897 213

Tynemouth  
0191 296 6689

Morpeth  
01670 513 966

Ponteland  
01661 820 082

Wallsend  
0191 432 4151

Alnwick  
01665 511 800

Heaton  
0191 432 4275

Forest Hall  
0191 266 9966

Other locations  
0191 640 3523

Newcastle  
0191 640 2284

Durham  
0191 303 8252

Gosforth  
0191 640 3523

Sunderland  
0191 543 6390

Whickham  
0191 432 5102

Gateshead  
0191 432 4294

Jesmond  
0191 281 1037

Killingworth  
0191 640 3602

Ryton  
0191 413 9845

Head Office &  
Lettings  
0191 253 4815

\*Highest recommended 5-star reviews than any other Estate Agent based in the North East on [allAgents.co.uk](https://allAgents.co.uk) - The UK's Largest Customer Review Website for the Property Industry & Awarded Best Estate Agency 2018 & 2019 - North East England by SME News