

SIGNATURE

NORTH EAST

OFFICIALLY RATED THE NO.1 ESTATE AGENT IN THE NORTH EAST





📍 Queens Road, Whitley Bay NE26 3AT

Queens Road, Whitley Bay NE26 3AT

Asking Price
£595,000

Signature North East welcomes you to this delightful three-bedroom, semi-detached home located in the desirable area of Monkseaton. Offering a superb combination of traditional charm and modern comforts, this property boasts generous room sizes and many original features, including multiple fireplaces and high ceilings. The location is truly enviable, with the beautiful coastline just a short distance away, as well as Monkseaton Metro providing quick access to Newcastle city centre. The property is also within walking distance to local schools, shops, eateries, as well as iconic coastal features such as the Spanish City and Whitley Bay seafront.

The home enters through a grand central hallway, featuring traditional wood panelling, which sets the tone for the rest of the property. The spacious living room offers ample space for your furniture and is flooded with natural light from a large bay window. The dining area comfortably accommodates a dining table and is enhanced by a log burner, perfect for cosy family gatherings. The kitchen is well-appointed with attractive wooden wall and base units, complemented by sleek countertops. Additionally, a cosy sitting room provides the perfect space to unwind and relax, with elegant French doors leading directly into the rear garden.

Upstairs, the property offers three generously sized bedrooms, each providing plenty of space for a double bed and additional furnishings. Completing the first floor is a stylish bathroom, featuring a bathtub, shower, hand basin, and W.C., offering a practical and relaxing space for everyday use.

Externally, the property benefits from a generous, west-facing garden with a well-maintained lawn and ample patio area, perfect for outdoor entertaining or simply enjoying the sunshine. There is also an impressive woodworking barn, perfect for crafting or a variety of other uses. To the front of the property, off-street parking is available via a garage and driveway, with additional on-street parking.



PLEASE NOTE THAT THE VENDOR HAS CERTIFIED THE PROPERTY INFORMATION AND IMAGES.

PROPERTY FLOORPLAN

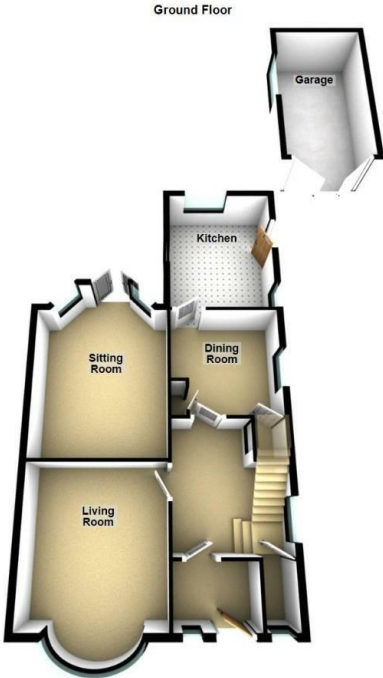

Measurements:

Living Room
13'1" x 12'2"

Sitting Room
13'9" x 12'2"

Dining Room
10'0" x 10'0"

Kitchen
12'3" x 10'0"

Bedroom One
13'1" x 12'3"

Bedroom Two
13'9" x 12'2"

Bedroom Three
10'5" x 9'8"

Bathroom
10'5" x 10'0"

Garage
17'0" x 9'6"

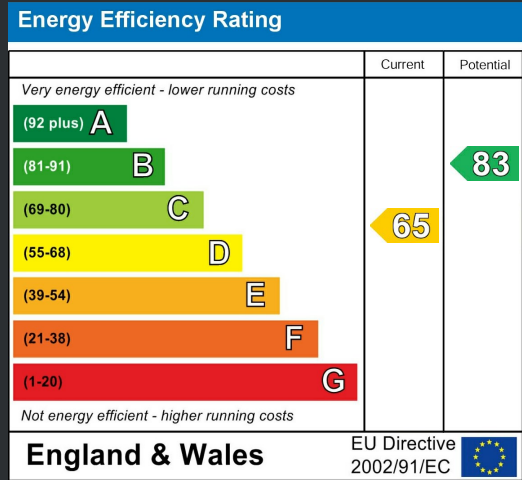





More 5 Star Customer Reviews than any other Agent based in the North East on [allAgents.co.uk](https://allagents.co.uk)



SALES

LETTINGS

FINANCE

LAW

WE COVER THE WHOLE OF THE NORTH EAST

Whitley Bay
0191 251 3344

Cramlington
01670 897 213

Tynemouth
0191 296 6689

Morpeth
01670 513 966

Ponteland
01661 820 082

Wallsend
0191 432 4151

Alnwick
01665 511 800

Heaton
0191 432 4275

Forest Hall
0191 266 9966

Other locations
0191 640 3523

Newcastle
0191 640 2284

Durham
0191 303 8252

Gosforth
0191 640 3523

Sunderland
0191 543 6390

Whickham
0191 432 5102

Gateshead
0191 432 4294

Jesmond
0191 281 1037

Killingworth
0191 640 3602

Ryton
0191 413 9845

Head Office &
Lettings
0191 253 4815

*Highest recommended 5-star reviews than any other Estate Agent based in the North East on [allAgents.co.uk](https://allagents.co.uk) - The UK's Largest Customer Review Website for the Property Industry & Awarded Best Estate Agency 2018 & 2019 - North East England by SME News