

SIGNATURE

NORTH EAST

OFFICIALLY RATED THE NO.1 ESTATE AGENT IN THE NORTH EAST





 Chester Grove, Seghill NE23 7TR

Chester Grove, Seghill NE23 7TR

£210,000

Signature North East welcomes you to Chester Grove, Seghill, a charming bungalow located in a peaceful neighbourhood. Surrounded by green spaces, residents can enjoy plenty of opportunities for outdoor activities, exercise, and relaxation, making it a tranquil and desirable place to call home. The neighbourhood's quiet and safe environment further enhances its appeal. One of the main advantages of this location is its convenient access to a wide range of amenities. Public transport options, including nearby bus stops, offer excellent connectivity to surrounding towns and cities, making commuting easy and stress-free.

As you step inside the ample porch, the living room greets you, featuring a large window that fills the space with natural light. The open-concept design creates a seamless flow into the adjacent dining room, making it perfect for both relaxing and entertaining. The kitchen, accessed through the dining room, offers plenty of wall and base units for all your storage needs, as well as generous counter space. There is also convenient outdoor access to the back garden directly from the kitchen.

At the rear of the property, you will find two well-appointed double bedrooms, ensuring a peaceful and quiet atmosphere for rest. Both bedrooms come complete with fitted wardrobes, providing additional storage. The family bathroom, fitted with a three-piece suite, is conveniently located for use by both family members and guests.

Outside, the back garden features both a patio area and a grassy space, perfect for enjoying outdoor activities or simply relaxing in the sun. The single garage offers additional storage or parking for one car, and the driveway can accommodate another vehicle, providing ample parking for up to two cars, making it convenient for residents and visitors alike.

Whether you're looking to start a new chapter or simply seeking a peaceful retreat, Chester Grove is the perfect place. Call Signature North East today and book your viewing.

Whether you're looking to start a new chapter or simply seeking a peaceful retreat, Chester Grove is the perfect place to make cherished memories. Call Signature North East today and book your viewing.



PLEASE NOTE THAT THE VENDOR HAS CERTIFIED THE PROPERTY INFORMATION AND IMAGES.

PROPERTY FLOORPLAN

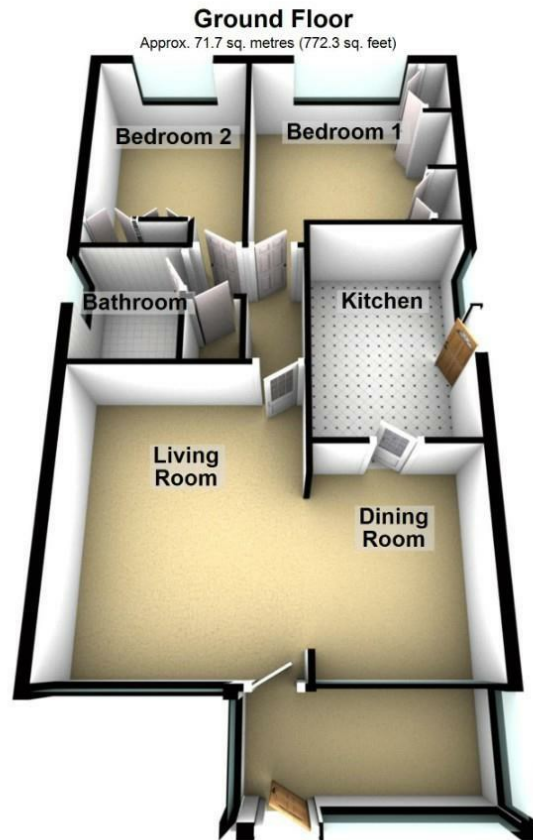

Total area: approx. 71.7 sq. metres (772.3 sq. feet)

Please be advised the floorplans are not drawn to scale and are to be used to give an idea of the layout of the property.
Plan produced using PlanUp.

Measurements:

Living Room
15'0" x 11'11"

Dining Room
10'10" x 8'2"

Kitchen
12'1" x 8'2"

Bedroom One
12'6" x 11'6"

Bedroom Two
12'6" x 8'7"

Bathroom
9'9" x 5'5"

Energy Efficiency Rating

	Current	Potential
<i>Very energy efficient - lower running costs</i>		
(92 plus) A		87
(81-91) B		
(69-80) C	69	
(55-68) D		
(39-54) E		
(21-38) F		
(1-20) G		
<i>Not energy efficient - higher running costs</i>		

England & Wales

EU Directive
2002/91/EC







More 5 Star Customer Reviews than any other Agent based in the North East on allAgents.co.uk



SALES

LETTINGS

FINANCE

LAW

WE COVER THE WHOLE OF THE NORTH EAST

Whitley Bay
0191 251 3344

Cramlington
01670 897 213

Tynemouth
0191 296 6689

Morpeth
01670 513 966

Ponteland
01661 820 082

Wallsend
0191 432 4151

Alnwick
01665 511 800

Heaton
0191 432 4275

Forest Hall
0191 266 9966

Other locations
0191 640 3523

Newcastle
0191 640 2284

Durham
0191 303 8252

Gosforth
0191 640 3523

Sunderland
0191 543 6390

Whickham
0191 432 5102

Gateshead
0191 432 4294

Jesmond
0191 281 1037

Killingworth
0191 640 3602

Ryton
0191 413 9845

Head Office &
Lettings
0191 253 4815

*Highest recommended 5-star reviews than any other Estate Agent based in the North East on allAgents.co.uk - The UK's Largest Customer Review Website for the Property Industry & Awarded Best Estate Agency 2018 & 2019 - North East England by SME News