

SIGNATURE

NORTH EAST

OFFICIALLY RATED THE NO.1 ESTATE AGENT IN THE NORTH EAST





 Ultor Court, Blyth NE24 3UE

Ultor Court, Blyth NE24 3UE

Offers Over £119,950

Signature North East proudly introduces this modern flat located in Ultor Court, Blyth. Ideal for both first-time buyers and investors alike, this property boasts an excellent location with convenient proximity to local attractions including the beach, Ridley Park, Bede Academy School, and a variety of shops and restaurants.

Upon entering the flat, you're greeted by a hallway that provides access to the principal rooms of the home. The highlight is the open-plan living room, kitchen, and dining area that spans the entire length of the property. This spacious layout offers abundant room for your preferred furnishings, creating a bright and airy atmosphere. The modern grey wall and base units in the kitchen offer ample storage space, ensuring both functionality and style.

The flat comprises two well-proportioned bedrooms, with the master bedroom boasting access to a convenient walk-in wardrobe. Completing the home is a well-appointed three-piece bathroom, equipped with a bath, overhead shower, w.c., and sink.

Externally, the property offers access to a private car park featuring allocated bays for residents, enhancing convenience. Visitor parking is also available, making hosting friends and family hassle-free.



PLEASE NOTE THAT THE VENDOR HAS CERTIFIED THE PROPERTY INFORMATION AND IMAGES.

PROPERTY FLOORPLAN

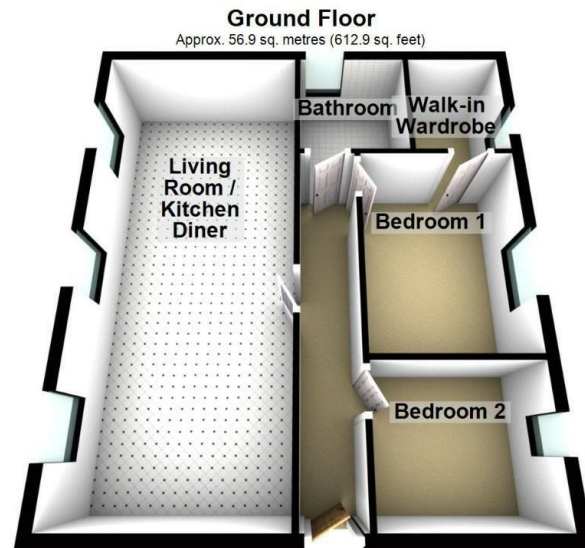

Total area: approx. 56.9 sq. metres (612.9 sq. feet)

Please be advised the floorplans are not drawn to scale and are to be used to give an idea of the layout of the property.
Plan produced using PlanUp.

Measurements:

Living room/kitchen/diner
25'4" x 11'3"

Bedroom 1
11'6" x 8'7"

Bedroom 2
7'7" x 8'7"

Bathroom
6'5" x 6'3"

Energy Efficiency Rating

	Current	Potential
<i>Very energy efficient - lower running costs</i>		
(92 plus) A		
(81-91) B	79	80
(69-80) C		
(55-68) D		
(39-54) E		
(21-38) F		
(1-20) G		
<i>Not energy efficient - higher running costs</i>		

England & Wales

EU Directive
2002/91/EC







More 5 Star Customer Reviews than any other Agent based in the North East on allAgents.co.uk



SALES

LETTINGS

FINANCE

LAW

WE COVER THE WHOLE OF THE NORTH EAST

Whitley Bay
0191 251 3344

Cramlington
01670 897 213

Tynemouth
0191 296 6689

Morpeth
01670 513 966

Ponteland
01661 820 082

Wallsend
0191 432 4151

Alnwick
01665 511 800

Heaton
0191 432 4275

Forest Hall
0191 266 9966

Other locations
0191 640 3523

Newcastle
0191 640 2284

Durham
0191 303 8252

Gosforth
0191 640 3523

Sunderland
0191 543 6390

Whickham
0191 432 5102

Gateshead
0191 432 4294

Jesmond
0191 281 1037

Killingworth
0191 640 3602

Ryton
0191 413 9845

Head Office &
Lettings
0191 253 4815

*Highest recommended 5-star reviews than any other Estate Agent based in the North East on allAgents.co.uk - The UK's Largest Customer Review Website for the Property Industry & Awarded Best Estate Agency 2018 & 2019 - North East England by SME News