

SIGNATURE

NORTH EAST

OFFICIALLY RATED THE NO.1 ESTATE AGENT IN THE NORTH EAST





 Barley Way, New Hartley NE25 0GN

Barley Way, New Hartley NE25 0GN

50% Shared Ownership £125,000

Signature North East proudly presents this charming 50% shared ownership, 3-bedroom end-terraced property located in the sought-after area of New Hartley. Set in a fantastic location, it is just a short drive from the scenic coastline at Seaton Sluice and close to both Seaton Sluice and Seaton Delaval for local amenities. This property is perfect for families, with New Hartley First School within walking distance and the newly built Seaton Valley school nearby. Commuters will also benefit from excellent transport links, with direct buses to Blyth and Newcastle City Centre.

Upon entering the property, you are greeted by a welcoming central hallway that also provides access to a convenient ground floor W.C. The journey continues into the spacious living room, which is bright and airy, benefiting from a large window and ample space for furnishings. The open-plan kitchen and dining area is equally impressive, offering a variety of attractive wall and base units, complemented by sleek countertops. French doors lead out to the rear garden, creating a seamless indoor-outdoor living space.

Moving up to the first floor, you will find three well-proportioned bedrooms. Bedrooms 1 and 2 comfortably accommodate double beds and additional furnishings, while Bedroom 3 is currently used as a dressing room but would also make an ideal children's room. The master bedroom boasts a stylish ensuite, complete with a walk-in shower, W.C., and hand basin. A family bathroom featuring a bathtub, hand basin, and W.C. completes this floor.

Externally, the property features a sizable rear garden, mainly laid to lawn, offering an ideal space for outdoor relaxation. Additionally, the home benefits from off-street parking with a double driveway located at the rear, providing ample space for two vehicles.



PLEASE NOTE THAT THE VENDOR HAS CERTIFIED THE PROPERTY INFORMATION AND IMAGES.

PROPERTY FLOORPLAN

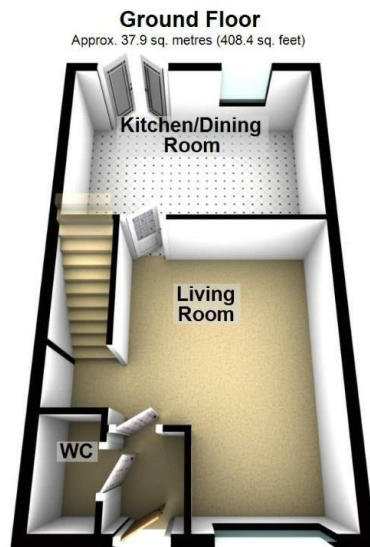

Total area: approx. 76.0 sq. metres (817.9 sq. feet)

Please be advised the floorplans are not drawn to scale and are to be used to give an idea of the layout of the property.
Plan produced using PlanUp.

Measurements:

Living Room
16'1" x 15'1"

Kitchen / Dining Room
15'1" x 10'5"

WC
5'3" x 3'0"

Bedroom One
13'9" x 8'6"

En Suite
8'6" x 4'6"

Bedroom Two
10'2" x 8'6"

Bedroom Three
8'9" x 6'3"

Bathroom
6'3" x 5'6"

Energy Efficiency Rating

	Current	Potential
Very energy efficient - lower running costs		
(92 plus) A		96
(81-91) B	84	
(69-80) C		
(55-68) D		
(39-54) E		
(21-38) F		
(1-20) G		
Not energy efficient - higher running costs		
England & Wales	EU Directive 2002/91/EC	





More 5 Star Customer Reviews than any other Agent based in the North East on allAgents.co.uk



SALES

LETTINGS

FINANCE

LAW

WE COVER THE WHOLE OF THE NORTH EAST

Whitley Bay
0191 251 3344

Cramlington
01670 897 213

Tynemouth
0191 296 6689

Morpeth
01670 513 966

Ponteland
01661 820 082

Wallsend
0191 432 4151

Alnwick
01665 511 800

Heaton
0191 432 4275

Forest Hall
0191 266 9966

Other locations
0191 640 3523

Newcastle
0191 640 2284

Durham
0191 303 8252

Gosforth
0191 640 3523

Sunderland
0191 543 6390

Whickham
0191 432 5102

Gateshead
0191 432 4294

Jesmond
0191 281 1037

Killingworth
0191 640 3602

Ryton
0191 413 9845

Head Office &
Lettings
0191 253 4815

*Highest recommended 5-star reviews than any other Estate Agent based in the North East on allAgents.co.uk - The UK's Largest Customer Review Website for the Property Industry & Awarded Best Estate Agency 2018 & 2019 - North East England by SME News