

SIGNATURE

NORTH EAST

OFFICIALLY RATED THE NO.1 ESTATE AGENT IN THE NORTH EAST





📍 Shaftoe Court, Lakeshore NE12 6YP

Shaftoe Court, Lakeshore NE12 6YP

Offers Over £60,000

Signature North East welcomes you to Shaftoe Court, Lakeshore – a charming location for this delightful 1-bedroom flat. Situated in the heart of Lakeshore, this property offers a perfect blend of comfort and convenience. Shaftoe Court is a sought-after location, known for its tranquillity and proximity to local amenities. Residents can enjoy leisurely walks by the lakeshore or explore the nearby shops and cafes. The sense of community in this area is truly special, making it a wonderful place to call home. The area features a well-connected road network, including the A19, a major dual carriageway for quick access to Newcastle and beyond. The A1056 links to nearby towns, while local roads provide easy access to amenities. Public transport options, including bus services, further enhance connectivity.

This lovely flat is ideal for those seeking a cosy and manageable living space. The bedroom provides a peaceful retreat, while the living area is perfect for relaxing or entertaining guests. The property's layout is well-designed, and functional. As you step inside, the hallway offers an ample cupboard for storage convenience. The double bedroom is spacious and bright, accommodating your desired furniture. Opposite the bedroom, the 3-piece bathroom, complete with a bathtub and shower, is perfectly located for easy access and guest use. The kitchen offers a plethora of wall and base units for storage and plenty of space for meal prep. Adjacent to the kitchen, the living room features a fireplace, creating a warm and inviting atmosphere.

Whether you are a first-time buyer, downsizing, or looking for a lucrative investment opportunity, this flat offers great potential. Don't miss the chance to own a piece of Lakeshore living at Shaftoe Court.

Call Signature North East today and schedule a viewing today and experience the charm of this property for yourself.



PLEASE NOTE THAT THE VENDOR HAS CERTIFIED THE PROPERTY INFORMATION AND IMAGES.

PROPERTY FLOORPLAN

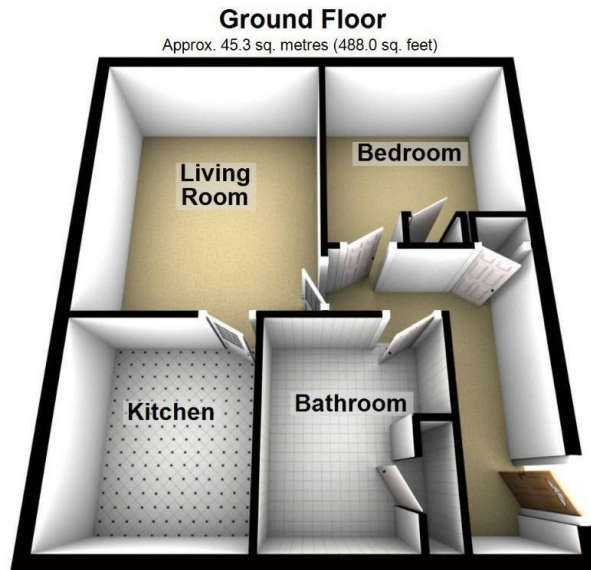

Total area: approx. 45.3 sq. metres (488.0 sq. feet)

Please be advised the floorplans are not drawn to scale and are to be used to give an idea of the layout of the property.
Plan produced using PlanUp.

Measurements:

LIVING ROOM
13'8" x 11'1"

KITCHEN
9'5" x 8'3"

BEDROOM
10'4" x 9'5"

BATHROOM
8'2" x 7'10"

Energy Efficiency Rating

	Current	Potential
<i>Very energy efficient - lower running costs</i>		
(92 plus) A		
(81-91) B		83
(69-80) C	71	
(55-68) D		
(39-54) E		
(21-38) F		
(1-20) G		
<i>Not energy efficient - higher running costs</i>		
England & Wales	EU Directive 2002/91/EC 	





More 5 Star Customer Reviews than any other Agent based in the North East on allAgents.co.uk



SALES

LETTINGS

FINANCE

LAW

WE COVER THE WHOLE OF THE NORTH EAST

Whitley Bay
0191 251 3344

Cramlington
01670 897 213

Tynemouth
0191 296 6689

Morpeth
01670 513 966

Ponteland
01661 820 082

Wallsend
0191 432 4151

Alnwick
01665 511 800

Heaton
0191 432 4275

Forest Hall
0191 266 9966

Other locations
0191 640 3523

Newcastle
0191 640 2284

Durham
0191 303 8252

Gosforth
0191 640 3523

Sunderland
0191 543 6390

Whickham
0191 432 5102

Gateshead
0191 432 4294

Jesmond
0191 281 1037

Killingworth
0191 640 3602

Ryton
0191 413 9845

Head Office &
Lettings
0191 253 4815

*Highest recommended 5-star reviews than any other Estate Agent based in the North East on allAgents.co.uk - The UK's Largest Customer Review Website for the Property Industry & Awarded Best Estate Agency 2018 & 2019 - North East England by SME News