

SIGNATURE

NORTH EAST

OFFICIALLY RATED THE NO.1 ESTATE AGENT IN THE NORTH EAST





 , Morpeth NE65 7YA

Guide Price £900,000

Morpeth NE65 7YA

Signature North East proudly presents this stunning detached house, nestled in the charming village of Rothbury, Morpeth—a true gem waiting to be discovered. This impressive property boasts 5 reception rooms, providing ample space for entertaining guests or relaxing with loved ones. Rothbury, a peaceful and picturesque market town at the heart of Northumberland's countryside, is known for its natural beauty, historic attractions like Craggside House, and opportunities for scenic walks and outdoor exploration. You'll have easy access to local amenities and schools.

From the moment you step inside, you are greeted by a sense of grandeur and elegance that is sure to impress even the most discerning buyer. The property's classic architecture is complemented by modern amenities, creating a perfect blend of old-world charm and contemporary convenience.

The property spans three floors. On the ground floor, you will find a sitting room, a living room, a dining room, and an office. The kitchen, with its plethora of wall and base units, includes an informal dining area perfect for daily meals. The island is the centrepiece, adding extra counter space for meal prep and additional storage. Outdoor access is easy with sliding doors in the dining area and an external door in the kitchen. A utility room and a WC complete the ground floor.

The first floor features six well-appointed double bedrooms, all with en-suite bathrooms, along with a lounge area. The second floor offers an additional six well-appointed bedrooms—three with en-suite bathrooms and three sharing a family bathroom. The views from every window are breath-taking.

Outside, this property offers a wealth of greenery spanning on a 1.3 acres. The grounds include planning permission to build a 4-bedroom house and a double garage. This traditional Edwardian house also provides a parking area for up to 10 cars.

This is a rare opportunity to own a piece of Northumberland's heritage, perfectly combining timeless elegance with modern living in a tranquil and picturesque setting. Currently operating as a guest house, this property provides an exceptional chance to either continue the business or transform it into a stunning home.

Give Signature North East a call today and book your viewing



PLEASE NOTE THAT THE VENDOR HAS CERTIFIED THE PROPERTY INFORMATION AND IMAGES.

PROPERTY FLOORPLAN

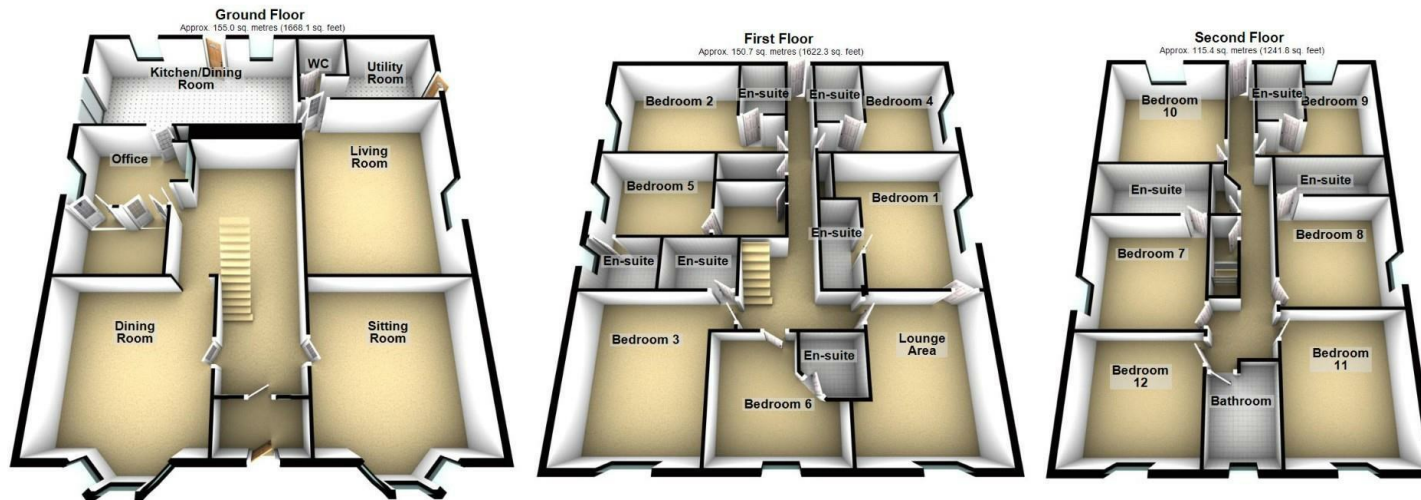

Total area: approx. 421.1 sq. metres (4532.3 sq. feet)

Please be advised the floorplans are not drawn to scale and are to be used to give an idea of the layout of the property.
Plan produced using PlanUp.

Measurements:

Living Room
19'7" x 14'11"

Sitting Room
14'11" x 14'11"

Dining Room
14'11" x 14'10"

Kitchen / Dining Room
22'11" x 11'6"

Office
11'6" x 9'2"

Utility Room
14'11" x 8'2"

Bedroom One
15'1" x 15'02'7"

Lounge Area
14'11" x 12'11"

En Suite
9'2" x 3'10"

Bedroom Two
22'10" x 11'9"

En Suite
6'9" x 5'0"

Bedroom Three
14'11" x 14'10"

En Suite
7'3" x 5'2"

Bedroom Four
15'1" x 11'9"

Energy Efficiency Rating

| | Current | Potential |
|---|-----------|-----------|
| Very energy efficient - lower running costs | | |
| (92 plus) A | | |
| (81-91) B | | 85 |
| (69-80) C | | |
| (55-68) D | 52 | |
| (39-54) E | | |
| (21-38) F | | |
| (1-20) G | | |
| Not energy efficient - higher running costs | | |

England & Wales

EU Directive
2002/91/EC







More 5 Star Customer Reviews than any other Agent based in the North East on allAgents.co.uk



SALES

LETTINGS

FINANCE

LAW

WE COVER THE WHOLE OF THE NORTH EAST

Whitley Bay
0191 251 3344

Cramlington
01670 897 213

Tynemouth
0191 296 6689

Morpeth
01670 513 966

Ponteland
01661 820 082

Wallsend
0191 432 4151

Alnwick
01665 511 800

Heaton
0191 432 4275

Forest Hall
0191 266 9966

Other locations
0191 640 3523

Newcastle
0191 640 2284

Durham
0191 303 8252

Gosforth
0191 640 3523

Sunderland
0191 543 6390

Whickham
0191 432 5102

Gateshead
0191 432 4294

Jesmond
0191 281 1037

Killingworth
0191 640 3602

Ryton
0191 413 9845

Head Office &
Lettings
0191 253 4815

*Highest recommended 5-star reviews than any other Estate Agent based in the North East on allAgents.co.uk - The UK's Largest Customer Review Website for the Property Industry & Awarded Best Estate Agency 2018 & 2019 - North East England by SME News