

# SIGNATURE

## NORTH EAST

OFFICIALLY RATED THE NO.1 ESTATE AGENT IN THE NORTH EAST





 Countess Way, Newcastle Upon Tyne NE27 0FN



# Countess Way, Newcastle Upon Tyne NE27 0FN

£229,000

Signature North East is pleased to introduce this immaculately presented three-bedroom terraced house to the sales market, located in the sought-after residential area of Shiremoor on Countess Way. This charming home showcases attractive decor and generously proportioned rooms, ensuring a comfortable living experience. The surrounding area provides a range of convenient amenities, including shops, eateries, excellent road and transport connections, and reputable schools, making it an ideal choice for potential families seeking their perfect home.

As you step into the home, you are greeted by a welcoming entrance hallway that grants access to the main rooms on the ground floor, as well as a convenient downstairs w.c. Upon entering the living room, you will find an abundance of space to accommodate your desired furnishings. Additionally, the living room features an open staircase that leads to the first floor. Continuing on, we have the kitchen/diner, a spacious area filled with natural light streaming through the patio doors and windows. This well-proportioned kitchen boasts sleek wall and base units, providing ample storage space for all your culinary needs. It is equipped with a range of integrated appliances, including a fridge, freezer, oven, and hob.

As you ascend to the first floor of the home, you will discover three bedrooms, two of which are spacious enough to accommodate a comfortable double bed and additional desired furnishings. The main bedroom stands out as a true highlight, offering the added luxury of an ensuite bathroom. This ensuite is equipped with a walk-in shower, a w.c., and a sink. The third bedroom offers space for a single bed but also has versatility to be used as a home office, study, or dressing room if desired.

At the rear of the property, you'll find a generously sized garden that offers a delightful combination of a lush lawn and two inviting patio areas. Furthermore, this home includes the added advantage of a detached garage.



# PROPERTY FLOORPLAN

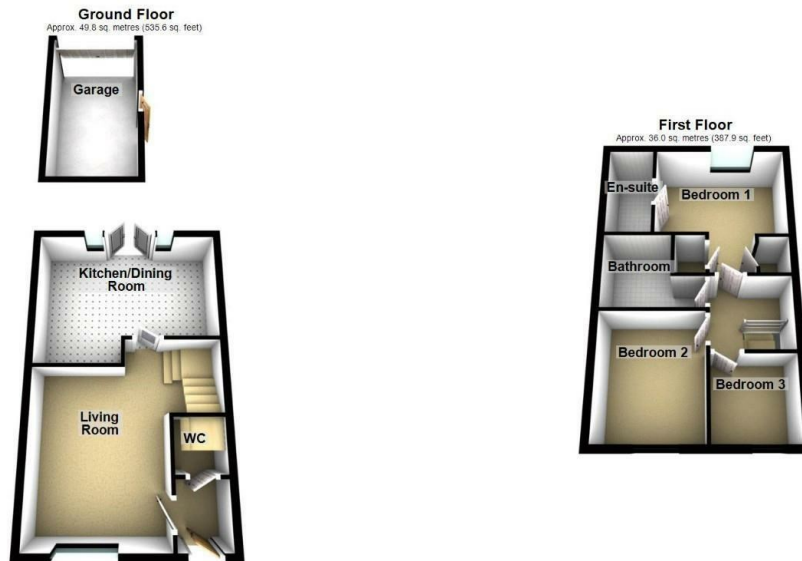

Total area: approx. 85.8 sq. metres (923.5 sq. feet)  
Please be advised the floorplans are not drawn to scale and are to be used to give an idea of the layout of the property.  
Plan produced using PlanUp.

## Measurements:

Living Room  
11'0" x 13'4"

Kitchen / Dining Room  
15'4" x 11'4"

Bedroom One  
11'3" x 11'8"

En-suite  
3'10" x 3'10"

Bedroom Two  
8'5" x 10'0"

Bedroom Three  
6'7" x 6'7"

Bathroom  
7'4" x 6'4"

## Energy Efficiency Rating

	Current	Potential
Very energy efficient - lower running costs		
(92 plus) <b>A</b>		<b>96</b>
(81-91) <b>B</b>	<b>82</b>	
(69-80) <b>C</b>		
(55-68) <b>D</b>		
(39-54) <b>E</b>		
(21-38) <b>F</b>		
(1-20) <b>G</b>		
Not energy efficient - higher running costs		
<b>England &amp; Wales</b>	EU Directive 2002/91/EC	









More 5 Star Customer Reviews than any other Agent based in the North East on allAgents.co.uk



**SALES**

**LETTINGS**

**FINANCE**

**LAW**

**WE COVER THE WHOLE OF THE NORTH EAST**

Whitley Bay  
0191 251 3344

Cramlington  
01670 897 213

Tynemouth  
0191 296 6689

Morpeth  
01670 513 966

Ponteland  
01661 820 082

Wallsend  
0191 432 4151

Alnwick  
01665 511 800

Heaton  
0191 432 4275

Forest Hall  
0191 266 9966

Other locations  
0191 640 3523

Newcastle  
0191 640 2284

Durham  
0191 303 8252

Gosforth  
0191 640 3523

Sunderland  
0191 543 6390

Whickham  
0191 432 5102

Gateshead  
0191 432 4294

Jesmond  
0191 281 1037

Killingworth  
0191 640 3602

Ryton  
0191 413 9845

Head Office &  
Lettings  
0191 253 4815

\*Highest recommended 5-star reviews than any other Estate Agent based in the North East on allAgents.co.uk - The UK's Largest Customer Review Website for the Property Industry & Awarded Best Estate Agency 2018 & 2019 - North East England by SME News