

SIGNATURE

NORTH EAST

OFFICIALLY RATED THE NO.1 ESTATE AGENT IN THE NORTH EAST





 Front Street, Newbiggin-By-The-Sea NE64 6AD

Front Street, Newbiggin-By-The-Sea NE64 6AD

Offers Over £335,000

Signature North East is delighted to present this exceptional property on Front Street in the charming village of Newbiggin-By-The-Sea. Positioned in the heart of the village. The property not only provides a comfortable home but also presents a unique opportunity for entrepreneurial endeavours. With its prime location, the ground-floor shop area is ideal for a business venture. The property spans from the 1st floor to the 2nd floor above the commercial area and can be accessed directly through the shop, with the possibility of creating a private entrance by reinstating the original corridor that separated the residential and commercial entrances.

The layout and design reveal a perfect blend of comfort and modern living. The generous living room, with views of Front Street, features a stylish fireplace, creating an ideal area for family gatherings. The open-plan kitchen and dining room serve as the hub of the property, combining wood accents and a cosy fireplace to make a comfortable and inviting setting for hosting family events. The practical kitchen is equipped with a range cooker and dishwasher. French doors open to a small balcony/veranda, allowing the sea breeze.

The ample hallway provides access to a utility room. The outdoor balcony, accessible via the utility room, has enough space for outdoor furniture, perfect for enjoying outdoor living and admiring the iconic Couple statue. This floor also features a convenient WC for family and guests.

On the top floor, you will find three well-appointed double bedrooms, each providing a perfect retreat for relaxation after a long day. The three-piece family bathroom, completed with a bathtub and shower, serves all three bedrooms.

This property offers an incredible opportunity for both living and investing in your own business, with the potential for a live-and-rent scenario. For more information or to schedule a viewing, please contact Signature North East.



PROPERTY FLOORPLAN

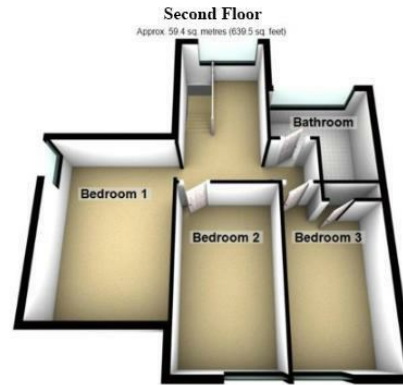
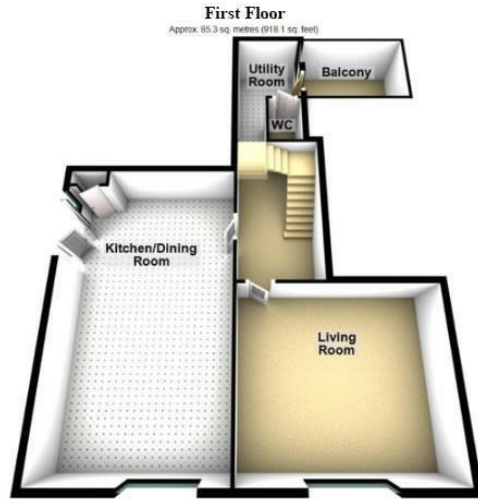

Total area: approx. 144.7 sq. metres (1557.6 sq. feet)

Please be advised the floorplans are not drawn to scale and are to be used to give an idea of the layout of the property. Plan produced using PlanUp.

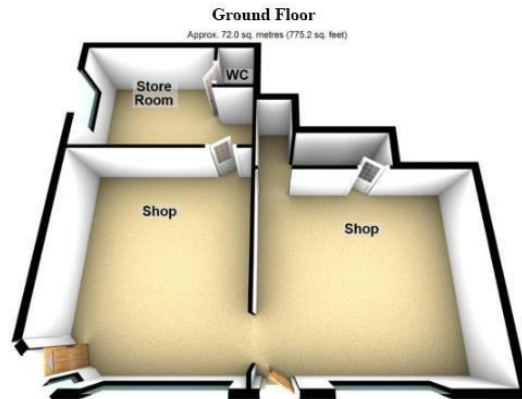

Total area: approx. 72.0 sq. metres (775.2 sq. feet)

Please be advised the floorplans are not drawn to scale and are to be used to give an idea of the layout of the property. Plan produced using PlanUp.

Measurements:

Living Room
17'10" x 15'10"

Kitchen / Dining Room
27'1" x 15'7"

Utility Room
12'9" x 6'6"

WC
5'0" x 3'4"

Bedroom One
15'6" x 11'0"

Bedroom Two
15'1" x 8'7"

Bedroom Three
15'1" x 8'2"

Bathroom
9'0" x 8'11"

Shop
15'5" x 14'10"

Shop
17'7" x 16'0"

Store Room
15'5" x 10'4"

WC
4'1" x 3'4"

Energy Efficiency Rating

	Current	Potential
Very energy efficient - lower running costs		
(92 plus) A		
(81-91) B		
(69-80) C		
(55-68) D	59	68
(39-54) E		
(21-38) F		
(1-20) G		
Not energy efficient - higher running costs		

England & Wales

EU Directive
2002/91/EC







More 5 Star Customer Reviews than any other Agent based in the North East on allAgents.co.uk



SALES

LETTINGS

FINANCE

LAW

WE COVER THE WHOLE OF THE NORTH EAST

Whitley Bay
0191 251 3344

Cramlington
01670 897 213

Tynemouth
0191 296 6689

Morpeth
01670 513 966

Ponteland
01661 820 082

Wallsend
0191 432 4151

Alnwick
01665 511 800

Heaton
0191 432 4275

Forest Hall
0191 266 9966

Other locations
0191 640 3523

Newcastle
0191 640 2284

Durham
0191 303 8252

Gosforth
0191 640 3523

Sunderland
0191 543 6390

Whickham
0191 432 5102

Gateshead
0191 432 4294

Jesmond
0191 281 1037

Killingworth
0191 640 3602

Ryton
0191 413 9845

Head Office &
Lettings
0191 253 4815

*Highest recommended 5-star reviews than any other Estate Agent based in the North East on allAgents.co.uk - The UK's Largest Customer Review Website for the Property Industry & Awarded Best Estate Agency 2018 & 2019 - North East England by SME News