

SIGNATURE

NORTH EAST

OFFICIALLY RATED THE NO.1 ESTATE AGENT IN THE NORTH EAST





 Crest Way, Commissioners Quay, Blyth NE24 3BW

Crest Way, Commissioners Quay, **£1,300 Per Calendar Month** Blyth NE24 3BW

This unique luxury sea-view property is a haven of tranquillity, boasting superior accommodation in a pristine new build setting. Step inside and be greeted by a contemporary ambiance of elegance and comfort, with modern décor and styling throughout.

The true focal point of this property lies on the top floor – a glass balcony offering picturesque and unparalleled sea views. Whether you are sipping your morning coffee or enjoying a glass of wine in the evening, this balcony provides the perfect backdrop for moments of serenity and awe.

On the top floor, the expansive living room offers a serene sanctuary for unwinding, enveloping you in comfort after a day's toil. With its generous proportions, there's ample room for everyone to relax and recharge. Upstairs, plush carpeting adds warmth and comfort. Downstairs, the open-plan kitchen and dining area beckon, showcasing new LVT fitted flooring, providing an inviting space for entertaining guests or enjoying family meals together. Each of the three bedrooms boasts abundant space, easily accommodating double beds and a plethora of furnishings. As for the bathrooms, the property features three in total: a convenient W.C, an indulgent en-suite, and a luxurious full-size bathroom complete with a bath and shower combination, hand basin, and toilet.

Convenience is key, with Blyth town centre and Ridley Park just a stone's throw away, providing endless opportunities for leisure and recreational activities. And with two designated parking spaces, you'll never have to worry about finding a spot.

This property stands out as the only one available for letting with a coveted sea view within the development; all other sea-view properties are owner occupied.

Contact us today to arrange a viewing.

Unfurnished
Tenancy Term: 12 months or longer
Council Tax Band: C
£1,400 PCM

TENANCY APPLICATION FEES

To apply for a tenancy on this property, a refundable holding deposit of a week's rent is required.

A tenancy deposit for the property is compulsory and is to be paid on or before the tenancy commences, along with the first months rent payment. The tenancy deposit is equivalent to one months rent. An additional tenancy deposit amount may be requested in certain circumstances.

PLEASE NOTE THAT THE VENDOR HAS CERTIFIED THE PROPERTY INFORMATION AND IMAGES.



PROPERTY FLOORPLAN

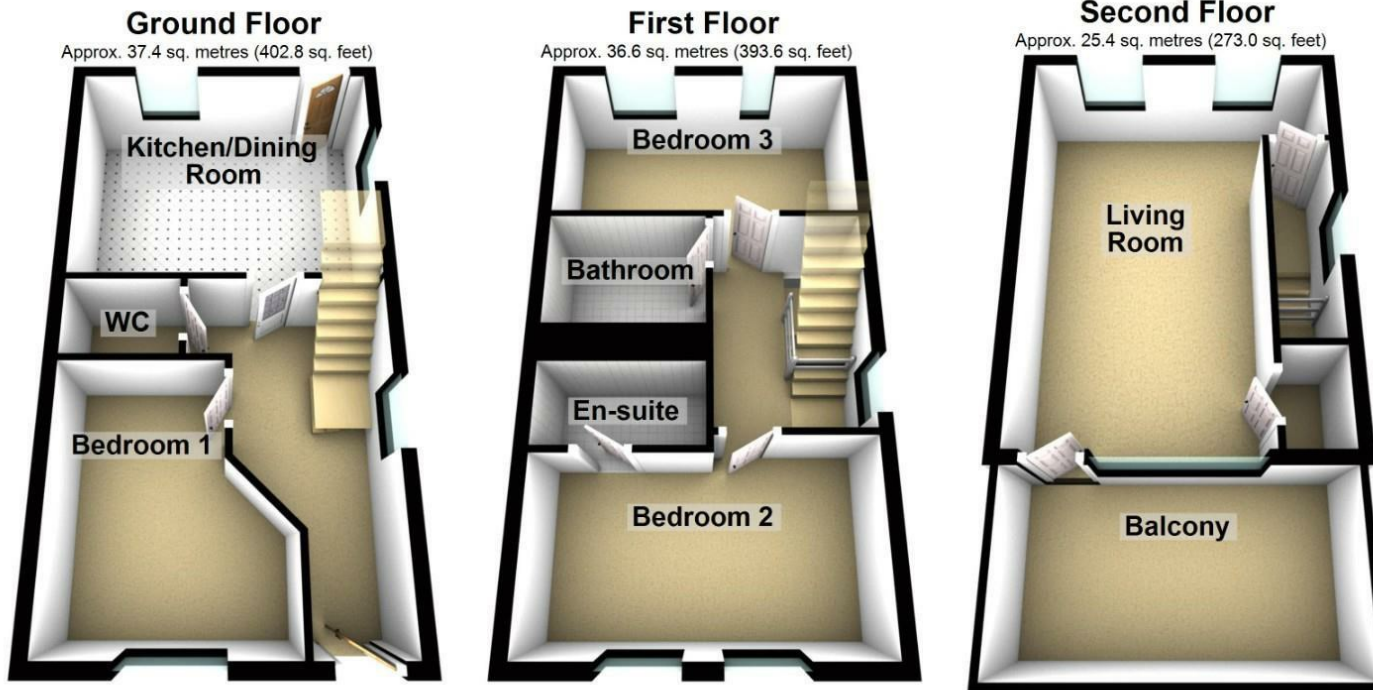

Measurements:

Living Room
11'10" x 10'3"

Kitchen / Dining Room
14'6" x 11'5"

WC
5'3" x 3'7"

Bedroom One
19'3" x 14'1"

Bedroom Two
14'6" x 8'6"

En Suite
7'4" x 3'11"

Bedroom Three
14'6" x 8'2"

Bathroom
7'4" x 5'6"

Total area: approx. 99.4 sq. metres (1069.5 sq. feet)

Please be advised the floorplans are not drawn to scale and are to be used to give an idea of the layout of the property.
Plan produced using PlanUp.

Energy Efficiency Rating		
	Current	Potential
Very energy efficient - lower running costs		
(92 plus) A		95
(81-91) B	85	
(69-80) C		
(55-68) D		
(39-54) E		
(21-38) F		
(1-20) G		
Not energy efficient - higher running costs		
England & Wales	EU Directive 2002/91/EC 	

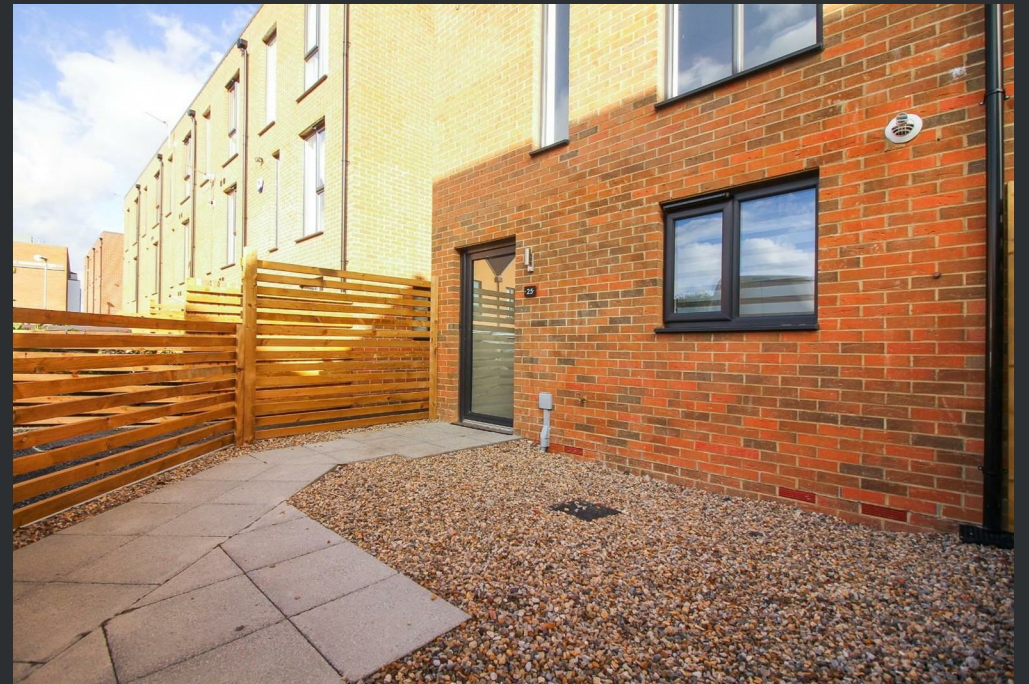



More 5 Star Customer Reviews than any other Agent based in the North East on allAgents.co.uk



SALES

LETTINGS

FINANCE

LAW

WE COVER THE WHOLE OF THE NORTH EAST

Whitley Bay
0191 251 3344

Cramlington
01670 897 213

Tynemouth
0191 296 6689

Morpeth
01670 513 966

Ponteland
01661 820 082

Wallsend
0191 432 4151

Alnwick
01665 511 800

Heaton
0191 432 4275

Forest Hall
0191 266 9966

Other locations
0191 640 3523

Newcastle
0191 640 2284

Durham
0191 303 8252

Gosforth
0191 640 3523

Sunderland
0191 543 6390

Whickham
0191 432 5102

Gateshead
0191 432 4294

Jesmond
0191 281 1037

Killingworth
0191 640 3602

Ryton
0191 413 9845

Head Office &
Lettings
0191 253 4815

*Highest recommended 5-star reviews than any other Estate Agent based in the North East on allAgents.co.uk - The UK's Largest Customer Review Website for the Property Industry & Awarded Best Estate Agency 2018 & 2019 - North East England by SME News