

SIGNATURE

NORTH EAST

OFFICIALLY RATED THE NO.1 ESTATE AGENT IN THE NORTH EAST





 Edmund Road, Newcastle Upon Tyne NE27 0HF

Edmund Road, Newcastle Upon Tyne NE27 0HF

Offers Over £365,000

Signature North East welcomes to the market this stunning detached house located on Edmund Road in the charming area of Holystone, Newcastle Upon Tyne. This beautiful new build has only had one owner and is situated in a desirable location, providing easy access to local amenities, schools, and transport links, making it an ideal choice for those looking for a convenient yet peaceful place to call home. Major road networks are just minutes away, ensuring you can quickly reach your destination.

As you step into the ample hallway, you access the living room, a bright and spacious area perfect for your desired furniture. The large bow window and a smaller window let natural light flood the space. Next, enter the open-plan kitchen/dining area. The kitchen offers a plethora of wall and base units for all your storage needs and meal prep. Adjacent to the kitchen, the dining area provides the ideal setting for family and friend gatherings. The space is completed with a set of French doors that invite the outdoors in and flood the room with natural light. The ground floor is completed with a utility room with an external door to the back garden and a WC.

On the first floor, you will find four generous double bedrooms, three of which include fitted wardrobes. The master bedroom is completed with his and hers wardrobes and an en-suite offering a walk-in shower, hand basin, and WC. Bedroom two also offers an en-suite with a walk-in shower, hand basin, and WC. This floor is completed with a family bathroom, which offers a bathtub, hand basin, and WC.

Outside, this property offers a private back garden with no neighbouring overlooks, featuring a patio area for your outdoor furniture and a lush grass area. For your parking convenience, the property is conveniently located at the end of the road, offering an additional parking spot in addition to the double drive and single garage.

Don't miss the opportunity. Give Signature North East a call and book your viewing.



PLEASE NOTE THAT THE VENDOR HAS CERTIFIED THE PROPERTY INFORMATION AND IMAGES.

PROPERTY FLOORPLAN

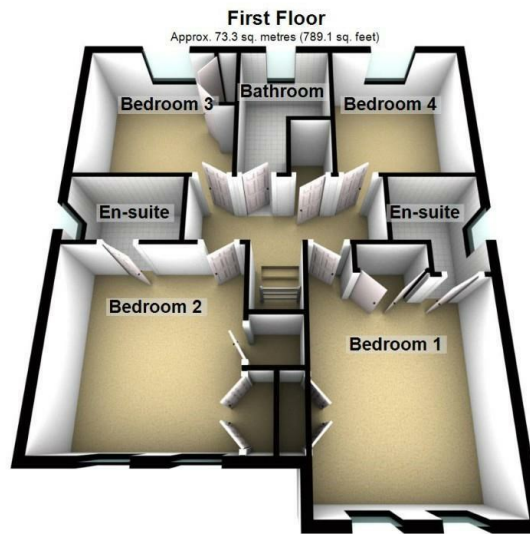
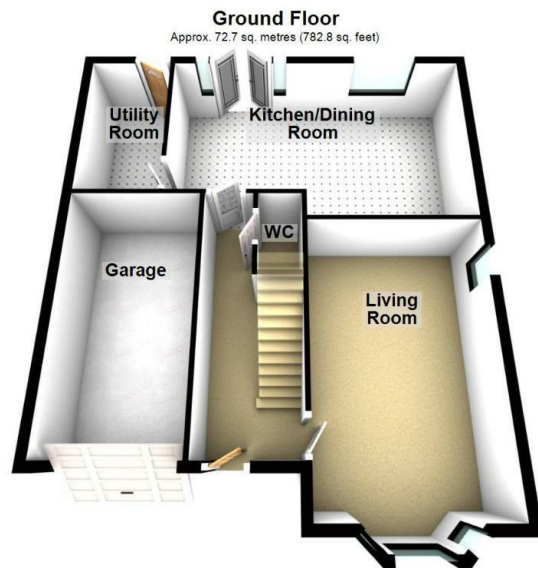

Total area: approx. 146.0 sq. metres (1571.9 sq. feet)

Please be advised the floorplans are not drawn to scale and are to be used to give an idea of the layout of the property.
Plan produced using PlanUp.

Measurements:

Living Room
17'11" x 11'2"

Kitchen / Dining Room
20'8" x 12'8"

Utility Room
10'8" x 5'8"

WC
5'5" x 2'10"

Bedroom one
15'0" x 11'2"

En Suite
6'8" x 5'10"

Bedroom Two
12'5" x 11'7"

En Suite
7'4" x 4'6"

Bedroom Three
10'9" x 10'7"

Bedroom Four
10'7" x 9'1"

Bathroom
10'7" x 6'4"

Energy Efficiency Rating

	Current	Potential
Very energy efficient - lower running costs		
(92 plus) A		93
(81-91) B	84	
(69-80) C		
(55-68) D		
(39-54) E		
(21-38) F		
(1-20) G		
Not energy efficient - higher running costs		
England & Wales	EU Directive 2002/91/EC	





More 5 Star Customer Reviews than any other Agent based in the North East on allAgents.co.uk



SALES

LETTINGS

FINANCE

LAW

WE COVER THE WHOLE OF THE NORTH EAST

Whitley Bay
0191 251 3344

Cramlington
01670 897 213

Tynemouth
0191 296 6689

Morpeth
01670 513 966

Ponteland
01661 820 082

Wallsend
0191 432 4151

Alnwick
01665 511 800

Heaton
0191 432 4275

Forest Hall
0191 266 9966

Other locations
0191 640 3523

Newcastle
0191 640 2284

Durham
0191 303 8252

Gosforth
0191 640 3523

Sunderland
0191 543 6390

Whickham
0191 432 5102

Gateshead
0191 432 4294

Jesmond
0191 281 1037

Killingworth
0191 640 3602

Ryton
0191 413 9845

Head Office &
Lettings
0191 253 4815

*Highest recommended 5-star reviews than any other Estate Agent based in the North East on allAgents.co.uk - The UK's Largest Customer Review Website for the Property Industry & Awarded Best Estate Agency 2018 & 2019 - North East England by SME News