

SIGNATURE

NORTH EAST

OFFICIALLY RATED THE NO.1 ESTATE AGENT IN THE NORTH EAST





 Bluebell Drive, Morpeth NE61 6FT

Bluebell Drive, Morpeth NE61 6FT

£1,150 Per Calendar Month

This charming 3-bedroom detached house in Morpeth offers a fantastic opportunity for a family home. The open-plan kitchen, dining, and living area are ideal for busy family life. All bedrooms are spacious enough to accommodate double beds, with the master bedroom featuring an en-suite for added convenience. The family bathroom includes both a bathtub and a shower, and there's an additional downstairs WC for guests. Outside, the garden boasts a generous patio area perfect for outdoor furniture, while the lawn provides ample space for kids to play. The property also includes a garage and a double driveway, ensuring plenty of off-road parking.

Situated in Pegswood, this home enjoys proximity to numerous parks, nature reserves, and walking trails, as well as a golf course just a few miles away. Pegswood combines the benefits of rural living with easy access to larger towns and cities, making it an ideal place to live, work, and raise a family.

Available August 2024
Tenancy Term: 12 months
Council Tax Band: D
£1,200 PCM

TENANCY APPLICATION FEES:

To apply for a tenancy on this property, a refundable holding deposit of a week's rent is required. A tenancy damage deposit for the property is compulsory and is to be paid 48 hours before the tenancy commences, along with the first months rent payment. The tenancy deposit is equivalent to one months rent. An additional tenancy deposit amount may be requested in certain circumstances.



PLEASE NOTE THAT THE VENDOR HAS CERTIFIED THE PROPERTY INFORMATION AND IMAGES.

PROPERTY FLOORPLAN

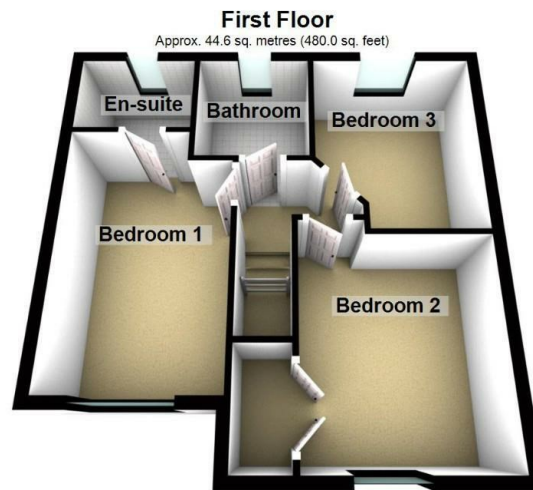
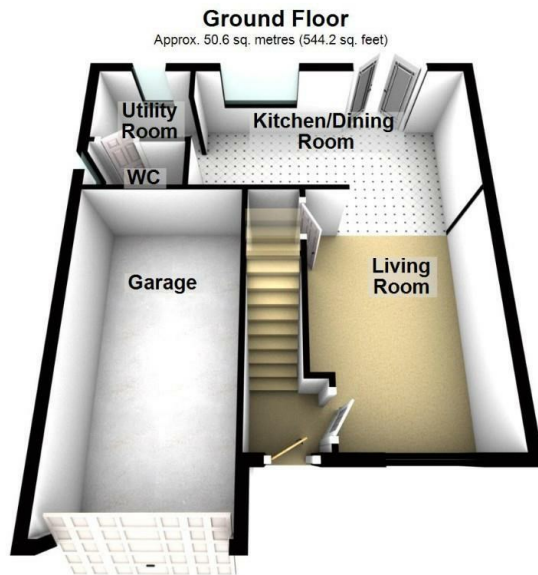

Total area: approx. 95.2 sq. metres (1024.2 sq. feet)
Please be advised the floorplans are not drawn to scale and are to be used to give an idea of the layout of the property.
Plan produced using PlanUp.

Measurements:

Living Room
14'1" x 10'0"

Kitchen / Dining Room
16'7" x 8'2"

Utility Room
5'7" x 4'11"

WC
5'7" x 3'0"

Bedroom One
14'3" x 9'0"

En Suite
6'6" x 4'6"

Bedroom Two
12'6" x 10'0"

Bedroom Three
10'9" x 9'0"

Bathroom
6'3" x 6'4"

Energy Efficiency Rating

	Current	Potential
Very energy efficient - lower running costs		
(92 plus) A		
(81-91) B		
(69-80) C		
(55-68) D		
(39-54) E		
(21-38) F		
(1-20) G		
Not energy efficient - higher running costs		
England & Wales	EU Directive 2002/91/EC	





More 5 Star Customer Reviews than any other Agent based in the North East on allAgents.co.uk



SALES

LETTINGS

FINANCE

LAW

WE COVER THE WHOLE OF THE NORTH EAST

Whitley Bay
0191 251 3344

Cramlington
01670 897 213

Tynemouth
0191 296 6689

Morpeth
01670 513 966

Ponteland
01661 820 082

Wallsend
0191 432 4151

Alnwick
01665 511 800

Heaton
0191 432 4275

Forest Hall
0191 266 9966

Other locations
0191 640 3523

Newcastle
0191 640 2284

Durham
0191 303 8252

Gosforth
0191 640 3523

Sunderland
0191 543 6390

Whickham
0191 432 5102

Gateshead
0191 432 4294

Jesmond
0191 281 1037

Killingworth
0191 640 3602

Ryton
0191 413 9845

Head Office &
Lettings
0191 253 4815

*Highest recommended 5-star reviews than any other Estate Agent based in the North East on allAgents.co.uk - The UK's Largest Customer Review Website for the Property Industry & Awarded Best Estate Agency 2018 & 2019 - North East England by SME News