

SIGNATURE

NORTH EAST

OFFICIALLY RATED THE NO.1 ESTATE AGENT IN THE NORTH EAST





 Rokeby Terrace, Heaton NE6 5SU

Rokeby Terrace, Heaton NE6 5SU

£895 Per Calendar Month

This ground floor flat features two spacious bedrooms, with the master bedroom offering a bay window that floods the room with natural light. The expansive living room serves as a central hub for socialising, seamlessly connecting to the generous kitchen area and bathroom. A standout feature of this property is the well-maintained garden, ideal for enjoying summer evenings, along with convenient garage access from the back lane.

Situated in Heaton, just off Chillingham Road, this location offers a vibrant social scene with numerous independent coffee shops, restaurants, and bars perfect for an enjoyable evening out. The area is surrounded by several schools, including Ravenswood Primary School, making it ideal for families. Chillingham Metro Station is within walking distance, providing easy transportation options. Additionally, a large Sainsbury's is just a two-minute drive away, and the Freeman Hospital is conveniently nearby. Outdoor enthusiasts will appreciate the proximity to Jesmond Dene, perfect for a leisurely stroll. The property is also adjacent to the Coast Road, offering quick connections to Newcastle city centre, Jesmond, Gosforth, and the coast.

Available June 2024
Tenancy Term: 12 months
Council Tax Band: A
£895 PCM

TENANCY APPLICATION FEES:

To apply for a tenancy on this property, a refundable holding deposit of a week's rent is required. A tenancy damage deposit for the property is compulsory and is to be paid 48 hours before the tenancy commences, along with the first months rent payment. The tenancy deposit is equivalent to one months rent. An additional tenancy deposit amount may be requested in certain circumstances.



PLEASE NOTE THAT THE VENDOR HAS CERTIFIED THE PROPERTY INFORMATION AND IMAGES.

PROPERTY FLOORPLAN

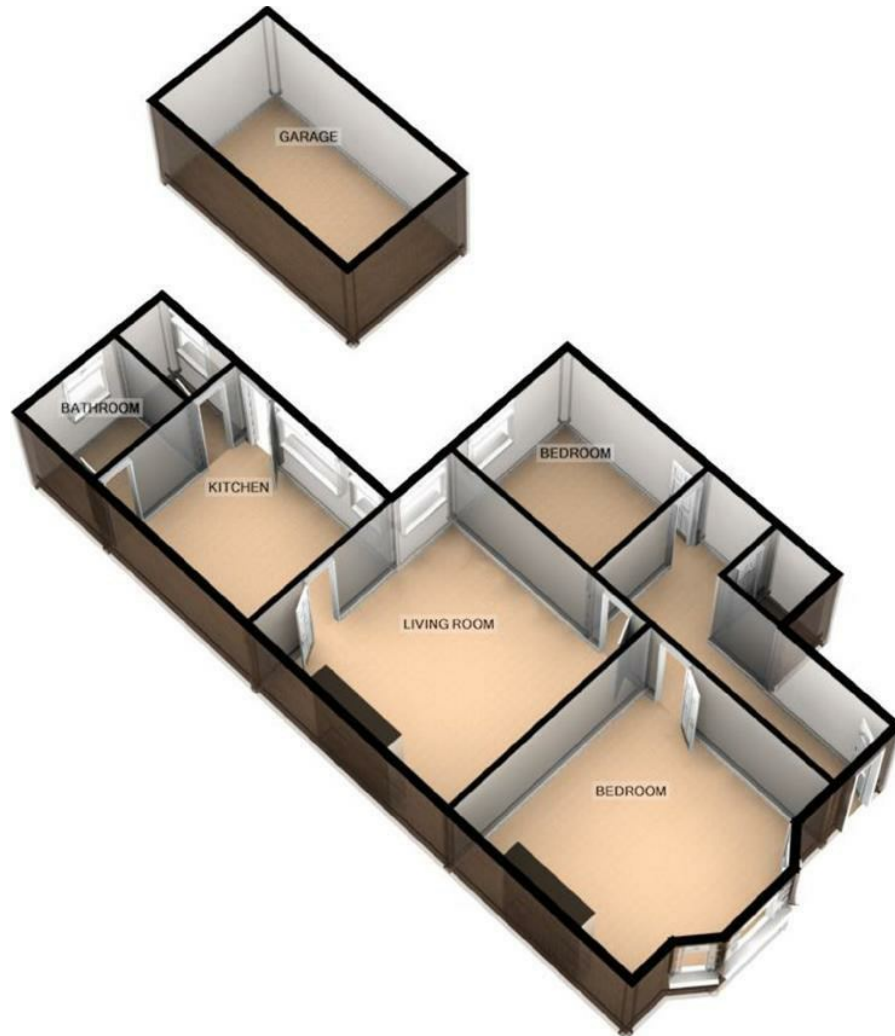

ROKEBY TERRACE, HEATON

For illustrative purposes only. Decorative finishes, fixtures, fittings and furnishings do not represent the current state of the property. Measurements are approximate. Not to scale
Made with Metropix ©2017

Measurements:

LIVING/DINING ROOM
14'1" x 14'0"

KITCHEN
11'4" x 9'11"

BEDROOM ONE
14'7" x 12'2"

BEDROOM TWO
10'0" x 8'6"

BATHROOM
6'7" x 5'8"

WC
4'4" x 3'0"

DETACHED GARAGE
15'7" x 6'3"

Energy Efficiency Rating

	Current	Potential
Very energy efficient - lower running costs		
(92 plus) A		
(81-91) B		
(69-80) C	70	76
(55-68) D		
(39-54) E		
(21-38) F		
(1-20) G		
Not energy efficient - higher running costs		

England & Wales

EU Directive
2002/91/EC







More 5 Star Customer Reviews than any other Agent based in the North East on allAgents.co.uk



SALES

LETTINGS

FINANCE

LAW

WE COVER THE WHOLE OF THE NORTH EAST

Whitley Bay
0191 251 3344

Cramlington
01670 897 213

Tynemouth
0191 296 6689

Morpeth
01670 513 966

Ponteland
01661 820 082

Wallsend
0191 432 4151

Alnwick
01665 511 800

Heaton
0191 432 4275

Forest Hall
0191 266 9966

Other locations
0191 640 3523

Newcastle
0191 640 2284

Durham
0191 303 8252

Gosforth
0191 640 3523

Sunderland
0191 543 6390

Whickham
0191 432 5102

Gateshead
0191 432 4294

Jesmond
0191 281 1037

Killingworth
0191 640 3602

Ryton
0191 413 9845

Head Office &
Lettings
0191 253 4815

*Highest recommended 5-star reviews than any other Estate Agent based in the North East on allAgents.co.uk - The UK's Largest Customer Review Website for the Property Industry & Awarded Best Estate Agency 2018 & 2019 - North East England by SME News