

SIGNATURE

NORTH EAST

OFFICIALLY RATED THE NO.1 ESTATE AGENT IN THE NORTH EAST





 Hotspur North, Newcastle Upon Tyne NE27 0GN

Hotspur North, Newcastle Upon Tyne NE27 0GN

Asking Price
£440,000

Signature North East are pleased to welcome to the market this stunning 5-bedroom detached property, situated in Backworth, Newcastle Upon Tyne. This property, just 5 years old, boasts a prime location with close proximity to local amenities and transport links. With the A19 nearby and Northumberland Park metro station just a five-minute walk away, residents can easily access the vibrant Newcastle City Centre and the beautiful coastline. Families will appreciate the convenience of Backworth Park Primary School just around the corner.

Upon entering, you are greeted by a central hallway leading to the spacious living room, internal access to the double garage, and open-plan kitchen diner. The living room offers ample space for furnishings, illuminated by a large window and featuring double doors leading to the open-plan kitchen dining room. The kitchen is a focal point, with attractive wall and base units, sleek countertops, integrated appliances, and elegant French doors opening to the rear garden. Completing the ground floor is a convenient W.C. and utility room with garden access.

Ascending to the first floor, you'll find 5 generously sized bedrooms. Bedroom 1 boasts ample storage with fitted wardrobes and an en-suite, while Bedrooms 2 and 3 also feature en-suites. The family bathroom offers a bathtub and shower combination, hand basin, and W.C, completing this floor's accommodation.

Externally, this home impresses with a large garden featuring AstroTurf and a spacious patio area, perfect for outdoor furniture. The back garden includes electricity/plug sockets for convenience, while the front of the property offers a double driveway and landscaped grass, ensuring low maintenance living for the lucky new owners.



PLEASE NOTE THAT THE VENDOR HAS CERTIFIED THE PROPERTY INFORMATION AND IMAGES.

PROPERTY FLOORPLAN

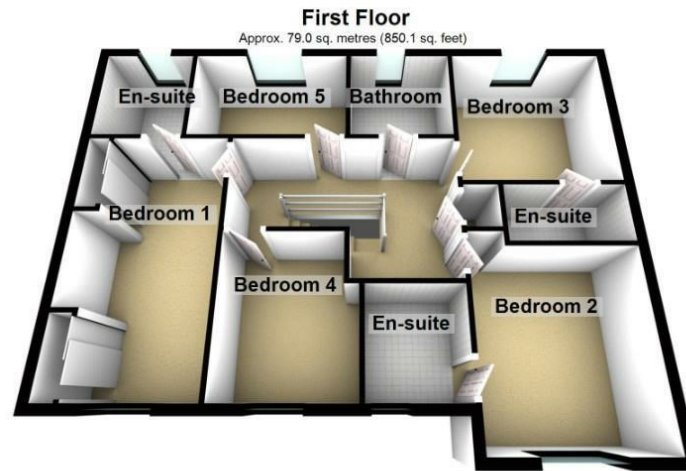

Total area: approx. 163.4 sq. metres (1758.7 sq. feet)

Please be advised the floorplans are not drawn to scale and are to be used to give an idea of the layout of the property.
Plan produced using PlanUp.

Measurements:

Living Room
19'1" x 11'0"

Kitchen / Dining Room
29'0" x 9'9"

Utility Room
6'4" x 5'1"

WC
5'5" x 3'1"

Bedroom One
16'10" x 9'2"

En Suite
6'6" x 6'0"

Bedroom Two
12'9" x 10'11"

En Suite
6'9" x 5'4"

Bedroom Three
10'4" x 10'0"

En Suite
8'1" x 3'10"

Bedroom Four
10'0" x 8'4"

Bedroom Five
10'8" x 6'6"

Bathroom
6'10" x 6'6"

Energy Efficiency Rating

	Current	Potential
Very energy efficient - lower running costs		
(92 plus) A		91
(81-91) B	83	
(69-80) C		
(55-68) D		
(39-54) E		
(21-38) F		
(1-20) G		
Not energy efficient - higher running costs		

England & Wales

EU Directive
2002/91/EC







More 5 Star Customer Reviews than any other Agent based in the North East on allAgents.co.uk



SALES

LETTINGS

FINANCE

LAW

WE COVER THE WHOLE OF THE NORTH EAST

Whitley Bay
0191 251 3344

Cramlington
01670 897 213

Tynemouth
0191 296 6689

Morpeth
01670 513 966

Ponteland
01661 820 082

Wallsend
0191 432 4151

Alnwick
01665 511 800

Heaton
0191 432 4275

Forest Hall
0191 266 9966

Other locations
0191 640 3523

Newcastle
0191 640 2284

Durham
0191 303 8252

Gosforth
0191 640 3523

Sunderland
0191 543 6390

Whickham
0191 432 5102

Gateshead
0191 432 4294

Jesmond
0191 281 1037

Killingworth
0191 640 3602

Ryton
0191 413 9845

Head Office &
Lettings
0191 253 4815

*Highest recommended 5-star reviews than any other Estate Agent based in the North East on allAgents.co.uk - The UK's Largest Customer Review Website for the Property Industry & Awarded Best Estate Agency 2018 & 2019 - North East England by SME News