

# SIGNATURE

## NORTH EAST

OFFICIALLY RATED THE NO.1 ESTATE AGENT IN THE NORTH EAST





 Tilbury Grove, North Shields NE30 3HL

# Tilbury Grove, North Shields NE30 3HL

**Offers Over £365,000**

Welcome to Tilbury Grove, North Shields, where Signature North East proudly presents this charming semi-detached bungalow, offering a delightful blend of modern living and convenience. Spanning two storeys, this property boasts three bedrooms, providing ample space for comfortable living. For families, the property is situated within close proximity to esteemed schools such as Monkseaton High School and Star of the Sea, enhancing its appeal. Located close to the A19 and offering easy access to road links to Newcastle, commuting is a breeze. Nearby, you'll find a plethora of local amenities, including supermarkets, restaurants, and more, ensuring all your daily needs are catered to.

Step inside to discover a spacious open-plan layout, seamlessly integrating the living room, kitchen, and dining area, perfect for family gatherings or entertaining guests. The kitchen, fitted in 2019, is modern and functional, complemented by a conservatory at the rear of the property, extending the living space further.

With three bathrooms, including an en-suite in the master bedroom, convenience is prioritized. The house is bathed in natural light, courtesy of large windows throughout, creating an airy and inviting ambiance. With ample storage throughout and generously sized bedrooms, this home combines practicality with comfort, ensuring a relaxed lifestyle for its lucky inhabitants.

Outside, a private rear garden awaits, complete with a lush lawn and patio, providing the perfect setting for outdoor activities or simply basking in the sun. A garage and paved driveway offer convenient parking and storage solutions.

Don't miss the opportunity to make this beautiful property your new home. Contact Signature North East today to arrange a viewing and start envisioning your life in Tilbury Grove.



PLEASE NOTE THAT THE VENDOR HAS CERTIFIED THE PROPERTY INFORMATION AND IMAGES.

# PROPERTY FLOORPLAN

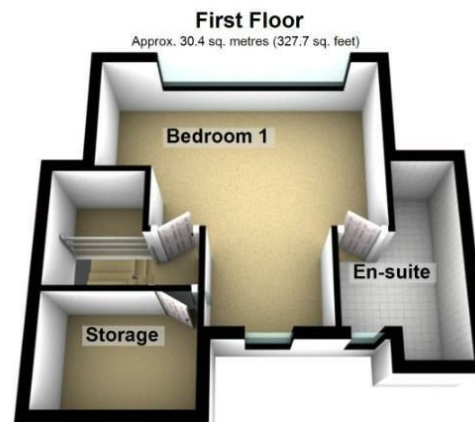
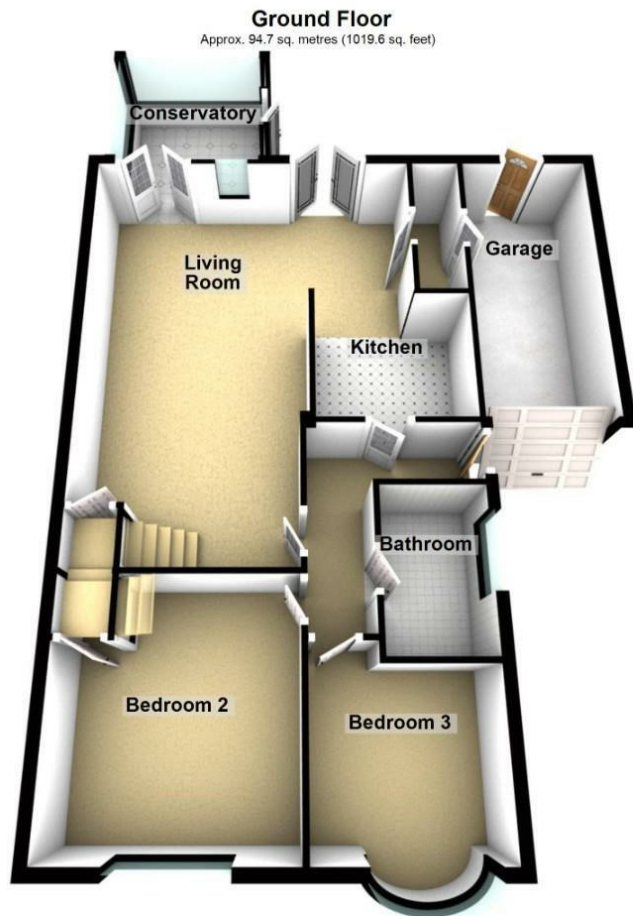

Total area: approx. 125.2 sq. metres (1347.2 sq. feet)

Please be advised the floorplans are not drawn to scale and are to be used to give an idea of the layout of the property.  
Plan produced using PlanUp.

## Measurements:

Living Room  
21'3" x 18'6"

Kitchen  
8'8" x 7'6"

Conservatory  
8'7" x 7'11"

Bedroom One  
15'7" x 15'2"

En Suite  
10'8" x 6'4"

Bedroom Two  
12'11" x 12'0"

Bedroom Three  
9'8" x 9'2"

Bathroom  
8'7" x 5'5"

## Energy Efficiency Rating

	Current	Potential
Very energy efficient - lower running costs		
(92 plus) <b>A</b>		
(81-91) <b>B</b>		<b>83</b>
(69-80) <b>C</b>		
(55-68) <b>D</b>		
(39-54) <b>E</b>	<b>48</b>	
(21-38) <b>F</b>		
(1-20) <b>G</b>		
Not energy efficient - higher running costs		
<b>England &amp; Wales</b>		EU Directive 2002/91/EC 





More 5 Star Customer Reviews than any other Agent based in the North East on allAgents.co.uk



**SALES**

**LETTINGS**

**FINANCE**

**LAW**

**WE COVER THE WHOLE OF THE NORTH EAST**

Whitley Bay  
0191 251 3344

Cramlington  
01670 897 213

Tynemouth  
0191 296 6689

Morpeth  
01670 513 966

Ponteland  
01661 820 082

Wallsend  
0191 432 4151

Alnwick  
01665 511 800

Heaton  
0191 432 4275

Forest Hall  
0191 266 9966

Other locations  
0191 640 3523

Newcastle  
0191 640 2284

Durham  
0191 303 8252

Gosforth  
0191 640 3523

Sunderland  
0191 543 6390

Whickham  
0191 432 5102

Gateshead  
0191 432 4294

Jesmond  
0191 281 1037

Killingworth  
0191 640 3602

Ryton  
0191 413 9845

Head Office &  
Lettings  
0191 253 4815

\*Highest recommended 5-star reviews than any other Estate Agent based in the North East on allAgents.co.uk - The UK's Largest Customer Review Website for the Property Industry & Awarded Best Estate Agency 2018 & 2019 - North East England by SME News