

SIGNATURE

NORTH EAST

OFFICIALLY RATED THE NO.1 ESTATE AGENT IN THE NORTH EAST





 Tilbury Grove, North Shields NE30 3HL

Tilbury Grove, North Shields NE30 3HL

Offers Over £365,000

Welcome to Tilbury Grove, North Shields, where Signature North East proudly presents this charming semi-detached bungalow, offering a delightful blend of modern living and convenience. Spanning two storeys, this property boasts three bedrooms, providing ample space for comfortable living. For families, the property is situated within close proximity to esteemed schools such as Monkseaton High School and Star of the Sea, enhancing its appeal. Located close to the A19 and offering easy access to road links to Newcastle, commuting is a breeze. Nearby, you'll find a plethora of local amenities, including supermarkets, restaurants, and more, ensuring all your daily needs are catered to.

Step inside to discover a spacious open-plan layout, seamlessly integrating the living room, kitchen, and dining area, perfect for family gatherings or entertaining guests. The kitchen, fitted in 2019, is modern and functional, complemented by a conservatory at the rear of the property, extending the living space further.

With three bathrooms, including an en-suite in the master bedroom, convenience is prioritized. The house is bathed in natural light, courtesy of large windows throughout, creating an airy and inviting ambiance. With ample storage throughout and generously sized bedrooms, this home combines practicality with comfort, ensuring a relaxed lifestyle for its lucky inhabitants.

Outside, a private rear garden awaits, complete with a lush lawn and patio, providing the perfect setting for outdoor activities or simply basking in the sun. A garage and paved driveway offer convenient parking and storage solutions.

Don't miss the opportunity to make this beautiful property your new home. Contact Signature North East today to arrange a viewing and start envisioning your life in Tilbury Grove.



PLEASE NOTE THAT THE VENDOR HAS CERTIFIED THE PROPERTY INFORMATION AND IMAGES.

PROPERTY FLOORPLAN

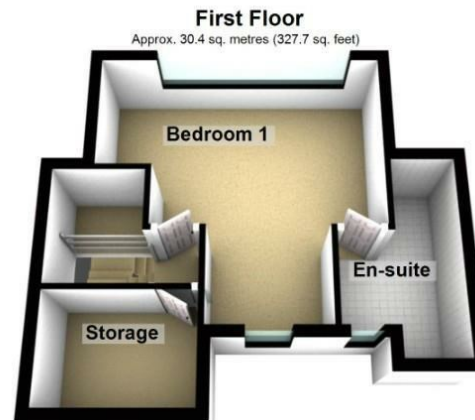
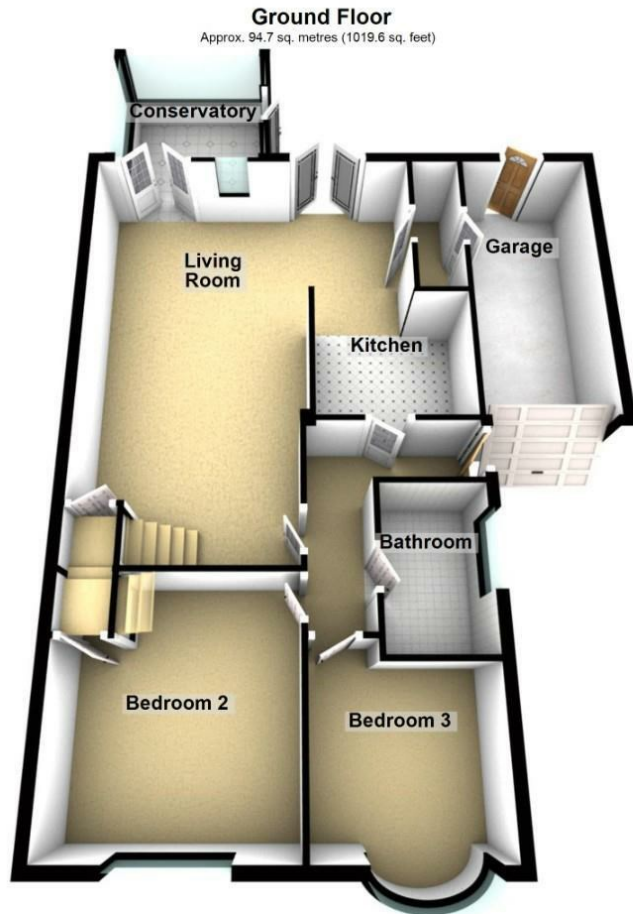

Total area: approx. 125.2 sq. metres (1347.2 sq. feet)

Please be advised the floorplans are not drawn to scale and are to be used to give an idea of the layout of the property.
Plan produced using PlanUp.

Measurements:

Living Room
21'3" x 18'6"

Kitchen
8'8" x 7'6"

Conservatory
8'7" x 7'11"

Bedroom One
15'7" x 15'2"

En Suite
10'8" x 6'4"

Bedroom Two
12'11" x 12'0"

Bedroom Three
9'8" x 9'2"

Bathroom
8'7" x 5'5"

Energy Efficiency Rating

	Current	Potential
Very energy efficient - lower running costs		
(92 plus) A		
(81-91) B		83
(69-80) C		
(55-68) D		
(39-54) E	48	
(21-38) F		
(1-20) G		
Not energy efficient - higher running costs		
England & Wales		EU Directive 2002/91/EC 





More 5 Star Customer Reviews than any other Agent based in the North East on allAgents.co.uk



SALES

LETTINGS

FINANCE

LAW

WE COVER THE WHOLE OF THE NORTH EAST

Whitley Bay
0191 251 3344

Cramlington
01670 897 213

Tynemouth
0191 296 6689

Morpeth
01670 513 966

Ponteland
01661 820 082

Wallsend
0191 432 4151

Alnwick
01665 511 800

Heaton
0191 432 4275

Forest Hall
0191 266 9966

Other locations
0191 640 3523

Newcastle
0191 640 2284

Durham
0191 303 8252

Gosforth
0191 640 3523

Sunderland
0191 543 6390

Whickham
0191 432 5102

Gateshead
0191 432 4294

Jesmond
0191 281 1037

Killingworth
0191 640 3602

Ryton
0191 413 9845

Head Office &
Lettings
0191 253 4815

*Highest recommended 5-star reviews than any other Estate Agent based in the North East on allAgents.co.uk - The UK's Largest Customer Review Website for the Property Industry & Awarded Best Estate Agency 2018 & 2019 - North East England by SME News