

SIGNATURE

NORTH EAST

OFFICIALLY RATED THE NO.1 ESTATE AGENT IN THE NORTH EAST





 Albatross Way, Ashington NE63 9WW

Albatross Way, Ashington NE63 9WW

Offers Over £220,000

Signature North East welcomes you to the market with this delightful detached property in Albatross Way, Ashington. This home boasts a range of amenities that cater to residents' needs. Local shops and supermarkets provide easy access to groceries and essentials, while nearby parks offer green spaces for relaxation and recreation. Families benefit from quality primary and secondary schools, alongside healthcare facilities. Public transport options ensure convenience travel, with easy connections to major road network.

Step inside the ample hallway and into the kitchen/dining room, the perfect setting for family gatherings or formal dinners. The kitchen offers a plethora of wall and base units for storage and plenty of counter space for meal prep. Adjacent to the kitchen is the living room. This creates a wonderful environment for social gatherings or simply relaxing with loved one. A downstairs WC completes the ground floor.

On the first floor, you will find three well-appointed bedrooms. Bedroom 1 and 2 are perfect doubles, offering a retreat at the end of the day, while Bedroom 3 is ideal for a nursery or a home office. The three-piece bathroom, completed with a bathtub and shower, provides convenience and a touch of relaxation.

Outside, the south-facing back garden features an ample patio for outdoor living, and a flower border adds natural vibrancy. For parking arrangements, the single garage offers convenience and extra storage solutions.

With its prime location, thoughtful design, and outdoor charm, this property is a turnkey move-in. Don't miss the fantastic opportunity to call it your own. Call Signature North East today and book your viewing!



PLEASE NOTE THAT THE VENDOR HAS CERTIFIED THE PROPERTY INFORMATION AND IMAGES.

PROPERTY FLOORPLAN

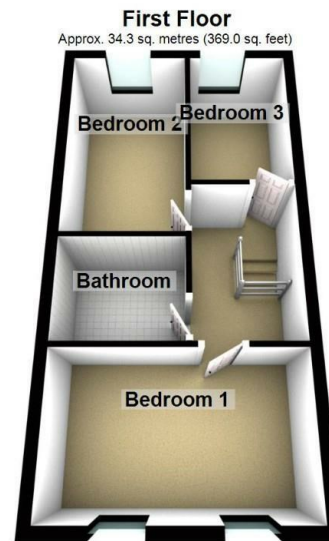
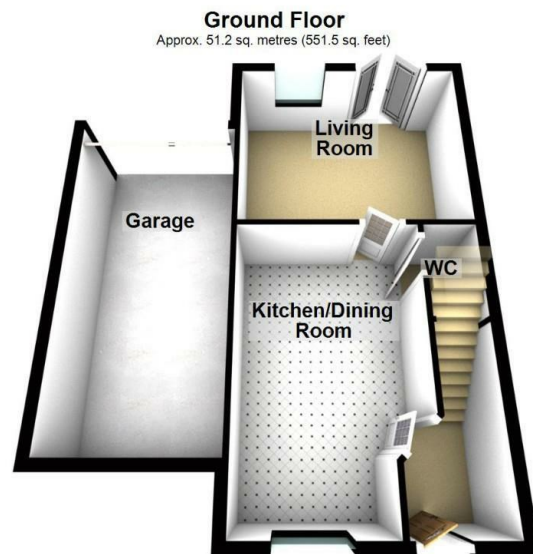

Total area: approx. 85.5 sq. metres (920.5 sq. feet)

Please be advised the floorplans are not drawn to scale and are to be used to give an idea of the layout of the property.
Plan produced using PlanUp.

Measurements:

Living Room
13'6" x 10'9"

Kitchen / Dining Room
16'1" x 10'2"

WC
5'5" x 2'11"

Bedroom One
13'6" x 8'3"

Bedroom Two
12'4" x 7'1"

Bedroom Three
9'1" x 6'0"

Bathroom
7'1" x 5'11"

Energy Efficiency Rating

	Current	Potential
Very energy efficient - lower running costs		
(92 plus) A		96
(81-91) B	83	
(69-80) C		
(55-68) D		
(39-54) E		
(21-38) F		
(1-20) G		
Not energy efficient - higher running costs		
England & Wales	EU Directive 2002/91/EC	





More 5 Star Customer Reviews than any other Agent based in the North East on allAgents.co.uk



SALES

LETTINGS

FINANCE

LAW

WE COVER THE WHOLE OF THE NORTH EAST

Whitley Bay
0191 251 3344

Cramlington
01670 897 213

Tynemouth
0191 296 6689

Morpeth
01670 513 966

Ponteland
01661 820 082

Wallsend
0191 432 4151

Alnwick
01665 511 800

Heaton
0191 432 4275

Forest Hall
0191 266 9966

Other locations
0191 640 3523

Newcastle
0191 640 2284

Durham
0191 303 8252

Gosforth
0191 640 3523

Sunderland
0191 543 6390

Whickham
0191 432 5102

Gateshead
0191 432 4294

Jesmond
0191 281 1037

Killingworth
0191 640 3602

Ryton
0191 413 9845

Head Office &
Lettings
0191 253 4815

*Highest recommended 5-star reviews than any other Estate Agent based in the North East on allAgents.co.uk - The UK's Largest Customer Review Website for the Property Industry & Awarded Best Estate Agency 2018 & 2019 - North East England by SME News