

# SIGNATURE

## NORTH EAST

OFFICIALLY RATED THE NO.1 ESTATE AGENT IN THE NORTH EAST







 Linton Road, North Tyneside NE26 4NX



# Linton Road, North Tyneside NE26 4NX

## Offers Over £340,000

Signature North East is pleased to introduce this charming three-bedroom residence. Nestled in the heart of Whitley Bay, this beloved family home boasts generously sized rooms and an excellent location, just a 10-minute stroll to the beach. Enjoying proximity to great restaurants, shops, and convenient transportation links, this property presents a wonderful opportunity for families seeking a well-loved and strategically situated home.

Upon entering this property, you are greeted by an inviting vestibule that leads you to the central hallway and a conveniently located WC. The first stop is the living room, featuring a fireplace with a surround that creates a cosy ambiance. This room offers ample space for furnishings. Next, you arrive at the dining room, easily accommodating a family dining table. From here, you can access the kitchen, adorned with wall and base units providing abundant storage space. The conservatory serves as an ideal spot to relax and overlook the garden, and from here, you can access the rear garden.

Ascending to the first floor, you will find three generously sized bedrooms, with two easily accommodating a double bed and your preferred furnishings. The third single bedroom serves as a versatile space, ready for your transformation. Completing the home is the bathroom, fitted just five years ago, which includes a walk-in shower, hand basin, and WC.

Externally, to the rear of the home, you'll discover a generous back garden, complemented by side gardens adorned with a lovely lawn and enhanced by greenery and trees. Off-street parking is conveniently available for cars through a spacious driveway and a detached garage.



PLEASE NOTE THAT THE VENDOR HAS CERTIFIED THE PROPERTY INFORMATION AND IMAGES.

# PROPERTY FLOORPLAN

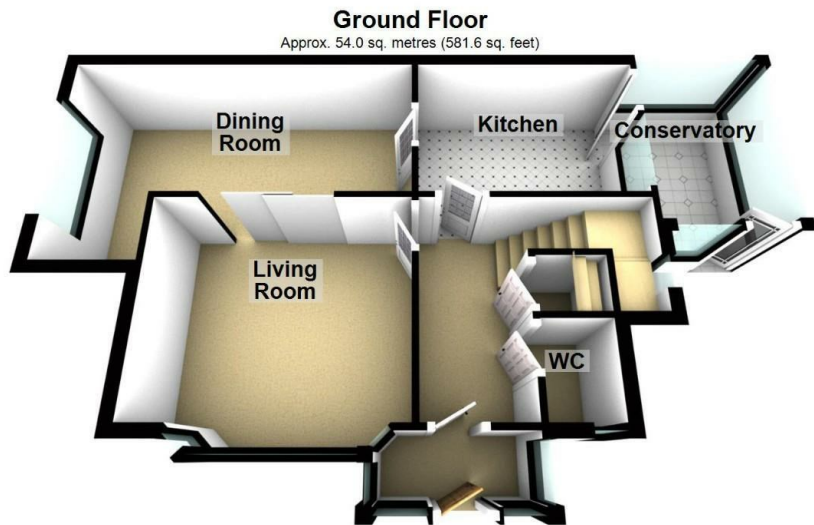

**Ground Floor**  
Approx. 54.0 sq. metres (581.6 sq. feet)

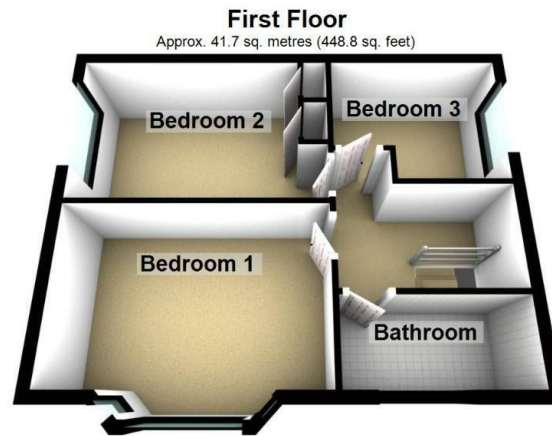

**First Floor**  
Approx. 41.7 sq. metres (448.8 sq. feet)

Total area: approx. 95.7 sq. metres (1030.4 sq. feet)

Please be advised the floorplans are not drawn to scale and are to be used to give an idea of the layout of the property.  
Plan produced using PlanUp.

## Measurements:

Living Room  
12'4" x 10'6"

Dining Room  
17'8" x 11'1"

Kitchen  
11'3" x 7'6"

Conservatory  
9'0" x 6'5"

WC  
4'5" x 3'3"

Bedroom One  
14'1" x 9'4"

Bedroom Two  
14'1" x 8'10"

Bedroom Three  
9'6" x 7'6"

Bathroom  
9'6" x 4'5"

## Energy Efficiency Rating

	Current	Potential
Very energy efficient - lower running costs		
(92 plus) <b>A</b>		
(81-91) <b>B</b>		<b>81</b>
(69-80) <b>C</b>		
(55-68) <b>D</b>	<b>62</b>	
(39-54) <b>E</b>		
(21-38) <b>F</b>		
(1-20) <b>G</b>		
Not energy efficient - higher running costs		
<b>England &amp; Wales</b>	EU Directive 2002/91/EC 	









More 5 Star Customer Reviews than any other Agent based in the North East on allAgents.co.uk



**SALES**

**LETTINGS**

**FINANCE**

**LAW**

**WE COVER THE WHOLE OF THE NORTH EAST**

Whitley Bay  
0191 251 3344

Cramlington  
01670 897 213

Tynemouth  
0191 296 6689

Morpeth  
01670 513 966

Ponteland  
01661 820 082

Wallsend  
0191 432 4151

Alnwick  
01665 511 800

Heaton  
0191 432 4275

Forest Hall  
0191 266 9966

Other locations  
0191 640 3523

Newcastle  
0191 640 2284

Durham  
0191 303 8252

Gosforth  
0191 640 3523

Sunderland  
0191 543 6390

Whickham  
0191 432 5102

Gateshead  
0191 432 4294

Jesmond  
0191 281 1037

Killingworth  
0191 640 3602

Ryton  
0191 413 9845

Head Office &  
Lettings  
0191 253 4815

\*Highest recommended 5-star reviews than any other Estate Agent based in the North East on allAgents.co.uk - The UK's Largest Customer Review Website for the Property Industry & Awarded Best Estate Agency 2018 & 2019 - North East England by SME News