

# SIGNATURE

## NORTH EAST

OFFICIALLY RATED THE NO.1 ESTATE AGENT IN THE NORTH EAST







Simonside, Whitley Bay NE26 4BN



# Simonside, Whitley Bay NE26 4BN

**Offers Over £450,000**

Signature North East is delighted to present this brilliant two bedroom bungalow situated in the serene area of Whitley Bay. The property features spacious rooms throughout and benefits from a fantastic location that provides unparalleled views of the countryside from the rear garden. Additionally, it offers proximity to a wealth of useful amenities, including the beautiful coastline, local shops, and eateries, presenting a great opportunity for those seeking an inviting and well-located home.

Stepping into this delightful home, you are warmly welcomed by an inviting central hallway that provides access to the main principal rooms, along with a conveniently located W.C. Upon entering the living room, abundant natural light floods in through the large window and bi-fold doors, leading to the rear garden. The room features a fireplace with a surround and ample space to accommodate any desired furnishings. Moving on, you will enter the kitchen area, where a plethora of storage space is provided through shaker-style wall and base units.

Continuing your journey, you will discover two generously sized bedrooms, both easily accommodating a double bed along with any of your preferred furnishings. Completing the home is the main bathroom, featuring a bathtub, shower, and hand basin.

Externally, to the rear of the property, you will discover an expansive garden predominantly laid with a beautiful lawn, surrounded by scenic greenery and shrubbery. Additionally, there is a raised paved patio, providing the perfect place for relaxation and enjoying tranquil views of the countryside. This property also offers a wealth of off-street parking through garages and a driveway.



PLEASE NOTE THAT THE VENDOR HAS CERTIFIED THE PROPERTY INFORMATION AND IMAGES.

# PROPERTY FLOORPLAN

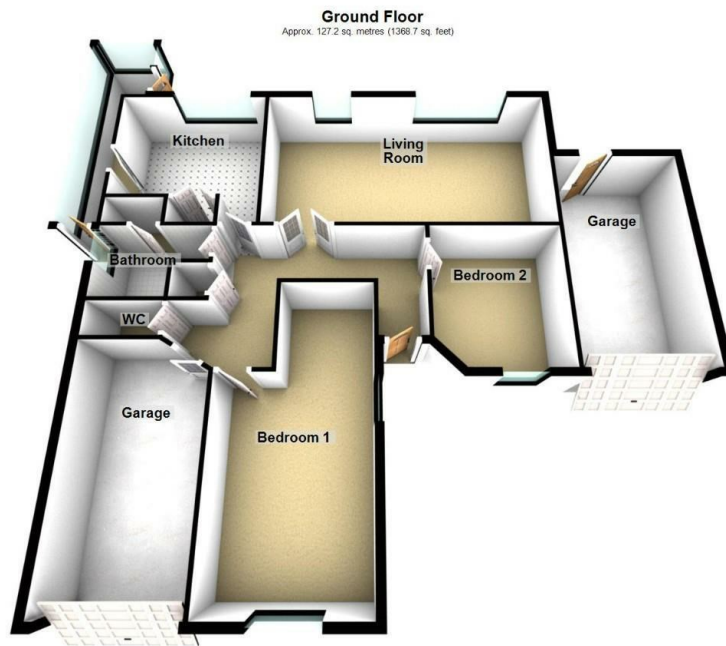

**Ground Floor**  
Approx. 127.2 sq. metres (1368.7 sq. feet)

Total area: approx. 127.2 sq. metres (1368.7 sq. feet)

Please be advised the floorplans are not drawn to scale and are to be used to give an idea of the layout of the property.  
Plan produced using PlanUp.

## Measurements:

Living Room  
22'9" x 11'10"

Kitchen  
11'10" x 11'10"

Bedroom One  
21'10" x 11'1"

Bedroom Two  
11'1" x 9'10"

Bathroom  
8'6" x 5'10"

WC  
5'6" x 2'7"

## Energy Efficiency Rating

	Current	Potential
<i>Very energy efficient - lower running costs</i>		
(92 plus) <b>A</b>		
(81-91) <b>B</b>		
(69-80) <b>C</b>		
(55-68) <b>D</b>		
(39-54) <b>E</b>		
(21-38) <b>F</b>		
(1-20) <b>G</b>		
<i>Not energy efficient - higher running costs</i>		
<b>England &amp; Wales</b>	EU Directive 2002/91/EC 	









More 5 Star Customer Reviews than any other Agent based in the North East on allAgents.co.uk



**SALES**

**LETTINGS**

**FINANCE**

**LAW**

**WE COVER THE WHOLE OF THE NORTH EAST**

Whitley Bay  
0191 251 3344

Cramlington  
01670 897 213

Tynemouth  
0191 296 6689

Morpeth  
01670 513 966

Ponteland  
01661 820 082

Wallsend  
0191 432 4151

Alnwick  
01665 511 800

Heaton  
0191 432 4275

Forest Hall  
0191 266 9966

Other locations  
0191 640 3523

Newcastle  
0191 640 2284

Durham  
0191 303 8252

Gosforth  
0191 640 3523

Sunderland  
0191 543 6390

Whickham  
0191 432 5102

Gateshead  
0191 432 4294

Jesmond  
0191 281 1037

Killingworth  
0191 640 3602

Ryton  
0191 413 9845

Head Office &  
Lettings  
0191 253 4815

\*Highest recommended 5-star reviews than any other Estate Agent based in the North East on allAgents.co.uk - The UK's Largest Customer Review Website for the Property Industry & Awarded Best Estate Agency 2018 & 2019 - North East England by SME News