

SIGNATURE

NORTH EAST

OFFICIALLY RATED THE NO.1 ESTATE AGENT IN THE NORTH EAST





 Fallowfield Way, Ashington NE63 8LD

Fallowfield Way, Ashington NE63 8LD

Offers Over £250,000

Signature North East is thrilled to introduce this charming three-bedroom detached bungalow, nestled in the highly coveted area of Ashington. This delightful residence features elegant sash windows and generously sized rooms, complemented by a prime location that offers close proximity to an array of convenient amenities, including excellent local shops and easy access to major roads. Additionally, it is just a short distance from the nearby beautiful coastline.

Upon entry, a welcoming hallway provides access to the main principal rooms of the home. First, is the spacious living room, bathed in natural light through its large window, offering abundant space for your desired furnishings. Moving forward, you enter the charming kitchen, enhanced with underfloor heating, Stylish shaker-style wall and base units, along with tasteful countertops, providing ample storage. The kitchen is further equipped with integrated appliances, including a fridge, and washing machine. Continuing your exploration, you'll discover the dining room, which offers the ability to accommodate a family table. This room features a fireplace with a surround, adding a cosy ambiance to the space.

Continuing your exploration through this home, you'll find three generous bedrooms, with two easily accommodating a double bed and your preferred furnishings, while the third provides a versatile space ready to be transformed to suit your needs. The master bedroom is enhanced by fitted wardrobes for added convenience. Completing the home is the delightful main bathroom, fitted in just December 2022, featuring ornate tiles, a separate walk-in shower, a vanity with a hand basin, and a W.C. Additionally, this home features a boarded and carpeted loft, providing an ideal solution for additional storage space.

Externally, this home presents a delightful, generously sized garden predominantly adorned with a beautiful lawn and surrounded by plants and bushes. The garden also features paved patio areas, providing an ideal setting for alfresco dining or relaxation while overlooking the greenery. At the front of the property, an ample garden surrounded by plants welcomes you. Convenient off-street parking for two cars is available through an electric garage and a driveway.



PLEASE NOTE THAT THE VENDOR HAS CERTIFIED THE PROPERTY INFORMATION AND IMAGES.

PROPERTY FLOORPLAN

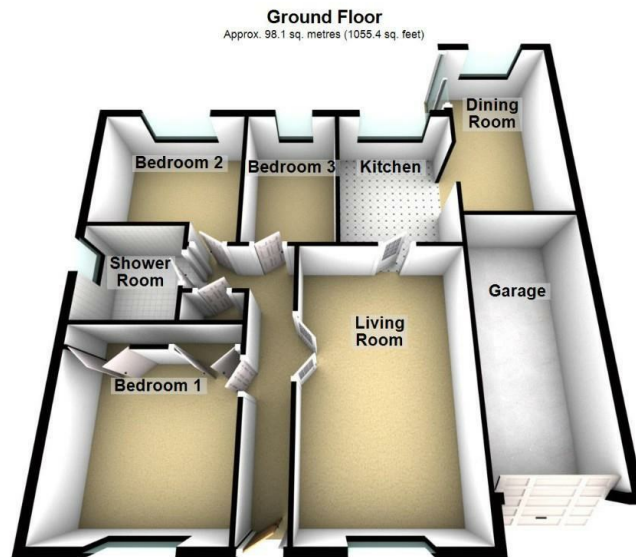

Total area: approx. 98.1 sq. metres (1055.4 sq. feet)
Please be advised the floorplans are not drawn to scale and are to be used to give an idea of the layout of the property.
Plan produced using PlanUp.

Measurements:

Living Room
18'11" x 11'3"

Dining Room
14'10" x 7'11"

Kitchen
10'7" x 8'5"

Bedroom One
12'10" x 11'5"

Bedroom Two
10'7" x 10'6"

Bedroom Three
10'7" x 6'7"

Shower Room
6'11" x 6'10"

Energy Efficiency Rating

| | Current | Potential |
|---|---------|---|
| Very energy efficient - lower running costs | | |
| (92 plus) A | | 85 |
| (81-91) B | | |
| (69-80) C | | 57 |
| (55-68) D | | |
| (39-54) E | | |
| (21-38) F | | |
| (1-20) G | | |
| Not energy efficient - higher running costs | | |
| England & Wales | | EU Directive 2002/91/EC  |





More 5 Star Customer Reviews than any other Agent based in the North East on allAgents.co.uk



SALES

LETTINGS

FINANCE

LAW

WE COVER THE WHOLE OF THE NORTH EAST

Whitley Bay
0191 251 3344

Cramlington
01670 897 213

Tynemouth
0191 296 6689

Morpeth
01670 513 966

Ponteland
01661 820 082

Wallsend
0191 432 4151

Alnwick
01665 511 800

Heaton
0191 432 4275

Forest Hall
0191 266 9966

Other locations
0191 640 3523

Newcastle
0191 640 2284

Durham
0191 303 8252

Gosforth
0191 640 3523

Sunderland
0191 543 6390

Whickham
0191 432 5102

Gateshead
0191 432 4294

Jesmond
0191 281 1037

Killingworth
0191 640 3602

Ryton
0191 413 9845

Head Office &
Lettings
0191 253 4815

*Highest recommended 5-star reviews than any other Estate Agent based in the North East on allAgents.co.uk - The UK's Largest Customer Review Website for the Property Industry & Awarded Best Estate Agency 2018 & 2019 - North East England by SME News