

SIGNATURE

NORTH EAST

OFFICIALLY RATED THE NO.1 ESTATE AGENT IN THE NORTH EAST





📍 Newburgh Avenue, Whitley Bay NE25 0JW

Newburgh Avenue, Whitley Bay NE25 0JW

Offers Over £94,950

Signature North East is pleased to introduce this charming two-bedroom, ground-floor flat situated, in the delightful area of Seaton Delaval. This property features generously sized rooms and enjoys a fantastic location, providing proximity to the beautiful coastline, local shops, and excellent restaurants. With its generous layout and prime location, this flat presents an ideal opportunity for both investors and first-time buyers alike.

Upon entering, a welcoming vestibule guides you to the light-filled living room. Illuminated by a large window, the living room offers ample space for your preferred furnishings. Connecting seamlessly, the kitchen area provides ample storage facilitated by base and wall units that are complimented by tasteful black worktops. The kitchen also grants access to the rear garden, enhancing the overall flow and accessibility of the space.

Continuing your exploration, you will find two generously sized bedrooms, each capable of comfortably accommodating a double bed and your preferred furnishings. The master bedroom is enhanced by fitted wardrobes, providing ideal additional storage space. Concluding the home is a delightful shower room renovated in 2019, showcasing lovely tiling along with a separate walk-in shower, a vanity with a hand basin, and a W.C.

At the rear of the flat, a generously proportioned paved garden awaits, adorned with charming plants and bushes, creating an ideal setting for outdoor dining and relaxation. Additionally, the property offers convenient off-street parking for one car through a garage and a driveway situated in front of it.



PLEASE NOTE THAT THE VENDOR HAS CERTIFIED THE PROPERTY INFORMATION AND IMAGES.

PROPERTY FLOORPLAN

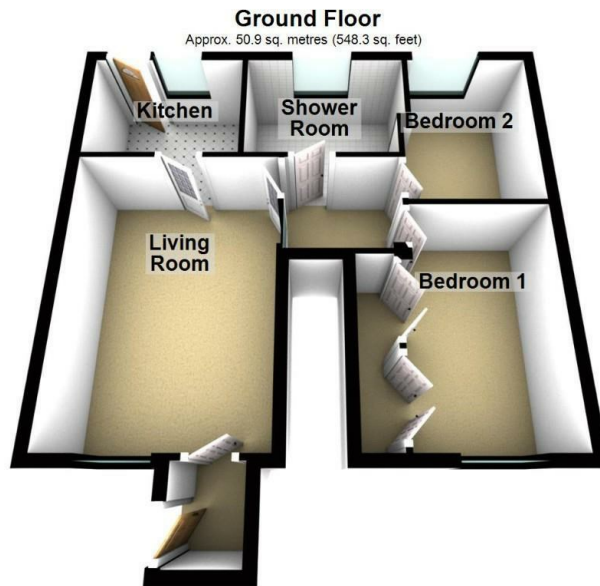

Total area: approx. 50.9 sq. metres (548.3 sq. feet)
 Please be advised the floorplans are not drawn to scale and are to be used to give an idea of the layout of the property.
 Plan produced using PlanUp.

Measurements:

Living Room
 15'9" x 10'11"

Kitchen
 8'8" x 6'5"

Bedroom One
 12'11" x 8'0"

Bedroom Two
 9'5" x 7'5"

Shower Room
 8'11" x 6'5"

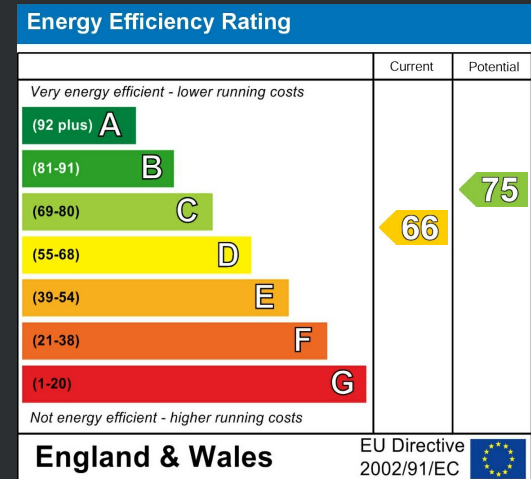





More 5 Star Customer Reviews than any other Agent based in the North East on allAgents.co.uk



SALES

LETTINGS

FINANCE

LAW

WE COVER THE WHOLE OF THE NORTH EAST

Whitley Bay
0191 251 3344

Cramlington
01670 897 213

Tynemouth
0191 296 6689

Morpeth
01670 513 966

Ponteland
01661 820 082

Wallsend
0191 432 4151

Alnwick
01665 511 800

Heaton
0191 432 4275

Forest Hall
0191 266 9966

Other locations
0191 640 3523

Newcastle
0191 640 2284

Durham
0191 303 8252

Gosforth
0191 640 3523

Sunderland
0191 543 6390

Whickham
0191 432 5102

Gateshead
0191 432 4294

Jesmond
0191 281 1037

Killingworth
0191 640 3602

Ryton
0191 413 9845

Head Office &
Lettings
0191 253 4815

*Highest recommended 5-star reviews than any other Estate Agent based in the North East on allAgents.co.uk - The UK's Largest Customer Review Website for the Property Industry & Awarded Best Estate Agency 2018 & 2019 - North East England by SME News