

SIGNATURE

NORTH EAST

OFFICIALLY RATED THE NO.1 ESTATE AGENT IN THE NORTH EAST





📍 Pudding Chare, Newcastle Upon Tyne NE1 1UD

Pudding Chare, Newcastle Upon Tyne NE1 1UD

Offers Over £130,000

Signature North East proudly presents this two-bedroom apartment nestled on Pudding Chare in the highly sought-after Newcastle upon Tyne city centre. This tastefully decorated property boasts a prime location, surrounded by an array of convenient amenities, including top-notch restaurants, vibrant bars, and a diverse range of shops. Additionally, it offers excellent transportation connections, with both Central station and the metro just a quick three-minute walk away. This property is an ideal investment opportunity for buy-to-let investors.

Upon entering the apartment, you'll be greeted by a welcoming and generously proportioned sitting room that can easily accommodate your preferred furnishings. From here, a central hallway leads you to the kitchen, two bedrooms, and a bathroom. The kitchen, updated in 2019, is fully equipped with wall and base units, providing optimal storage and functionality.

The bedrooms are well-appointed, offering ample space for double beds and any additional furnishings you desire. The master bedroom comes complete with an En suite bathroom, featuring a shower, WC, and hand basin for added convenience. The main bathroom is generously sized and features a bathtub, an overhead shower, WC, and hand basin.

Externally, you'll discover a shared decked area adorned with raised flower beds and shrubbery, providing a touch of greenery.



PLEASE NOTE THAT THE VENDOR HAS CERTIFIED THE PROPERTY INFORMATION AND IMAGES.

PROPERTY FLOORPLAN

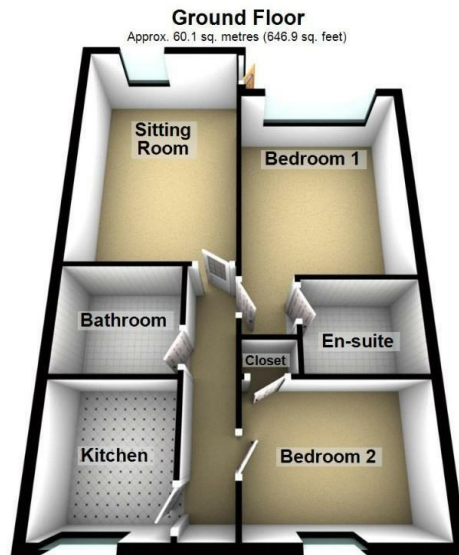

Total area: approx. 60.1 sq. metres (646.9 sq. feet)
 Please be advised the floorplans are not drawn to scale and are to be used to give an idea of the layout of the property.
 Plan produced using PlanUp.

Measurements:

Sitting Room
 16'4" x 10'7"

Kitchen
 8'2" x 7'3"

Bedroom 1
 19'5" x 10'7"

En Suite
 5'8" x 7'1"

Bedroom 2
 8'2" x 10'7"

Bathroom
 6'6" x 7'3"

Energy Efficiency Rating

	Current	Potential
Very energy efficient - lower running costs		
(92 plus) A		
(81-91) B		75
(69-80) C		
(55-68) D	58	
(39-54) E		
(21-38) F		
(1-20) G		
Not energy efficient - higher running costs		
England & Wales		EU Directive 2002/91/EC 





More 5 Star Customer Reviews than any other Agent based in the North East on allAgents.co.uk



SALES

LETTINGS

FINANCE

LAW

WE COVER THE WHOLE OF THE NORTH EAST

Whitley Bay
0191 251 3344

Cramlington
01670 897 213

Tynemouth
0191 296 6689

Morpeth
01670 513 966

Ponteland
01661 820 082

Wallsend
0191 432 4151

Alnwick
01665 511 800

Heaton
0191 432 4275

Forest Hall
0191 266 9966

Other locations
0191 640 3523

Newcastle
0191 640 2284

Durham
0191 303 8252

Gosforth
0191 640 3523

Sunderland
0191 543 6390

Whickham
0191 432 5102

Gateshead
0191 432 4294

Jesmond
0191 281 1037

Killingworth
0191 640 3602

Ryton
0191 413 9845

Head Office &
Lettings
0191 253 4815

*Highest recommended 5-star reviews than any other Estate Agent based in the North East on allAgents.co.uk - The UK's Largest Customer Review Website for the Property Industry & Awarded Best Estate Agency 2018 & 2019 - North East England by SME News