

SIGNATURE

NORTH EAST

OFFICIALLY RATED THE NO.1 ESTATE AGENT IN THE NORTH EAST





📍 Thorntree Drive, West Monkseaton NE25 9NN

Thorntree Drive, West Monkseaton NE25 9NN

Offers Over £379,950

Signature North East is thrilled to introduce this exquisite semi-detached home situated on Thorntree Drive in the sought-after area of Whitley Bay. This property boasts a spacious and modern design, nestled conveniently close to a wealth of amenities. From shops and eateries to strong road and transport links, including the West Monkseaton metro station just a short stroll away. Families will appreciate the nearby highly regarded schools, and the allure of Whitley Bay beach is only a brief distance away.

Upon entering the home, you'll be greeted by an inviting entrance porch that leads into a spacious hallway. From here, you'll have access to the ground floor's principal rooms and the staircase that leads to the first floor. The first room you'll encounter is the living room, offering ample space for your desired furnishings. Its large bay window bathes the room in natural light, creating a bright and inviting atmosphere. Adjacent to the living room, you'll find the dining room and kitchen, seamlessly connected by an archway to create an open-plan feel. The kitchen is both stylish and functional, providing ample storage space through sleek wall and base units. It is complemented by a range of integrated appliances, including a fridge/freezer, dishwasher, oven and hob. The dining room offers a versatile space, perfect for accommodating a family dining table and additional furnishings. Adding to the ambiance, a cozy log burner creates a warm and welcoming atmosphere. This open space features two sets of French doors that lead out to the rear of the property.

Ascending to the first floor, you'll discover four generously sized bedrooms. The master bedroom boasts built-in wardrobes with sliding doors, providing ample storage space. The first floor also accommodates two bathrooms. The main family bathroom features a bathtub, w.c., and sink, while the second bathroom is equipped with a walk-in shower, w.c., and sink.

Externally, the property offers a generously sized garden space at the rear, complete with a raised decking area ideal for alfresco dining. The front of the property showcases a block-paved driveway and garage, providing convenient off-street parking for multiple vehicles.



PLEASE NOTE THAT THE VENDOR HAS CERTIFIED THE PROPERTY INFORMATION AND IMAGES.

PROPERTY FLOORPLAN

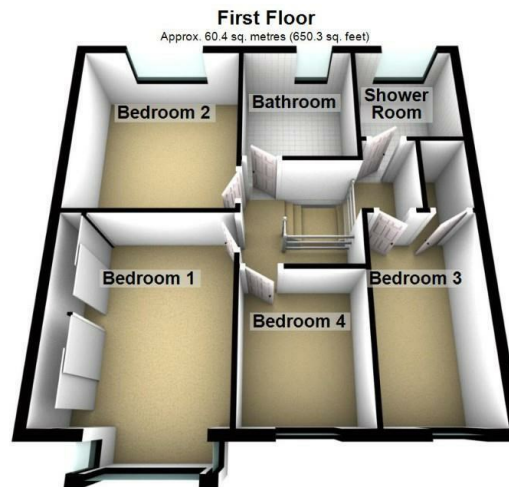
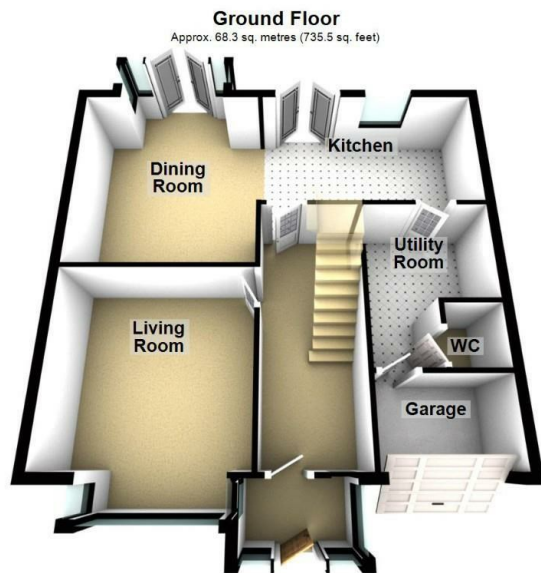

Total area: approx. 128.7 sq. metres (1385.8 sq. feet)

Please be advised the floorplans are not drawn to scale and are to be used to give an idea of the layout of the property.
Plan produced using PlanUp.

Measurements:

Living room
11'11" x 12'0"

Dining room
12'9" x 12'0"

Kitchen
8'4" x 14'6"

Bedroom 1
10'10" x 12'7"

Bedroom 2
10'10" x 12'2"

Bedroom 3
6'8" x 12'7"

Bedroom 4
7'6" x 8'11"

Bathroom
7'4" x 8'3"

Shower room
6'4" x 6'10"

Utility room
7'11" x 10'8"

Energy Efficiency Rating

	Current	Potential
Very energy efficient - lower running costs		
(92 plus) A		
(81-91) B		82
(69-80) C	70	
(55-68) D		
(39-54) E		
(21-38) F		
(1-20) G		
Not energy efficient - higher running costs		
England & Wales	EU Directive 2002/91/EC 	





More 5 Star Customer Reviews than any other Agent based in the North East on allAgents.co.uk



SALES

LETTINGS

FINANCE

LAW

WE COVER THE WHOLE OF THE NORTH EAST

Whitley Bay
0191 251 3344

Cramlington
01670 897 213

Tynemouth
0191 296 6689

Morpeth
01670 513 966

Ponteland
01661 820 082

Wallsend
0191 432 4151

Alnwick
01665 511 800

Heaton
0191 432 4275

Forest Hall
0191 266 9966

Other locations
0191 640 3523

Newcastle
0191 640 2284

Durham
0191 303 8252

Gosforth
0191 640 3523

Sunderland
0191 543 6390

Whickham
0191 432 5102

Gateshead
0191 432 4294

Jesmond
0191 281 1037

Killingworth
0191 640 3602

Ryton
0191 413 9845

Head Office &
Lettings
0191 253 4815

*Highest recommended 5-star reviews than any other Estate Agent based in the North East on allAgents.co.uk - The UK's Largest Customer Review Website for the Property Industry & Awarded Best Estate Agency 2018 & 2019 - North East England by SME News