

SIGNATURE

NORTH EAST

OFFICIALLY RATED THE NO.1 ESTATE AGENT IN THE NORTH EAST





Hartford Road East, Bedlington NE22 6HZ

Hartford Road East, Bedlington NE22 6HZ

Offers In Excess Of £299,950

Signature North East Welcomes you to Hartford Road East, this magnificent 5-bedroom detached house offers spacious living areas, a beautifully landscaped back garden, and an excellent location, making it the perfect place to call home. Residents of this charming 5-bedroom detached house in Bedlington will enjoy a convenient lifestyle with a wide array of local amenities within easy reach, including schools, parks, shops, and recreational facilities, ensuring everything you need is just a stone's throw away.

As you step inside, a brief porch provides convenient storage for your outdoor necessities. The hallway grants access to the living room, sitting room, and dining room, creating a warm and inviting atmosphere. The living room is a haven of comfort, with ample space, bright décor, and ambient natural lighting. Admire the stunning fireplace and enjoy the magnificent window that fills the room with natural light. Moving through to the sitting room, this beautiful space features a fireplace and offers a generous area to relax and unwind. Hosting gatherings is a breeze in the dining room, where a large dining table fits comfortably. Cabinets provide additional storage, ensuring everything you need is within reach. The kitchen showcases wooden units, offering plenty of storage space. Additionally, the kitchen provides access to the back door and a convenient w.c.

On the first floor, the master bedroom offers room for a double bed and additional desired furnishings, providing a serene sanctuary. Bedroom two contains ample space and can accommodate a double bed as well as featuring a built-in wardrobe unit. The abundance of natural light adds to its charm. Bedroom three Boasts lots of natural light, this room can comfortably accommodate a single bed, making it a cosy retreat. The bathroom features a bath and an open shower room with a floor drain, offering a modern and cramp-free environment for relaxation. Bedroom four showcases a cosy and warm atmosphere, this bedroom is an ideal guest room, perfect for welcoming visitors. Bedroom five is a versatile space and can be used as a guest room, study, dressing room, or nursery, offering flexibility to suit your needs. It comfortably fits a single bed.

The property boasts a gated driveway, providing secure parking and access to the garage. The front yard enhances the curb appeal, welcoming you home with style. The landscaped back garden offers ample space for garden furniture on the paved patio, creating a perfect spot for entertaining guests and making cherished memories. The low-maintenance lawn allows you to relax and enjoy the summer days in various seating areas.

PLEASE NOTE THAT THE VENDOR HAS CERTIFIED THE PROPERTY INFORMATION AND IMAGES.



PROPERTY FLOORPLAN

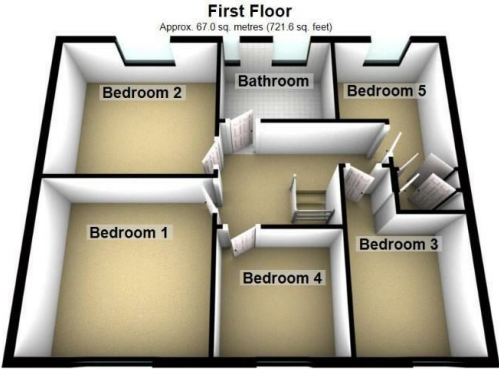
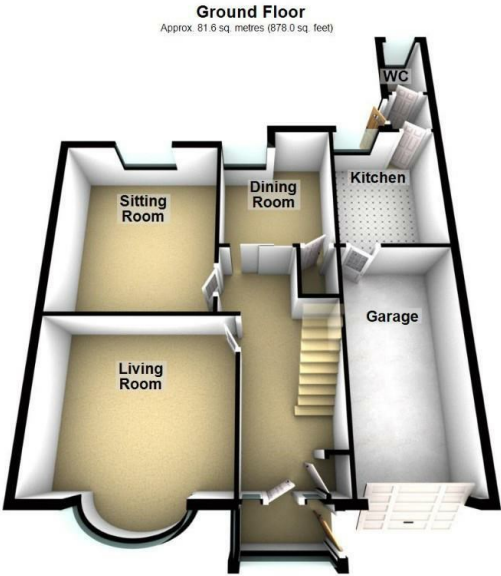

Total area: approx. 148.6 sq. metres (1599.6 sq. feet)
Please be advised the floorplans are not drawn to scale and are to be used to give an idea of the layout of the property.
Plan produced using PlanUp.

Measurements:

Living Room
14'1" x 13'10"

Sitting Room
14'0" x 12'2"

Dining Room
10'2" x 8'10"

Kitchen
10'2" x 8'4"

WC
5'6" x 3'4"

Bedroom One
12'4" x 12'2"

Bedroom Two
12'2" x 11'4"

Bedroom Three
13'0" x 8'4"

Bedroom Four
8'11" x 8'5"

Bedroom Five
12'5" x 8'4"

Bathroom
8'8" x 6'10"

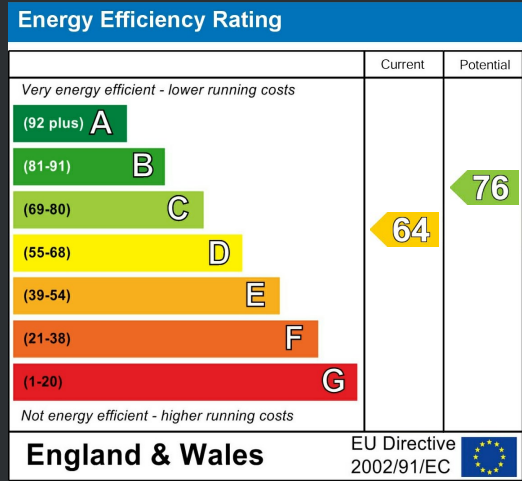





More 5 Star Customer Reviews than any other Agent based in the North East on allAgents.co.uk



SALES

LETTINGS

FINANCE

LAW

WE COVER THE WHOLE OF THE NORTH EAST

Whitley Bay
0191 251 3344

Cramlington
01670 897 213

Tynemouth
0191 296 6689

Morpeth
01670 513 966

Ponteland
01661 820 082

Wallsend
0191 432 4151

Alnwick
01665 511 800

Heaton
0191 432 4275

Forest Hall
0191 266 9966

Other locations
0191 640 3523

Newcastle
0191 640 2284

Durham
0191 303 8252

Gosforth
0191 640 3523

Sunderland
0191 543 6390

Whickham
0191 432 5102

Gateshead
0191 432 4294

Jesmond
0191 281 1037

Killingworth
0191 640 3602

Ryton
0191 413 9845

Head Office &
Lettings
0191 253 4815

*Highest recommended 5-star reviews than any other Estate Agent based in the North East on allAgents.co.uk - The UK's Largest Customer Review Website for the Property Industry & Awarded Best Estate Agency 2018 & 2019 - North East England by SME News