

SIGNATURE

NORTH EAST

OFFICIALLY RATED THE NO.1 ESTATE AGENT IN THE NORTH EAST





 Wallington Court, Newcastle Upon Tyne NE3 2YZ

Wallington Court, Newcastle Upon Tyne NE3 2YZ

Offers Over £375,000

Signature North East is delighted to present this exquisite four-bedroom detached property located on Wallington Court, in the sought-after Kensington Park, Newcastle. Meticulously renovated to an exceptional standard, this home boasts contemporary designs that adorn each generously sized room. The desirable location offers a plethora of convenient amenities, such as shops, restaurants, convenient transport links excellent road links, including effortless connectivity to the A1.

Upon entering the property, you are welcomed in by a brief entrance porch leading to the generously sized, open-concept living room, dining room, and kitchen. The living room is tastefully decorated and offers ample room for desired furnishings. The two-tone kitchen showcases sleek black and white units offering lots of storage space as well as a trendy central island. The space is well-lit with an abundance of natural light flowing through the floor-to-ceiling windows, skylights, and patio doors. Connected are the utility room offering additional storage space, and a convenient downstairs w.c. Completing the ground floor is the fourth bedroom which can accommodate a double bed and other furnishings. The room also features an open shower.

Moving upstairs there are three bedrooms. The first bedroom is the master bedroom which provides ample room for a double bed and other furnishings, as well as plenty of storage space via the fitted wardrobes. The second bedroom has an integrated wardrobe with sliding doors, boasts modern décor as well as natural light, and is capable of fitting a double bed. The third and final bedroom provides space for storage and can accommodate a single bed. This versatile space could make a great dressing room or study. The main bathroom boasts ample space and contains a shower, a floating vanity unit, and w.c.

Externally this property has so much to offer, including an amazing sheltered seating area that is perfect for sitting in the garden, whatever the weather. The rear garden not only features that spectacular seating area but also offers a spacious patio and lawn, perfect for a summer in the garden and entertaining guests. To the front of the home is an additional garden with an array of trees, shrubs, and flowers, as well as a block-paved double driveway.



PLEASE NOTE THAT THE VENDOR HAS CERTIFIED THE PROPERTY INFORMATION AND IMAGES.

PROPERTY FLOORPLAN

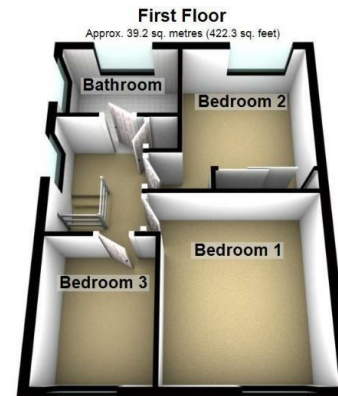
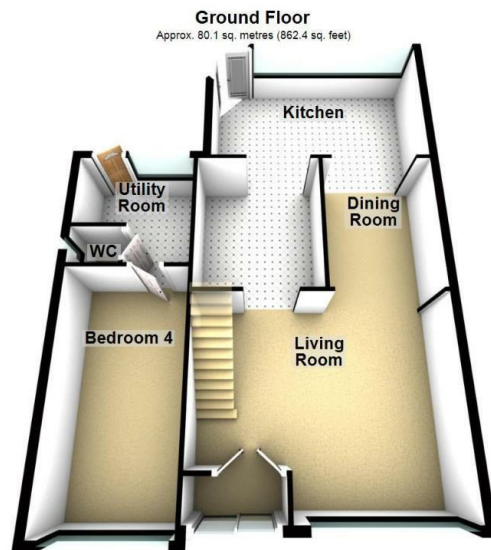

Total area: approx. 119.4 sq. metres (1284.7 sq. feet)

Please be advised the floorplans are not drawn to scale and are to be used to give an idea of the layout of the property.
Plan produced using PlanUp.

Measurements:

Living Room
17'11" x 14'7"

Dining Room
10'6" x 8'3"

Kitchen
21'1" x 16'11"

Utility Room
8'8" x 8'8"

WC
3'8" x 2'9"

Bedroom One
12'0" x 11'5"

Bedroom Two
11'5" x 11'1"

Bedroom Three
9'1" x 7'1"

Bedroom Four
17'3" x 8'0"

Bathroom
8'5" x 5'4"

Energy Efficiency Rating

	Current	Potential
Very energy efficient - lower running costs		
(92 plus) A		
(81-91) B		83
(69-80) C	70	
(55-68) D		
(39-54) E		
(21-38) F		
(1-20) G		
Not energy efficient - higher running costs		
England & Wales	EU Directive 2002/91/EC 	





More 5 Star Customer Reviews than any other Agent based in the North East on allAgents.co.uk



SALES

LETTINGS

FINANCE

LAW

WE COVER THE WHOLE OF THE NORTH EAST

Whitley Bay
0191 251 3344

Cramlington
01670 897 213

Tynemouth
0191 296 6689

Morpeth
01670 513 966

Ponteland
01661 820 082

Wallsend
0191 432 4151

Alnwick
01665 511 800

Heaton
0191 432 4275

Forest Hall
0191 266 9966

Other locations
0191 640 3523

Newcastle
0191 640 2284

Durham
0191 303 8252

Gosforth
0191 640 3523

Sunderland
0191 543 6390

Whickham
0191 432 5102

Gateshead
0191 432 4294

Jesmond
0191 281 1037

Killingworth
0191 640 3602

Ryton
0191 413 9845

Head Office &
Lettings
0191 253 4815

*Highest recommended 5-star reviews than any other Estate Agent based in the North East on allAgents.co.uk - The UK's Largest Customer Review Website for the Property Industry & Awarded Best Estate Agency 2018 & 2019 - North East England by SME News