



Bartlams

291 Aldersley Road, Wolverhampton, WV6 9NR

£275,000

****THREE-BEDROOM HOME FULLY RENOVATED TO AN OUTSTANDING LEVEL** Entrance hall with alarm panel and storage cupboard, Living Room, L-shaped kitchen/Diner with Utility room and W.C. off. Three first-floor bedrooms with a modern family bathroom. High-quality Oak Doors throughout. Double Glazing and Gas Central Heating. The driveway, garden and external render are still to be completed. Agent Note - Please note that the plot currently has a three-bedroom detached home being built - Detailed planning consent from Wolverhampton Council can be found using the following reference- (23/00808/UNKNWN or 23/00478/FUL). Freehold. Council tax band - tbc. EPC - tbc.**

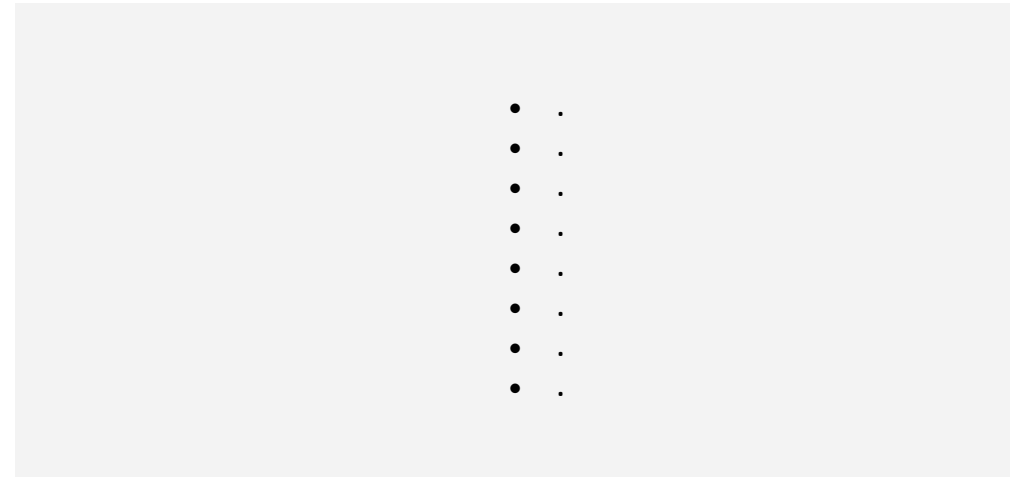

Freehold
COUNCIL TAX BAND -
EPC RATING -

NOTICE: These particulars, although believed to be correct, do not constitute any part of an offer or contract. All statements contained in these particulars as to this property are made without responsibility and are not to be relied upon as statements or representations of warranty whatsoever in relation to property. Any intending purchaser must satisfy themselves by inspection or otherwise as to the correctness each of the statements contained in these particulars. All measurements are approximate and for illustrative purposes only. Photographs are produced for general information and it must not be inferred that any item shown is included in the sale.
DISCLOSURE: As a professional Estate Agency our clients employ us to look after their best interests. This includes providing them with full details of offers made to purchase their property. To ensure our obligations to our clients are met we need to check the status of all potential purchasers. If you make an offer on this property we will ask a member of The Finance Family to contact you to verify your status. They are a leading firm of Independent Financial Advisers and Mortgage Brokers. Should they transact any business resulting from our introduction then we may receive a commission.

Bartlams

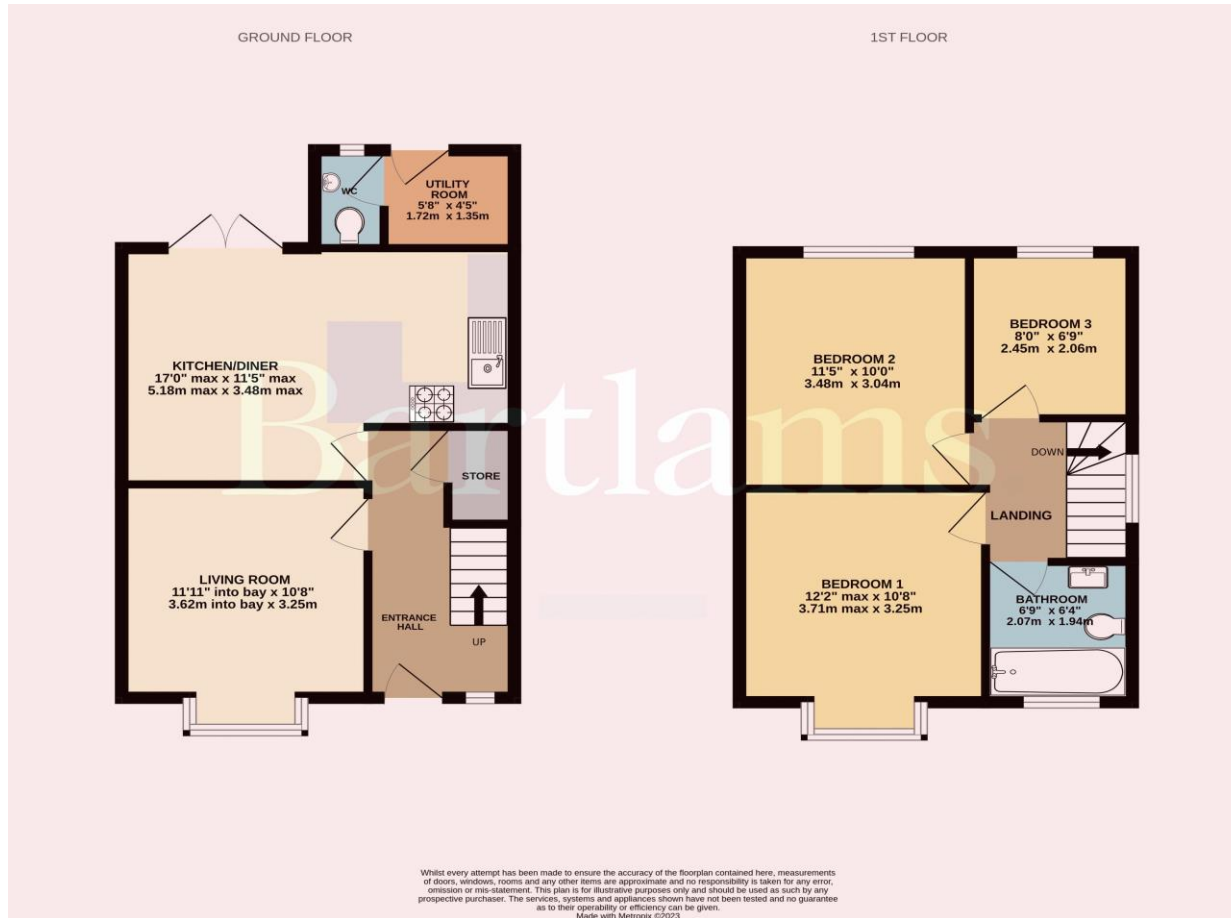

PLEASE SIGN BELOW TO AGREE THAT THE DETAILS ARE ACCURATE TO THE BEST OF YOUR KNOWLEDGE

SIGNED:

DATE:

24 High Street TETTENHALL Wolverhampton West Midlands WV6 8QT

01902 759888

tettenhallsales@bartlams.co.uk

www.bartlams.co.uk



