



Bartlams.

15 The Mews, Wolverhampton - WV6 8FA  
£120,000



## 15 The Mews

Tettenhall Wood, Wolverhampton

**\*\*OFFERED FOR SALE AT 50% SHARED OWNERSHIP\*\***

Immaculately presented a two-bedroom mews-style home in a popular location of Tettenhall Wood. Charming and characterful two-bedroom home available to purchase at 50% shared ownership with Walsall Housing Group

An ideal purchase for a first-time buyer taking their first step onto the property ladder. Viewing is highly recommended to appreciate the accommodation on offer.

The property comprises; an entrance hall with a downstairs W.C., large living area with dining space and a fitted kitchen. On the first floor are two bedrooms with fitted wardrobes to the master bedroom and a large bathroom.

Externally there is a courtyard style garden as well as an allocated parking space.



B.



#### Agent notes:

Please note this property is offered as shared ownership and may be available for 100% share subject to criteria met by the managing agent, WHG. The current rent for the 50% share is circa £325 per calendar month, including the service charge. We strongly recommend you ask your solicitor to confirm all lease details.

There are also Solar Panels attached to the property deducting from your monthly cost of utility supply. Again we recommend you ask your solicitor to confirm all Solar Panel details,

- DOUBLE GLAZING AND CENTRAL HEATING
- ALLOCATED PARKING SPACE
- 121 YEARS REMANING ON LEASE
- 100% AVAILABLE TO PURCHASE SUBJECT TO CRITERIAS MET
- MONTHLY RENT £325 PCM INCLUDING SERVICE CHARGE
- 50% SHARED OWNERSHIP
- SOLAR PANELS
- OPEN PLAN LIVING





GROUND FLOOR



1ST FLOOR

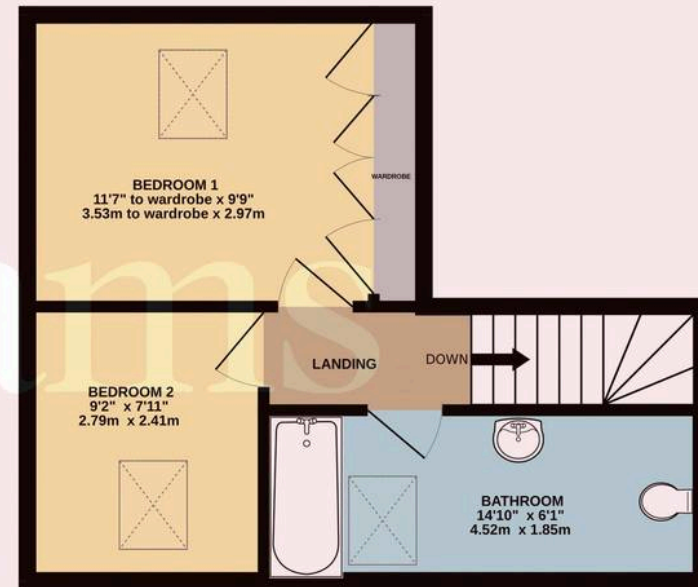

Whilst every attempt has been made to ensure the accuracy of the floorplan contained here, measurements of doors, windows, rooms and any other items are approximate and no responsibility is taken for any error, omission or mis-statement. This plan is for illustrative purposes only and should be used as such by any prospective purchaser. The services, systems and appliances shown have not been tested and no guarantee as to their operability or efficiency can be given.  
Made with Metropix ©2024

## Bartlams Tettenhall

Bartlams, 24 High Street - WV6 8QT

01902 759888

tettenhall@bartlams.co.uk

www.bartlams.co.uk/

NOTICE: These particulars, although believed to be correct, do not constitute any part of an offer or contract. All statements contained in these particulars as to this property are made without responsibility and are not to be relied upon as statements or representations of warranty whatsoever in relation to property. Any intending purchaser must satisfy themselves by inspection or otherwise as to the correctness each of the statements contained in these particulars. All measurements are approximate and for illustrative purposes only. Photographs are produced for general information and it must not be inferred that any item shown is included in the sale. DISCLOSURE: As a professional Estate Agency our clients employ us to look after their best interests. This includes providing them with full details of offers made to purchase their property. To ensure our obligations to our clients are met we need to check the status of all potential purchasers. If you make an offer on this property we will ask a member of The Finance Family to contact you to verify your status. They are a leading firm of Independent Financial Advisers and Mortgage Brokers. Should they transact any business resulting from our introduction then we may receive a commission.

