



## Brixton Hill, SW2

£300,000



• One Bedroom

• Lift

• Great Location









## ABOUT THE PROPERTY

A beautifully presented one bedroom flat set within a popular purpose built block. The property packs a real punch benefitting from a bright and airy reception room offering space for both living and dining areas and a stylish, semi open planned kitchen which is perfect for those who love to entertain. Furthermore there is an on-site porter and access to a shared communal garden.



Perfectly located within the heart of Brixton with its array of shops, bars and it's many restaurants. Fabulous transport links including Brixton Tube (Victoria Line), Overground Station and many bus links are readily available.



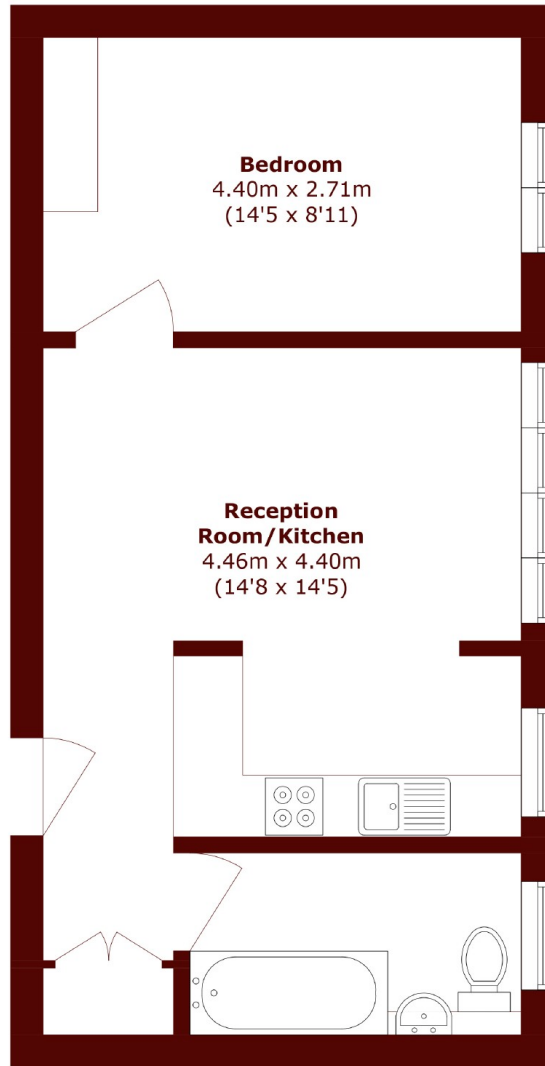

Total area (approx.): 40.4 sq. m (434.8 sq. ft)

**Marsh & Parsons Brixton**  
400-402 Coldharbour Lane,  
London, SW9 8LF  
020 7733 4595

We aim to make our particulars both accurate and reliable. However, they are not guaranteed; nor do they form part of an offer or contract. If you require clarification on any points then please contact us, especially if you're traveling some distance to view. Please note that appliances and heating systems have not been tested and therefore no warranties can be given as to their good working order.