

# Land at Cunnister

YELL, SHETLAND ISLANDS, HIGHLAND, ZE2 9DG



*SECLUDED 0.8 HECTARE SHETLAND  
LAND WITH STUNNING VIEWS*



01463 211 116



[www.mcewanfraserlegal.co.uk](http://www.mcewanfraserlegal.co.uk)



[info@mcewanfraserlegal.co.uk](mailto:info@mcewanfraserlegal.co.uk)





---

A rare opportunity to acquire approximately 0.8 hectares of land in a secluded position within Cunnister on Yell. The land, located at Map Grid Reference HU 526 966, with the remainder of the croft registered with a separate crofter. The plot offered for sale is clearly defined and under separate ownership, with no rights or claims held by others. Prospective purchasers may apply to the Crofting Commission for a 'Division of Croft,' which, if approved, would establish the land as its own croft with a unique name and registration number, granting full crofting rights and associated entitlements.

The good grazing land slopes gently down to a fence bordering croft land below and also stretches to an access road to the right. There are stunning views to the left and right of the voe, with the shore close by at approximately 100m away. Good for sea fishing. The area enjoys stunning views of the voe and surrounding countryside and is rich in wildlife. Rare birds such as the Rose Coloured Starling, King Eider, Golden Plover, and White Winged Scoter have been recorded locally, while marine life includes Killer Whales, Risso's Dolphin, and occasionally Humpback Whales. Puffins, seals, otters, and Shetland ponies are also frequently seen, making it a haven for nature enthusiasts.

The land lends itself to a variety of potential uses, such as an artist's studio, a meditation bothy or retreat, or even a birdwatching sanctuary, taking full advantage of the peace, scenery, and wildlife that surround it.

---





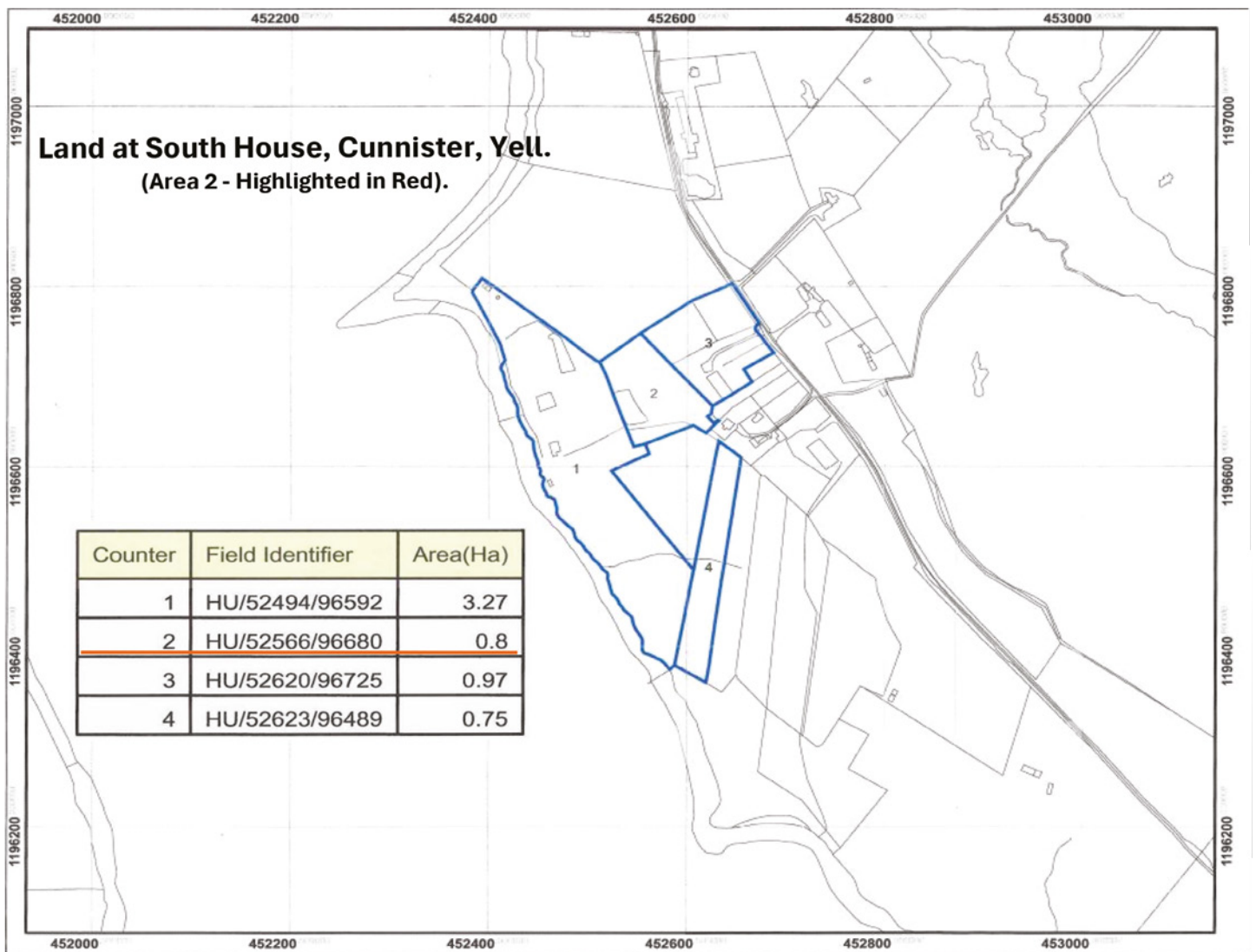

Scale 1:5,000

1 cm equals 50 Metres  
1 cm equals 55 Yards  
1 inch equals 139 Yards

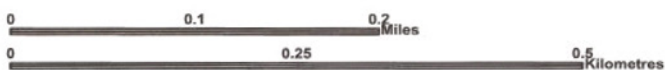

Blue Field Boundary

In order to comply with Ordnance Survey licence conditions this IACS Field map can only be used by you or your agent for official dealings with the Scottish Government. If you wish to use this map for any other purpose you are required to enter separate licensing arrangements with Ordnance Survey.



LAND REGISTER  
OF SCOTLAND

Officer's ID / Date

4225  
14/11/2014

TITLE NUMBER

**OAZ5705**



ORDNANCE SURVEY  
NATIONAL GRID REFERENCE

Scale

1/2500

HU5296 HU5297 HU59NW

Survey Scale

1/2500

OWN COPYRIGHT © - This copy has been produced from the ROS Digital Mapping System on 14/11/2014 with the authority of Ordnance Survey under Section 47 of the Copyright, Designs and Patents Act 1988. Unless there is a relevant exception to copyright, the copy must not be copied without the prior permission of the copyright owner. OS Licence no 100041182.

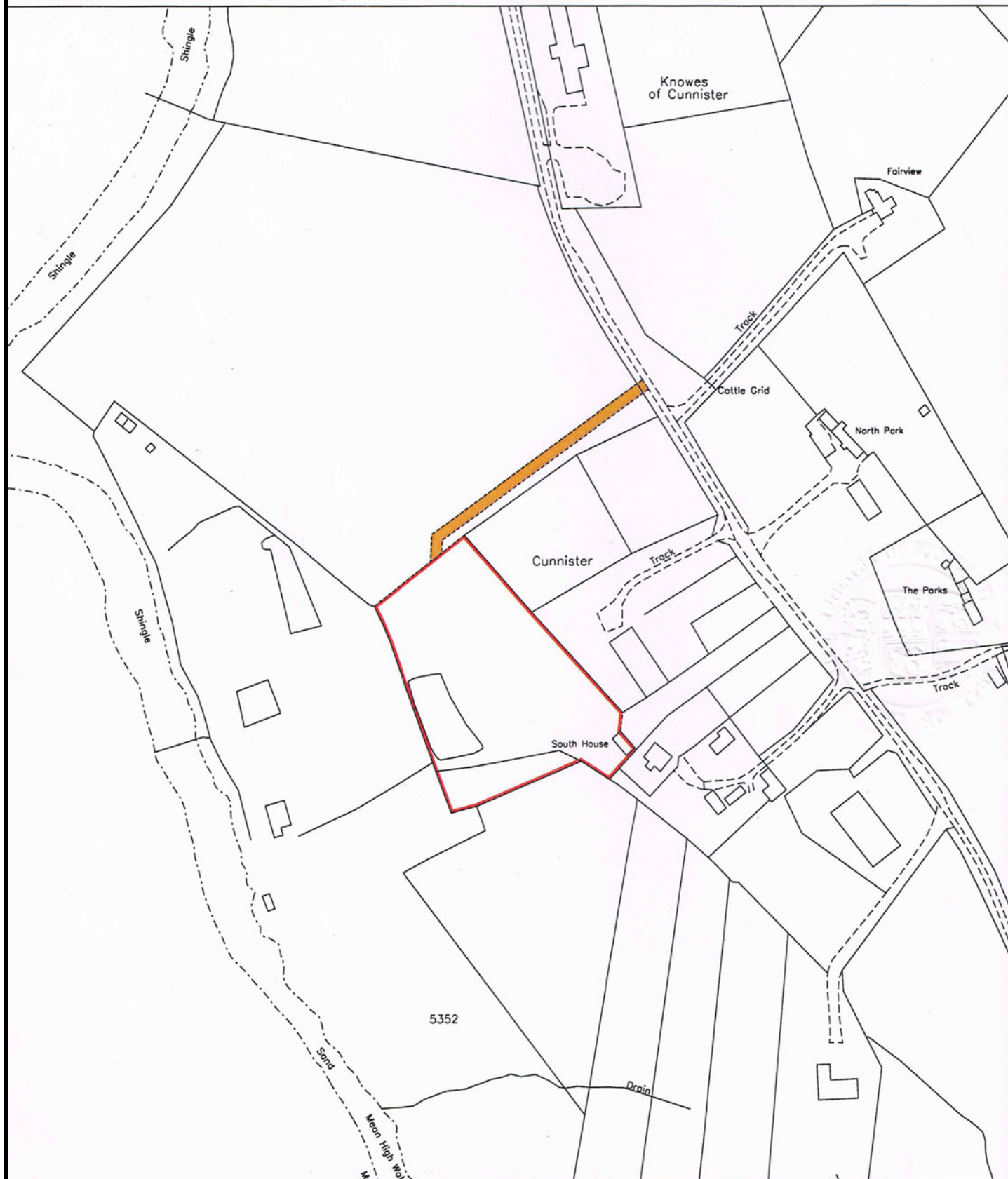



Cunnister is a tranquil area on Yell, the second-largest of the Shetland Islands. The island is celebrated for its wild, rugged landscapes, unspoilt coastline, and open moorlands, offering a distinctive northern island experience. Its shores and waters are home to abundant wildlife, including puffins, seals, otters, and the iconic Shetland ponies, providing unique opportunities for nature observation.



Despite its remote feel, Yell remains part of the United Kingdom, with easy access via local roads and ferry connections to mainland Shetland, making the island straightforward to reach without visas or border checks. The area's combination of dramatic scenery, rich wildlife, and accessibility highlights the appeal of northern Shetland for visitors and nature enthusiasts alike.

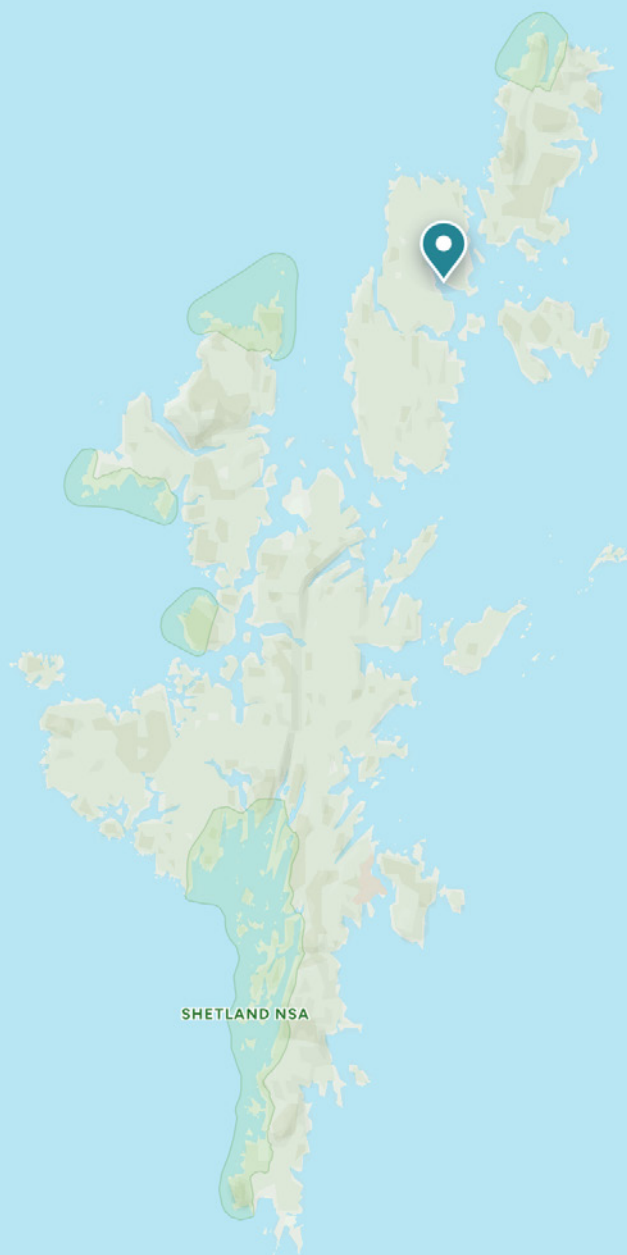

Image credit: <https://www.ordnancesurvey.co.uk/osmap/>

# McEwan Fraser Legal

Solicitors & Estate Agents

Tel. 01463 211 116

[www.mcewanfraserlegal.co.uk](http://www.mcewanfraserlegal.co.uk)

[info@mcewanfraserlegal.co.uk](mailto:info@mcewanfraserlegal.co.uk)

Part  
Exchange  
Available



Text and description  
**MARIE WOOD**  
Surveyor



Layout graphics and design  
**ALAN SUTHERLAND**  
Designer

**Disclaimer:** The copyright for all photographs, floorplans, graphics, written copy and images belongs to McEwan Fraser Legal and use by others or transfer to third parties is forbidden without our express consent in writing. Prospective purchasers are advised to have their interest noted through their solicitor as soon as possible in order that they may be informed in the event of an early closing date being set for the receipt of offers. These particulars do not form part of any offer and all statements and photographs contained herein are for illustrative purposes and are not guaranteed or warranted. Buyers must satisfy themselves for the accuracy and authenticity of the brochure and should always visit the property to satisfy themselves of the property's suitability and obtain in writing via their solicitor what's included with the property including any land. The dimensions provided may include, or exclude, recesses intrusions and fitted furniture. Any measurements provided are for guide purposes only and have been taken by electronic device at the widest point. Any reference to alterations to, or use of, any part of the property does not mean that any necessary planning, building regulations or other consent has been obtained. A buyer must find out by inspection or in other ways that all information is correct. None of the appliances/services stated or shown in this brochure have been tested by ourselves and none are warranted by our seller or MFL.