

# 5/2 Brighton Place

PORTOBELLO, EDINBURGH, EH15 1LH



*Spacious Two-Bedroom First-Floor Flat In Portobello*



0131 524 9797



[www.mcewanfraserlegal.co.uk](http://www.mcewanfraserlegal.co.uk)



[info@mcewanfraserlegal.co.uk](mailto:info@mcewanfraserlegal.co.uk)



McEwan Fraser Legal is delighted to present this spacious two-bedroom first-floor flat in Edinburgh's population area of Portobello.

# THE LIVING ROOM



Inside, the property comprises a spacious living area which overlooks Portobello High Street and is generously proportioned, creating a space that is versatile for various configurations of furniture.



# THE KITCHEN



The fully equipped kitchen with dining area includes a gas hob, fan oven, integrated dishwasher and freestanding washing machine. The space is very accommodating and offers ample space for dining furniture.



# THE DINING ROOM







There are two bedrooms, one of which is a large double and a smaller bedroom, but still a double bedroom adjacent to the kitchen, which too would make an excellent home working space. The property boasts one large four-piece bathroom, which is in excellent condition and neutrally decorated. The shower is a mains pressure shower and, much like the rest of the property, is well proportioned.

## THE BATHROOM



# BEDROOM 1



# BEDROOM 2





The property includes gas central heating and double-glazed windows, making for a cosy and cost-effective home, year-round, as well as on-street parking in the local area.

# EXTERNALS & VIEW





# FLOOR PLAN, DIMENSIONS & MAP

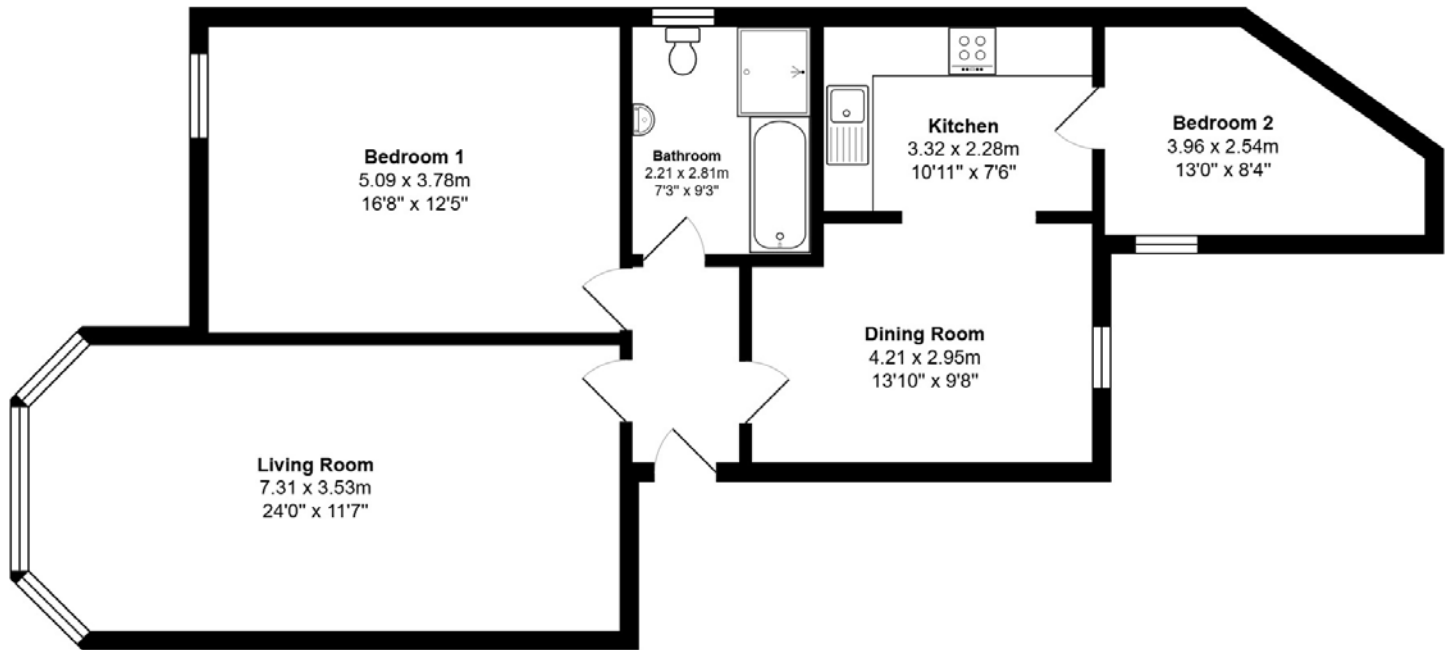

Approximate Dimensions (Taken from the widest point)

Gross internal floor area (m<sup>2</sup>): 81m<sup>2</sup> | EPC Rating: D

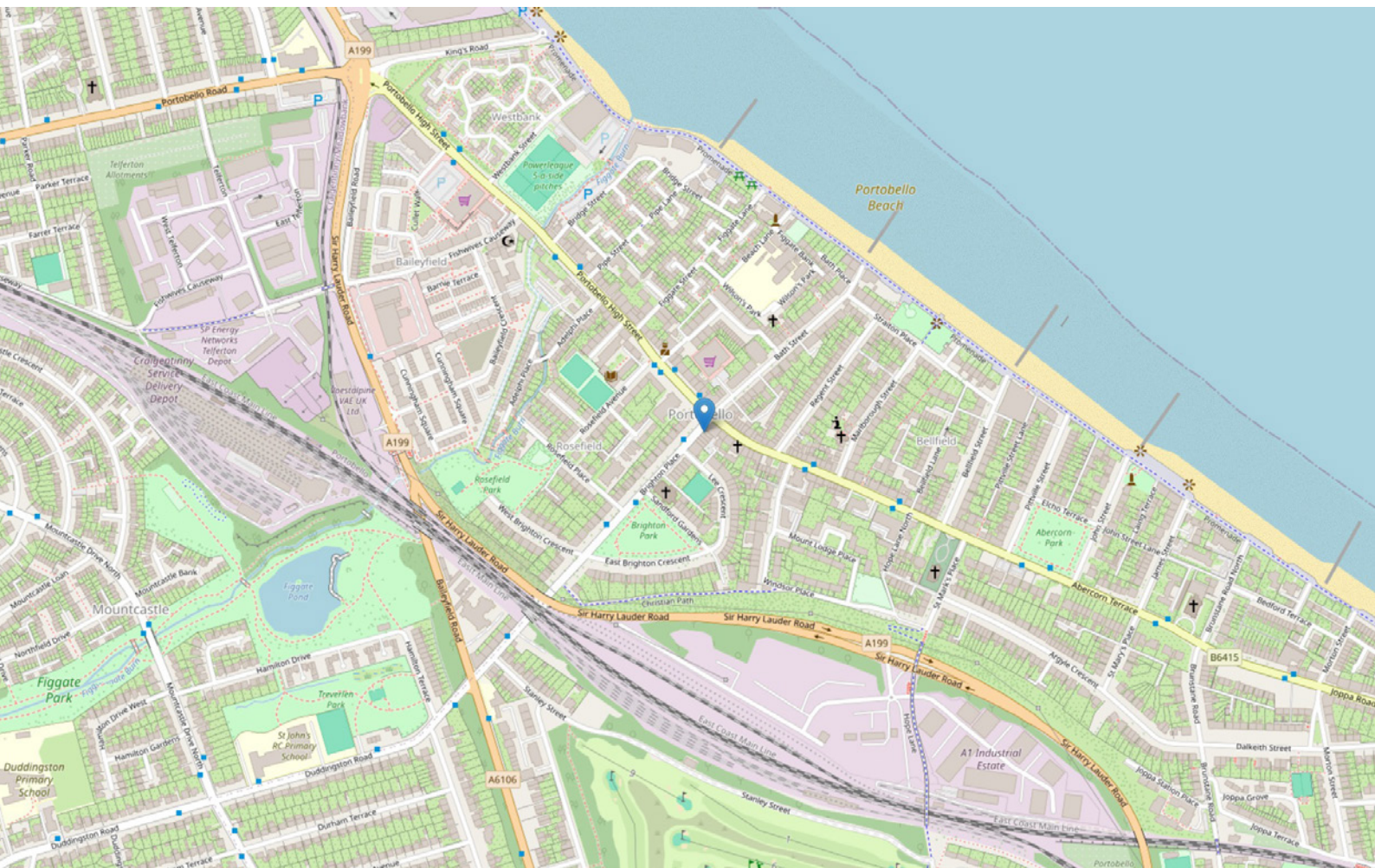



# THE LOCATION

Portobello is a very popular destination located to the East of Edinburgh's city centre. In the High Street area itself, there is an abundance of shopping facilities serving everyday and monthly requirements, so there is little need to venture from the area. For those who feel their needs are greater, there is an Asda supermarket located just a short drive from the property.







In the vicinity, there are also a number of recreational facilities, including many delightful walks along the promenade and beach, and there are many fine golf courses in the area. On the promenade for eating or coffee, there is The Beach House, The Espy, The Tide and to the east, the Dalriada. On the High Street in Portobello, there are wine shops, pubs, and for eating or carry-out, there are Chinese and Indian as well as fish and chips shops and other takeaways. There is a local indoor swimming pool and fitness suite for those who like to keep fit. For sporty individuals, there are also local artificial football pitches and a sailing and rowing club.

Local schooling at both primary and secondary levels can also be found in close proximity to this property.

There is a regular bus service virtually on your doorstep that will take you west, heading towards Edinburgh city centre, or east via the nearby area of Joppa, on to Musselburgh and beyond.



**McEwan Fraser Legal**

Solicitors & Estate Agents

Tel. 0131 524 9797

[www.mcewanfraserlegal.co.uk](http://www.mcewanfraserlegal.co.uk)

[info@mcewanfraserlegal.co.uk](mailto:info@mcewanfraserlegal.co.uk)

Part  
Exchange  
Available



Text and description  
**BEN STEWART CLARK**  
Area Sales Manager



Professional photography  
**MARK BRYCE**  
Photographer



Layout graphics and design  
**ALLY CLARK**  
Designer

**Disclaimer:** The copyright for all photographs, floorplans, graphics, written copy and images belongs to McEwan Fraser Legal and use by others or transfer to third parties is forbidden without our express consent in writing. Prospective purchasers are advised to have their interest noted through their solicitor as soon as possible in order that they may be informed in the event of an early closing date being set for the receipt of offers. These particulars do not form part of any offer and all statements and photographs contained herein are for illustrative purposes and are not guaranteed or warranted. Buyers must satisfy themselves for the accuracy and authenticity of the brochure and should always visit the property to satisfy themselves of the property's suitability and obtain in writing via their solicitor what's included with the property including any land. The dimensions provided may include, or exclude, recesses intrusions and fitted furniture. Any measurements provided are for guide purposes only and have been taken by electronic device at the widest point. Any reference to alterations to, or use of, any part of the property does not mean that any necessary planning, building regulations or other consent has been obtained. A buyer must find out by inspection or in other ways that all information is correct. None of the appliances/services stated or shown in this brochure have been tested by ourselves and none are warranted by our seller or MFL.