





- Great Location
- Three Bedrooms
- Modern Decor
- Freehold
- Viewing Recommended
- Mid Terraced Home
- Open Plan
- Short Commute to Beach
- Council Tax Band \*B\*
- Call For More Information





**\*\* Video Tour on our YouTube Channel | <https://youtu.be/VEBqC6O91sM> \*\***

This well presented, three-bedroom, mid terraced home is located on the popular Queen Alexandra Road, North Shields.

Internally the ground floor comprises: - The entrance hallway which leads directly to the open plan kitchen / dining room. The kitchen is fitted with shaker-style units with a central island. The kitchen comes with integrated features including oven, hob, dishwasher, washing machine and tumble dryer. Large French doors provide access to the rear yard. There is a bright and airy front lounge with a bay window and feature fireplace.

To the first floor: - There are three good-sized bedrooms alongside a modern, tiled shower room / w.c. with integrated under-sink storage.

The whole property further benefits from gas central heating and double-glazed windows.

Externally there is a town garden to the front and a generous, easy to maintain paved yard to the rear with outhouse storage.



The property's fantastic central location provides access to a variety of fabulous local amenities. Including cafes, bars, and restaurants all within walking distance. Long Sands Beach and King Edwards Bay are only a short 5-minute drive away. The local metro services are around a 10-minute walk and the A1058 Coast Road is close by, so you have a direct route to Newcastle City Centre. For the growing family, the property is well positioned for access to very well-regarded schools.

For more information and to book a viewing please call our Tynemouth branch on 0191 257 2000.

#### Tenure

The agent understands the property to be freehold. However, this should be confirmed with a licenced legal representative.

Council Tax band \*B\*.

**Ground Floor**

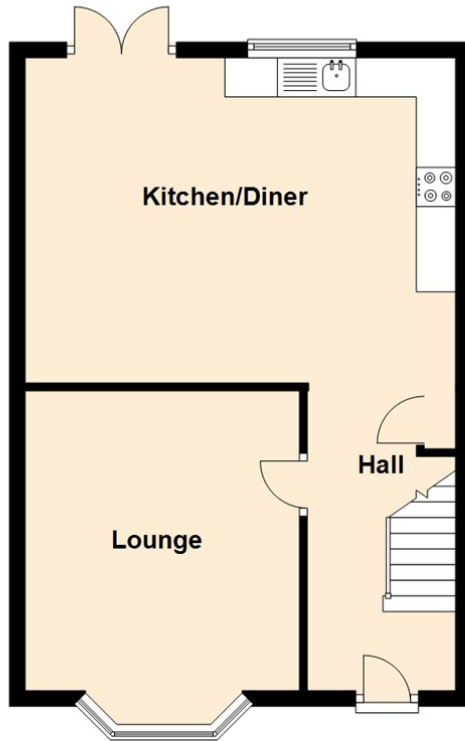

**First Floor**

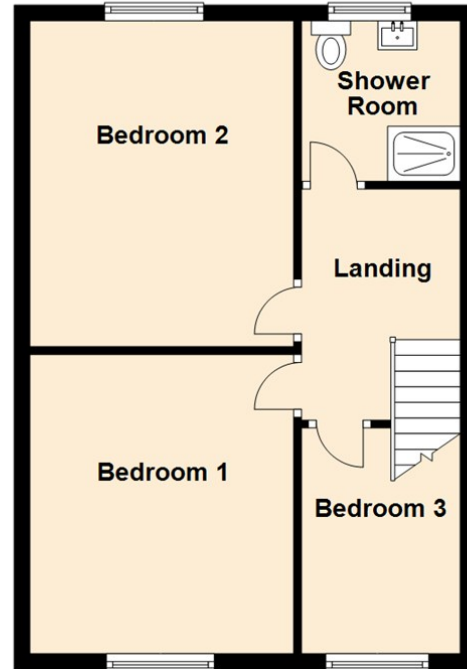

Lounge 11'5" x 12'0" (3.50 x 3.67)

Dining Kitchen 13'8" x 18'3" (4.17 x 5.57)

Bedroom One 11'0" x 13'9" (3.37 x 4.20)

Bedroom Two 11'0" x 13'9" (3.37 x 4.20)

Bedroom Three 9'4" x 6'9" (2.86 x 2.08)

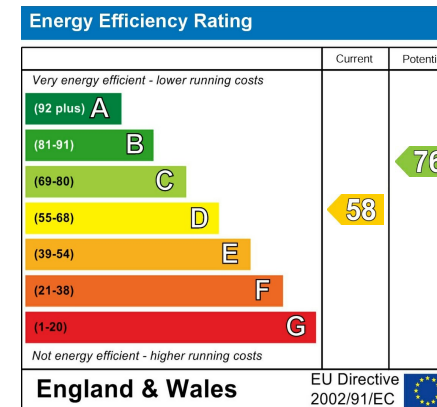

## The difference between house and home

You may download, store and use the material for your own personal use and research. You may not republish, retransmit, redistribute or otherwise make the material available to any party or make the same available on any website, online service or bulletin board of your own or of any other party or make the same available in hard copy or in any other media without the website owner's express prior written consent. The website owner's copyright must remain on all reproductions of material taken from this website.



[www.janforsterstates.com](http://www.janforsterstates.com)

**Gosforth**

**0191 236 2070**

**Newcastle**

**0191 284 4050**

**High Heaton**

**0191 270 1122**

**Tynemouth**

**0191 257 2000**

**Low Fell**

**0191 487 0800**

**Property Management Centre**

**0191 236 2680**

