



**115 Arc House, 16 Maltby Street, Tower Bridge  
London, SE1 3GP  
£575 Per Week**



A modern 6th floor one bedroom apartment located in a popular Arc House.

The apartment benefits from a spacious kitchen/reception room, good size bedroom with a large built in wardrobe and a private balcony.

Centrally located in the heart of the fashionable and buzzing London Bridge Quarter, the development is only a short walking distance to Tower Bridges, chic bars, and gastro pubs. Residents have excellent transport links via the River Taxi, and wonderful bus and overground train network, and both London Bridge and Tower Hill Underground Stations offering a plater of transport opportunities.







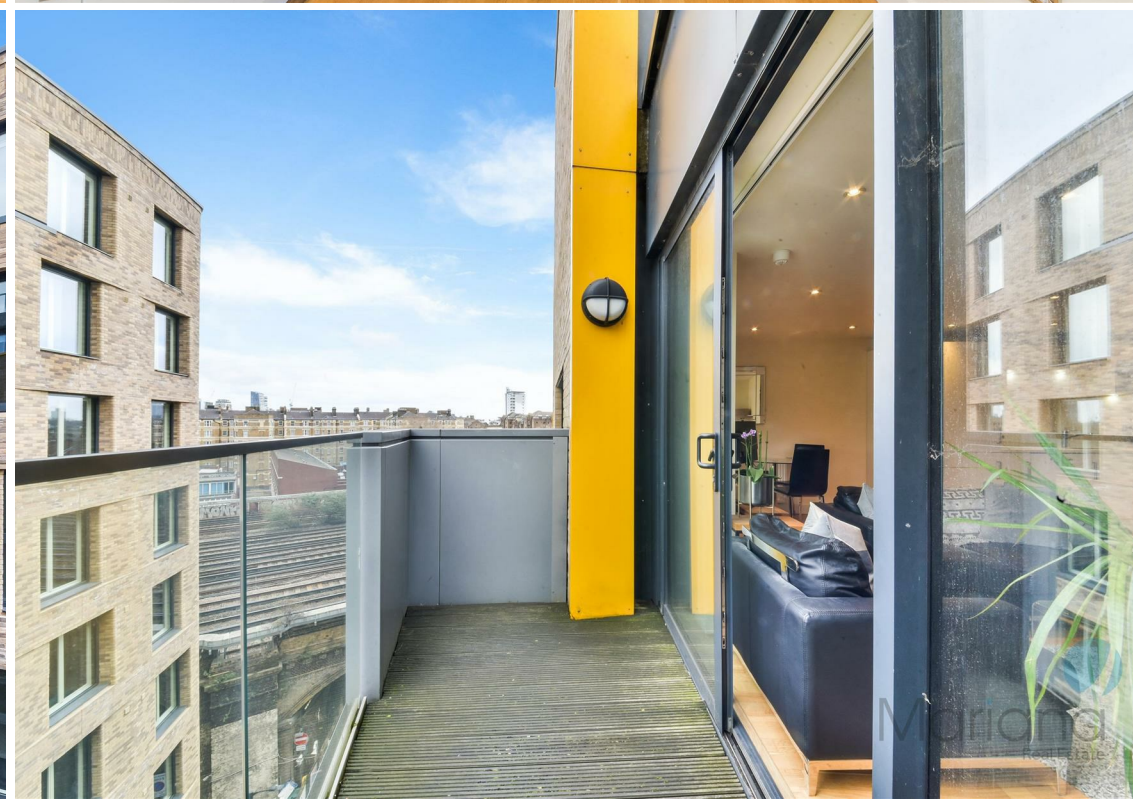





# Arc House, SE1

Approximate Gross Internal Area = 56.3 sq m / 606 sq ft

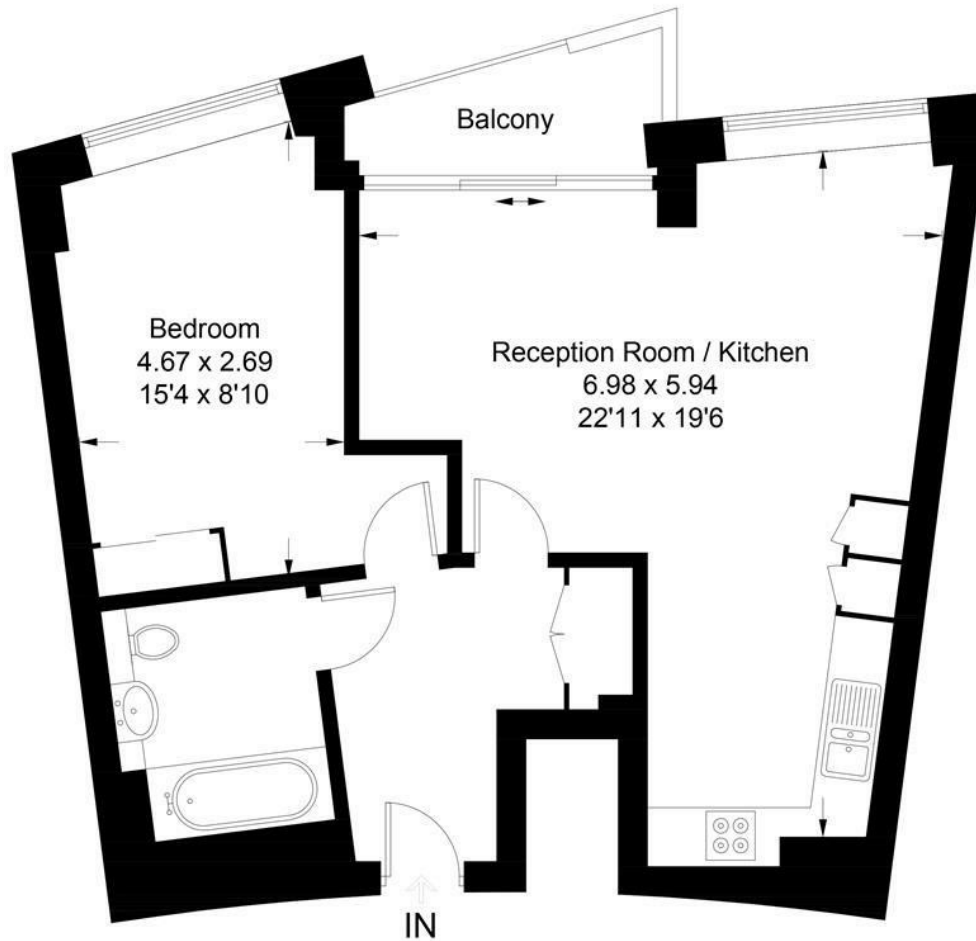

**Sixth Floor**

Illustration for identification purposes only,  
measurements are approximate, not to scale. (ID657931)

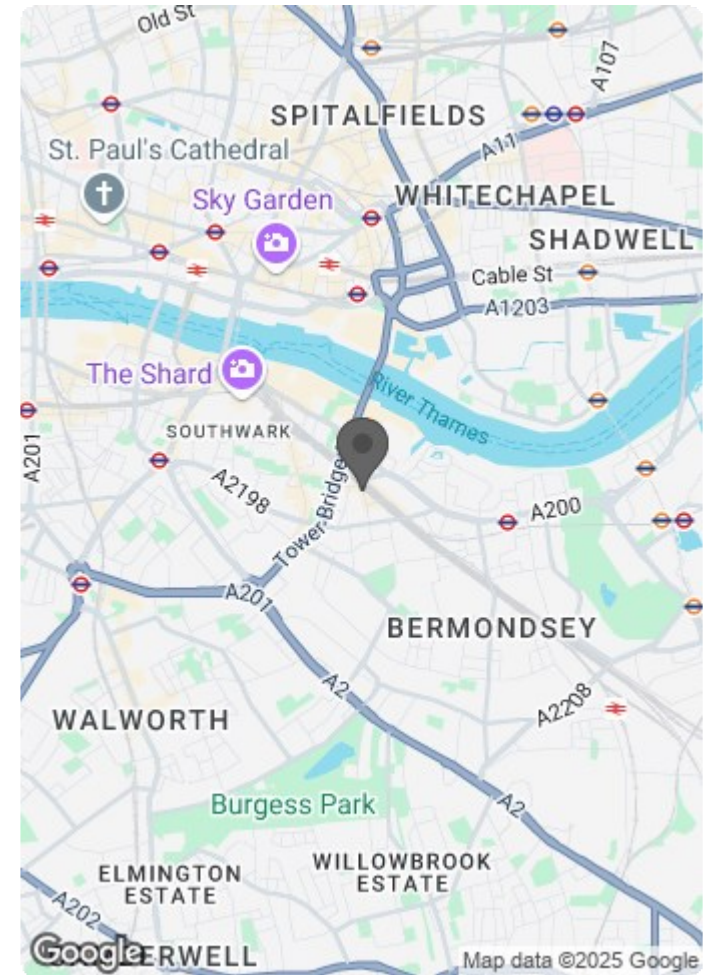

Energy Efficiency Rating		
	Current	Potential
Very energy efficient - lower running costs		
(92 plus) <b>A</b>		
(81-91) <b>B</b>	<b>84</b>	<b>84</b>
(69-80) <b>C</b>		
(55-68) <b>D</b>		
(39-54) <b>E</b>		
(21-38) <b>F</b>		
(1-20) <b>G</b>		
Not energy efficient - higher running costs		
England & Wales	EU Directive 2002/91/EC	

Environmental Impact (CO <sub>2</sub> ) Rating		
	Current	Potential
Very environmentally friendly - lower CO <sub>2</sub> emissions		
(92 plus) <b>A</b>		
(81-91) <b>B</b>		
(69-80) <b>C</b>		
(55-68) <b>D</b>		
(39-54) <b>E</b>		
(21-38) <b>F</b>		
(1-20) <b>G</b>		
Not environmentally friendly - higher CO <sub>2</sub> emissions		
England & Wales	EU Directive 2002/91/EC	