



**126 Arc House
Tower Bridge, London SE1 3GP
£2,300 Per Month**

A spacious and modern 8th floor One Bedroom apartment with a private balcony.

The apartment benefits from a large reception room with a balcony, good size bedroom with a built in wardrobe, a large bathroom and a utility room with washer/dryer.

Centrally located in the heart of the fashionable and buzzing London Bridge Quarter, the development is only a short walking distance to Tower Bridges, chic bars, and gastro pubs. Residents have excellent transport links via the River Taxi, and wonderful bus and overground train network, and both London Bridge and Tower Hill Underground Stations offering a plater of transport opportunities.







Arc House, SE1

Approximate Gross Internal Area
51.2 sq m / 551 sq ft

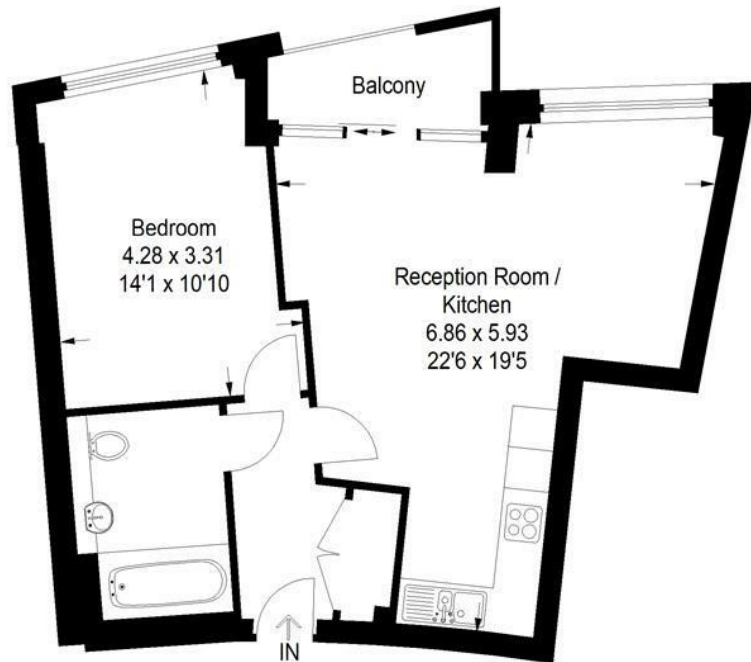

Eighth Floor

Illustration for identification purposes only,
measurements are approximate, not to scale.

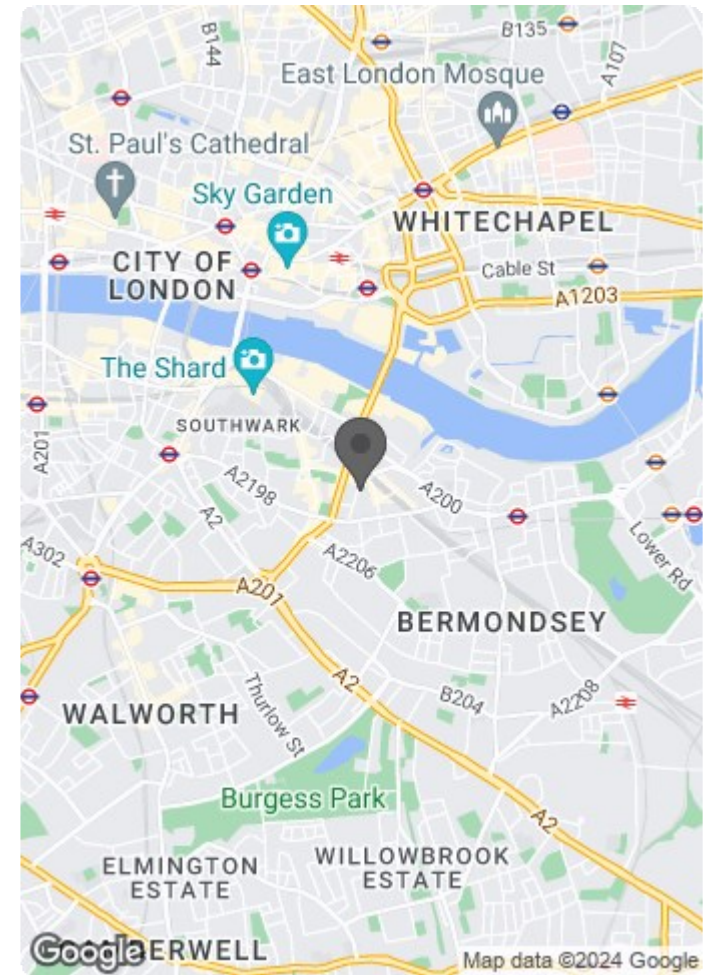

Energy Efficiency Rating		Current	Potential
Very energy efficient - lower running costs			
(92 plus) A			
(81-91) B		83	83
(69-80) C			
(55-68) D			
(39-54) E			
(21-38) F			
(1-20) G			
Not energy efficient - higher running costs			
England & Wales		EU Directive 2002/91/EC	

Environmental Impact (CO ₂) Rating		Current	Potential
Very environmentally friendly - lower CO ₂ emissions			
(92 plus) A		94	94
(81-91) B			
(69-80) C			
(55-68) D			
(39-54) E			
(21-38) F			
(1-20) G			
Not environmentally friendly - higher CO ₂ emissions			
England & Wales		EU Directive 2002/91/EC	