



Mariana
Real Estate

18 Rosler Building
London Bridge, London SE1 0FT
£575 Per Week

This South/East facing, modern one bedroom corner aspect apartment, is situated on the 4th floor of a boutique development located within the heart of the London Bridge quarter.

This sleek and bright apartment has direct views over Union Street & benefits from a spacious private balcony, under floor heating throughout, and stylish, fully equipped kitchen with wine cooler, and sumptuous bathroom with rainfall shower and heated wall.

This chic apartment building built by the renowned developer, Mount Anvil, also benefits from a day time concierge service, video entry phone system, and double aspect residents entrance.

Rosler Building is a shimmering and contemporary designed building, just moments away from Bankside, The Tate Modern, Hays Galleria, More London, and London's famous Southbank, and River Thames.

Residents will enjoy the close proximity to Southwark & London Bridge stations for superb transport links, & will be spoilt for choice with the vast array of bars & restaurants nearby.

Council tax - Southwark, Band E.







Rosler Building

Approximate Gross Internal Area = 48 sq m / 517 sq ft

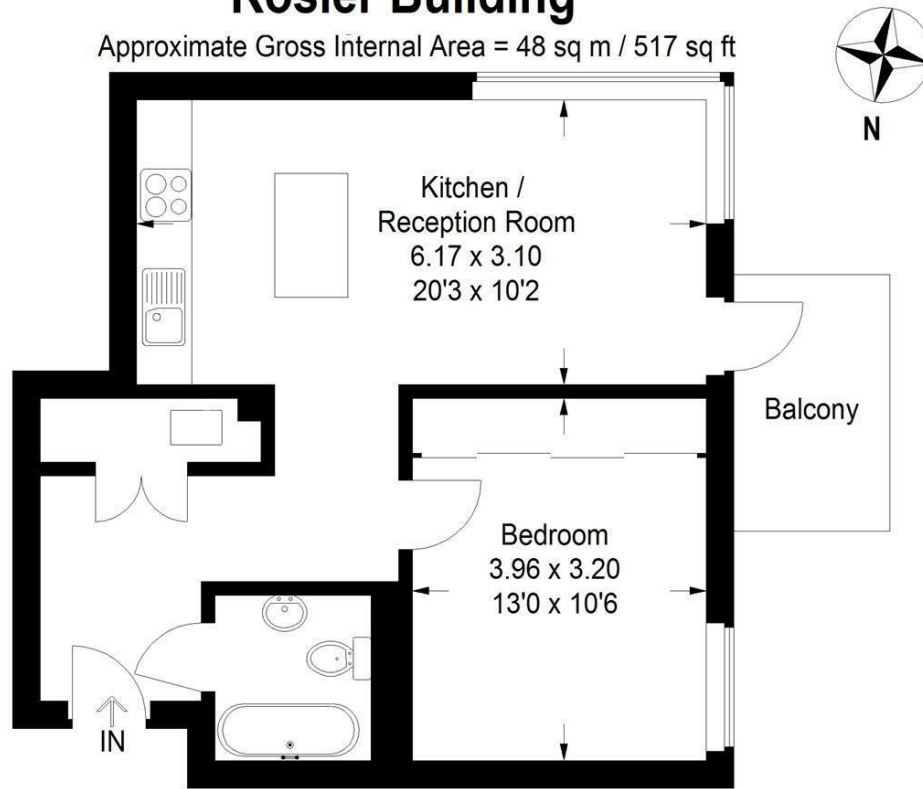
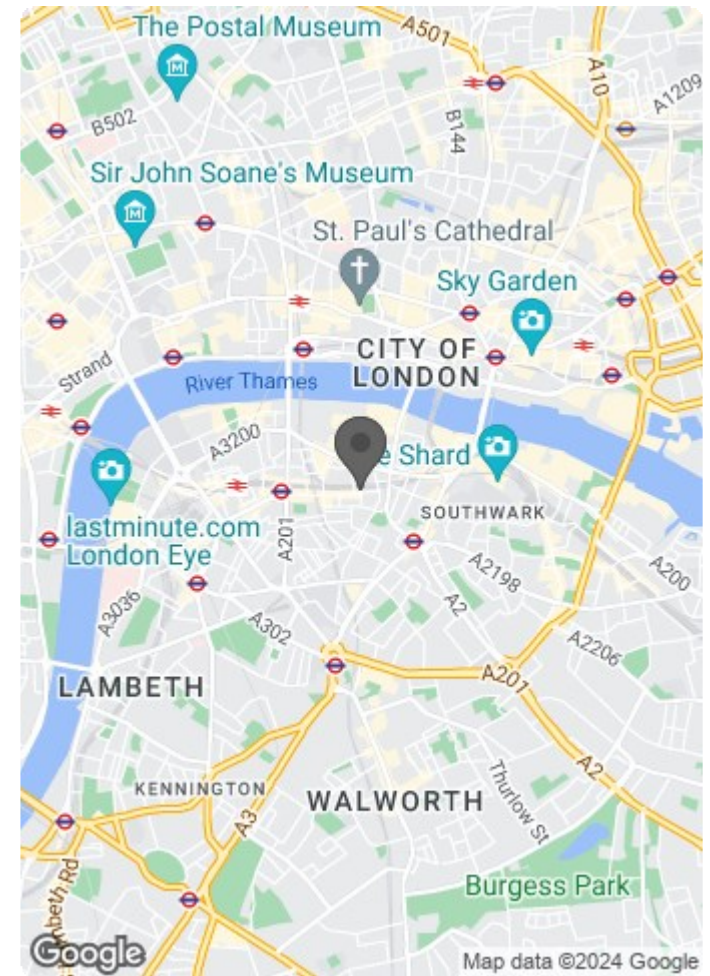

Illustration for identification purposes only, measurements are approximate, not to scale.
FloorplansUsketch.com ©



Energy Efficiency Rating		Current	Potential
Very energy efficient - lower running costs			
(92 plus) A			
(81-91) B		82	82
(69-80) C			
(55-68) D			
(39-54) E			
(21-38) F			
(1-20) G			
Not energy efficient - higher running costs			
England & Wales		EU Directive 2002/91/EC	

Environmental Impact (CO ₂) Rating		Current	Potential
Very environmentally friendly - lower CO ₂ emissions			
(92 plus) A			
(81-91) B			
(69-80) C			
(55-68) D			
(39-54) E			
(21-38) F			
(1-20) G			
Not environmentally friendly - higher CO ₂ emissions			
England & Wales		EU Directive 2002/91/EC	