



Bridge House, Bridge Street, Leatherhead, KT22 8HE

£1,250 Per Calendar Month



- AVAILABLE IMMEDIATELY
- UNFURNISHED
- BOSCH APPLIANCES
- FULLY FITTED GERMAN KITCHEN
- PRIME TOWN CENTRE LOCATION
- GROUND FLOOR STUDIO APARTMENT
- HIGH SPECIFICATION THROUGHOUT
- PRIVATE TERRACE
- SMART VIDEO ENTRY SYSTEM
- WALKING DISTANCE TO MAINLINE STATION

Description

Experience bespoke living in this ground-floor studio apartment at Bridge House, positioned perfectly in Leatherhead's vibrant town centre. This contemporary property features a German built modern kitchen with stone worktops, under-cabinet illumination, and premium BOSCH appliances. The bathroom exudes elegance with a glossy vanity, illuminated mirror, and a deluxe rainfall shower. Wood effect flooring amplifies the aesthetic appeal of the studio and video entry system further amplifies the modern touch throughout. The property further benefits from a private, outside terrace off the main living space.



Situation

Leatherhead town centre offers a variety of shops, quality independent restaurants and coffee shops. Within the area there are highly regarded both state and private schools including St Andrews R.C. School, St John's School and Downsend School whilst at nearby Mickleham is Box Hill School.

Leatherhead's mainline railway station offers commuter access to London Waterloo & Victoria and access south to Guildford & Dorking. Junction 9 of the M25 at Leatherhead provides access to the national motorway network together with Heathrow and Gatwick Airports.

| | |
|------------------|---|
| EPC | C |
| Council Tax Band | C |



Approximate Gross Internal Area = 36.4 sq m / 392 sq ft

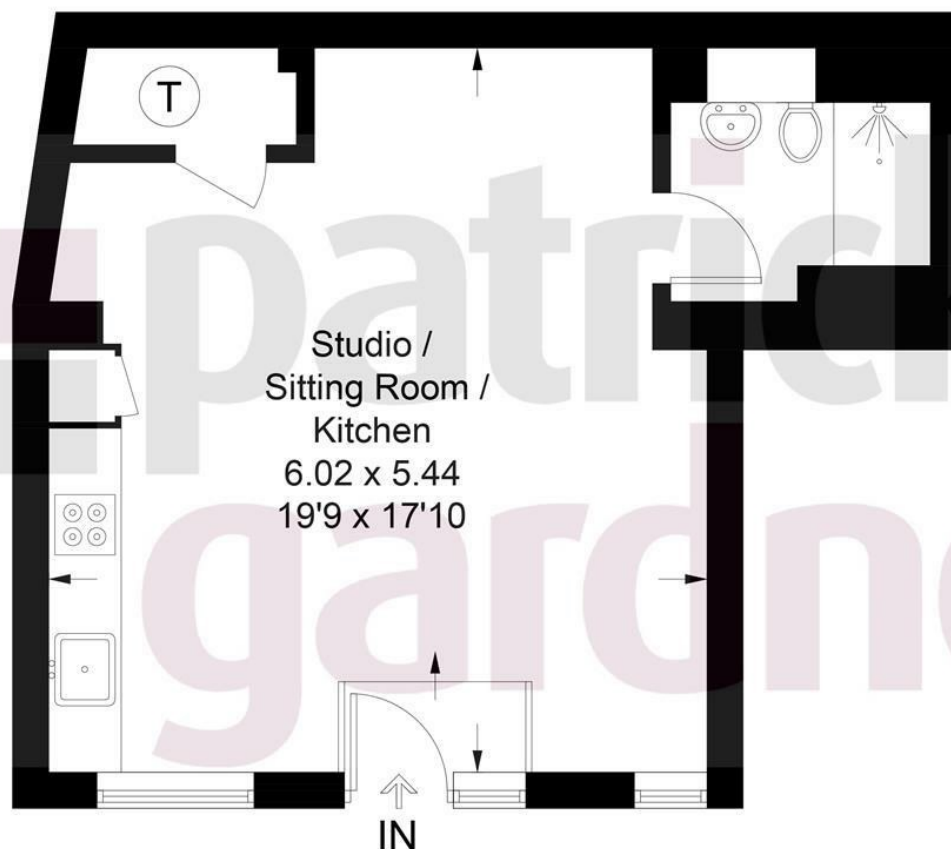

Ground Floor

This plan is for layout guidance only. Not drawn to scale unless stated. Windows and door openings are approximate. Whilst every care is taken in the preparation of this plan, please check all dimensions, shapes and compass bearings before making decisions reliant upon them. (ID1005596)
www.bagshawandhardy.com © 2023

1-3 Church Street, Leatherhead, Surrey, KT22 8DN
Tel: 01372 360444 **Email:** lettings@patrickgardner.com
<https://www.patrickgardner.com/>

These particulars, whilst believed to be accurate are set out as a general outline only for guidance and do not constitute any part of an offer or contract. Intending purchasers should not rely on them as statements of representation of fact, but must satisfy themselves by inspection or otherwise as to their accuracy. No person in this firm's employment has the authority to make or give any representation or warranty in respect of the property.