

PS

Flat 8, Chatsworth, 2 Westminster Road - BH13 6JR

Poole

£3,250 pcm



# Flat 8

## Chatsworth, Branksome

An exceptionally well-presented, three double bedroom, first-floor apartment enjoying the panoramic beach and sea views across Poole Bay. Located on the clifftop with direct access to the beach at Branksome Chine. This spacious apartment also benefits from a utility room and secure underground parking.

Chatsworth is a landmark development of just 14 apartments, overlooking the beach at Branksome Chine and sea views across Poole Bay from the Isle of Purbeck to the Isle of White. On entering this apartment you are immediately greeted by a feeling of light and spaciousness, with all of the principal rooms enjoying the panoramic sea views. The modern fitted kitchen/breakfast room has an abundance of floor and wall-mounted units, an island with a breakfast bar and integrated appliances. This leads through to the large and versatile lounge dining room, both benefiting from access to the balcony which spans the width of the apartment.

- Panoramic views
- Walking distance to Rockwater Restaurant
- 3 Double bedrooms
- Large living room
- Utility room
- 2 Secure underground parking spaces
- Unfurnished
- Available from mid-May 2025







The principle bedroom has an extensive range of fitted wardrobes, superb views and a fully tiled bath/shower en-suite. Bedrooms two and three have en-suite shower rooms and fitted wardrobes. There is also the added advantage of an additional cloakroom and separate utility room. The apartment has an allocated underground parking space, plus there is surface parking for visitors and a lift giving access to all floors. This modern development is positioned within mature and beautifully maintained grounds with a secure gate providing direct access to Branksome Beach.

Located on the cliff top, the apartment overlooks and enjoys direct access to Branksome Beach. The Village of Canford Cliffs, with its bakery, post office, restaurants and bars, is within 0.25 of a mile, whilst the larger shopping centre of Westbourne, with a selection of independently owned high-end shops, Marks and Spencers food hall and charming cafés, is within easy reach. The local train station at Branksome provides a direct line into London Waterloo in under 2 hours.

## Ground Floor

Approx. 160.1 sq. metres (1722.8 sq. feet)

Agents note: The internal layout of this apartment may vary from what is show as this is the floor plan of the Ground floor Apartment. eg. this does not show the fitted wardrobes and the kitchen layout differs.

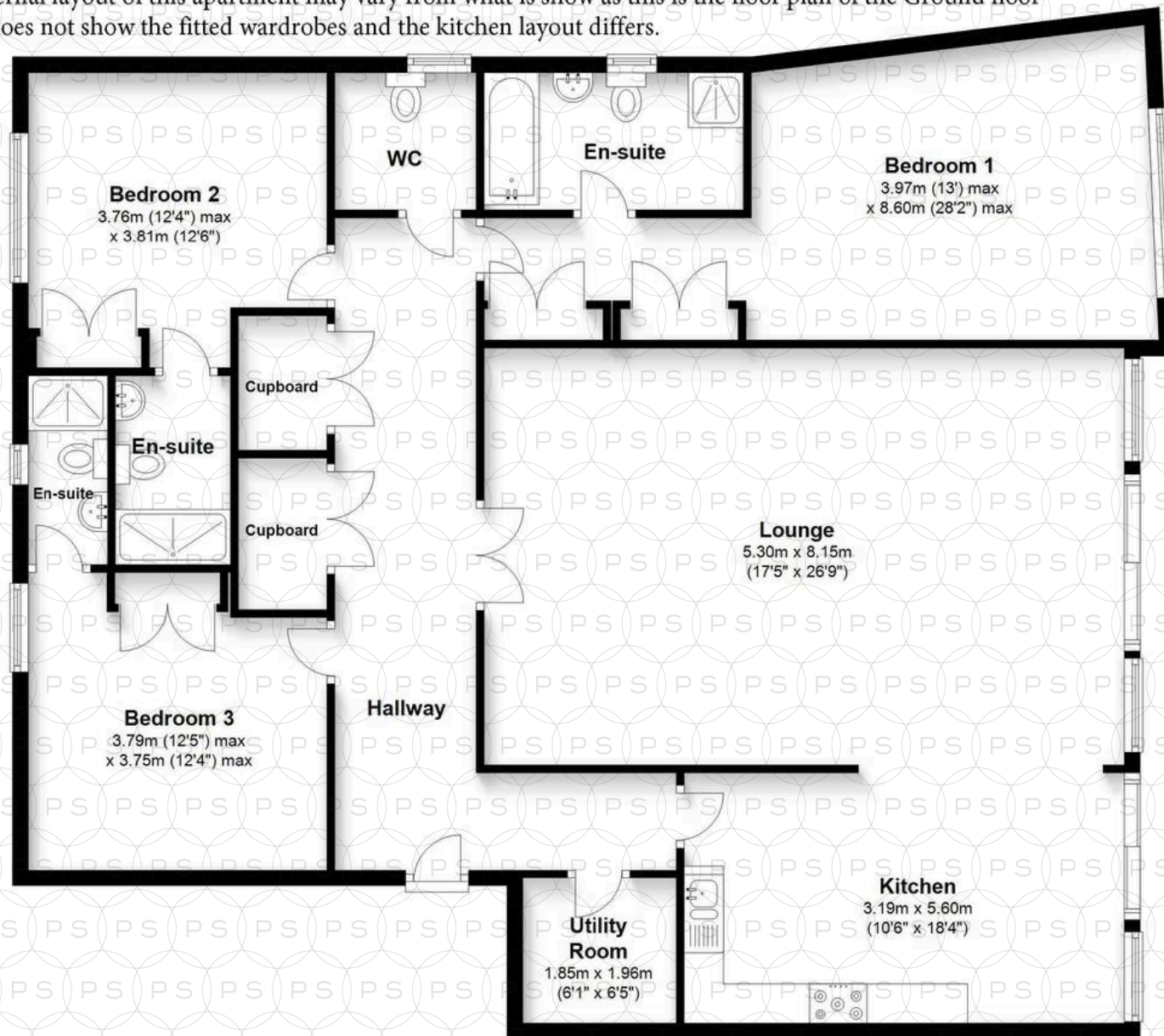

Total area: approx. 160.1 sq. metres (1722.8 sq. feet)

Bournemouth Energy Floor Plans are provided for illustration/identification purposes only. Not drawn to scale, unless stated and accept no responsibility for any error, omission or mis-statement. Dimensions shown are to the nearest 7.5 cm / 3 inches. Total approx area shown on the plan may include any external terraces, balconies and other external areas. To find out more about Bournemouth Energy please visit [www.bournemouthenergy.co.uk](http://www.bournemouthenergy.co.uk) (Tel: 01202 556006)

Plan produced using PlanUp.





## Philippa Sole Ltd

Philippa Sole, 3A Springfield Road, Ashley Cross - BH14 0LG

01202 747999 • [lettings@philippasole.co.uk](mailto:lettings@philippasole.co.uk) • [www.philippasole.co.uk](http://www.philippasole.co.uk)

All statements in these particulars are provided without responsibility on the part of Philippa Sole Ltd or the vendor. Neither Philippa Sole Ltd nor any individual employed by or acting on its behalf is authorised to make any representation or warranty regarding this property. Room measurements are approximate, and no detailed surveys, service inspections, or fittings tests have been conducted.