

## Fenshurst Gardens, Long Ashton

Asking Price £350,000

- Three Bedroom Mid Terrace home
- Offered With No Onward Chain
- Sitting Room with Glazed rear Extension
- Generous Master Bedroom
- Second Bedroom with Built In Storage
- Family Shower Room
- Rear Garden with South-Facing Aspect
- Allocated Parking Space
- Close Proximity to Birdwell Junior

### SUMMARY

Located within close proximity to the well-renowned Birdwell Junior School, this three bedroom terraced home offers spacious and light accommodation throughout. The ground floor consists of a kitchen with a range of base and wall units with worktop over, ceramic sink, space for oven, washing machine and fridge freezer as well as an extended living room with access to the rear garden. The first floor offers two double bedrooms and one single with the front bedroom benefitting from an open aspect to the North towards Providence Lane and Ashton Hill Woods and the back two bedrooms having an open aspect to the rear with superb views over local countryside. There is a family shower room with an enclosed corner cubicle, pedestal sink, WC and radiator. To the rear is a generous south facing garden with open views with patio area. To the front is a drive for allocated parking.



# Fenshurst Gardens, Long Ashton, BS41 9AX

Approximate Gross Internal Area = 71.5 sq m/ 769.6 sq ft

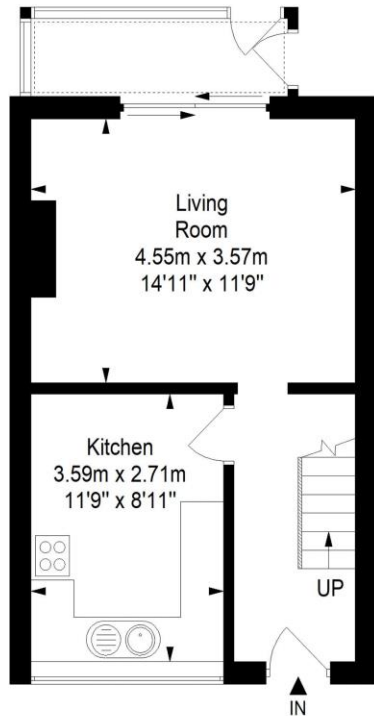

**Ground Floor**

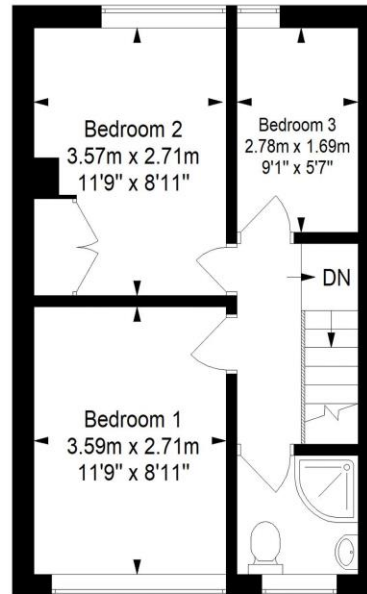

**First Floor**

This floor plan has been drawn using RICS guidelines (GIA)

Disclaimer : Please note this floor plan is for marketing purposes and is to be used as guide only.  
All Efforts have been made to ensure its accuracy at time of print



**Tenure**  
Freehold

**EPC Rating**  
C

**Council Tax Band**  
D

**Services**

AlexanderMay

Clifton : 01179 744 766  
Long Ashton : 01275 393 956  
Southville : 01174 523 700

