



191 High Street

Royston, Barnsley, S71 4RS

Offers Over £90,000



Presenting an attractive investment opportunity, this charming two-bedroom mid-terrace is situated on a desirable road in Royston, offering convenient access to all local amenities. With its prime location and potential rental income of £625pcm, this property is ideal for savvy investors seeking a promising venture. Don't miss the chance to capitalize on this lucrative opportunity. Contact us today for more details!



GROUND FLOOR

LOUNGE

Front facing reception room.

DINING KITCHEN

A range of wall and base units, worktop surface over which incorporates the sink unit, integrated oven, hob and extractor. Plumbing for a washing machine, rear facing double glazed window and door gives access to the rear porch.

CELLAR

FIRST FLOOR

BEDROOM ONE

Front facing double bedroom.

BEDROOM TWO

Rear facing bedroom.

BATHROOM

A three piece suite comprising shower cubicle, WC and wash hand basin.

OUTSIDE

There is a good size rear garden.

Area Map

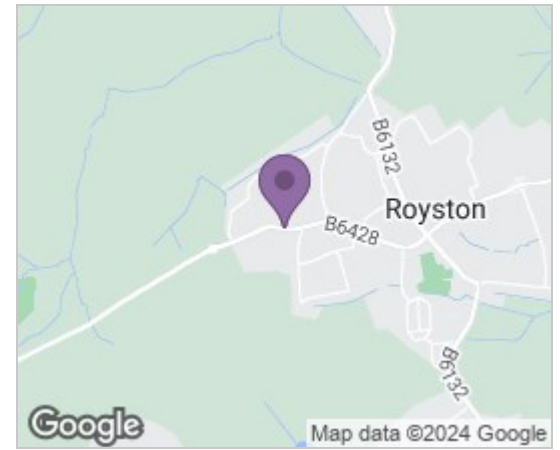

Floor Plans

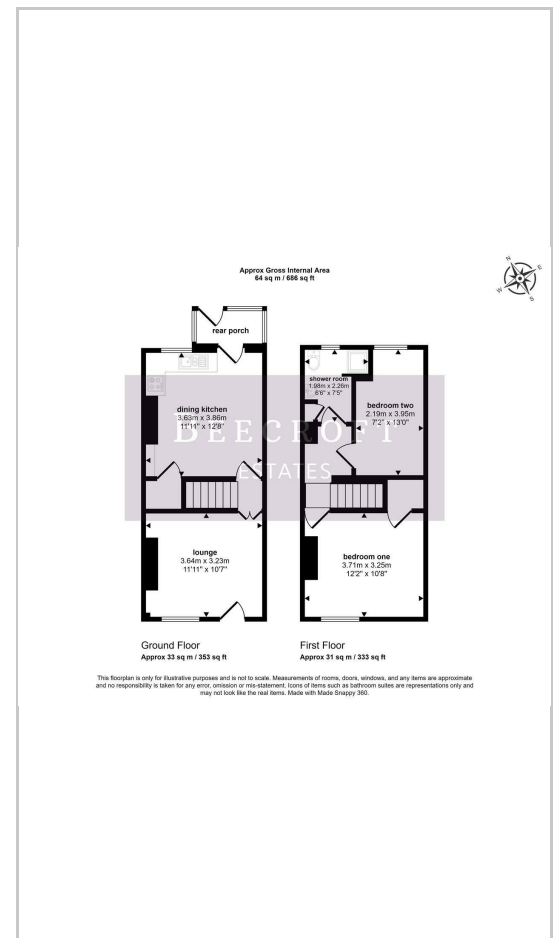

Energy Efficiency Graph

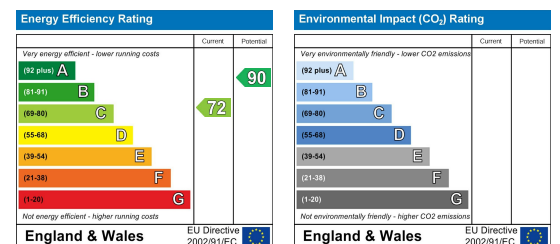

These particulars, whilst believed to be accurate are set out as a general outline only for guidance and do not constitute any part of an offer or contract. Intending purchasers should not rely on them as statements of representation of fact, but must satisfy themselves by inspection or otherwise as to their accuracy. No person in this firm's employment has the authority to make or give any representation or warranty in respect of the property.

Wombwell 6-8 Park Street, Wombwell, S73 0DJ

Tel: 01226 340110 Email: info@beecroftstates.co.uk www.beecroftstates.co.uk