



13 Hooper Street

Wath-Upon-Dearne, Rotherham, S63 6AX

Offers Around £90,000



NEST OR INVEST!!!

Situated in the sought-after town of Wath upon Dearne, this well-presented two-bedroom terrace home is perfect for first-time buyers or investors. Offering comfortable living with a kitchen-diner and a rear garden, this property provides great potential in a convenient location. Wath upon Dearne is a vibrant town with a mix of modern conveniences and historic charm. It boasts excellent transport links, great local amenities, and a strong sense of community, making it an ideal place to live or invest. This fantastic home is a great opportunity for buyers looking to step onto the property ladder or for investors seeking a solid rental opportunity.

Don't miss out – book your viewing today!



Lounge

A good-sized lounge with a front aspect, offering a bright and welcoming living space. The room features a wood-finished fire surround with a stylish brass-finished coal-effect gas fire, adding warmth and character to the space.

Kitchen/Diner

A spacious kitchen/diner featuring wood-finished wall and base units, complemented by an electric oven, gas hob, and a built-in extractor fan. The room offers ample space for a fridge freezer and includes a convenient storage cupboard. With a rear-aspect window and an external door leading to the garden, this space is bright, functional, and perfect for dining and entertaining.

Landing

Provides access to the loft.

Master Bedroom

A spacious and neutrally decorated master bedroom with a front aspect, allowing plenty of natural light to fill the room. The room benefits from a built-in cupboard, providing convenient storage while maximizing space.

Bedroom Two

A neutrally decorated second bedroom with a rear aspect, offering a bright and peaceful space. Perfect as a bedroom, home office, or guest room.

Bathroom

A well-appointed bathroom with a rear aspect, featuring part-tiled walls with a decorative border. The suite includes a bath with an electric shower and a glass shower screen, a pedestal wash hand basin, and a low-flush WC. A chrome-finished heated towel rail adds a modern touch and extra comfort.

Exterior

To the rear is a garden featuring a flagged patio, perfect for outdoor seating and entertaining, along with an area laid to lawn, providing a versatile outdoor space.

Area Map



Floor Plans

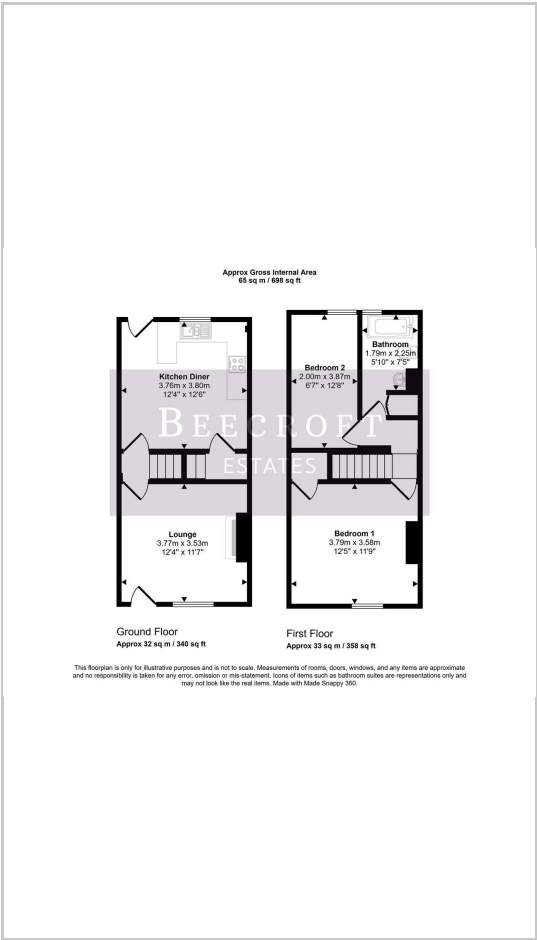

Energy Efficiency Graph

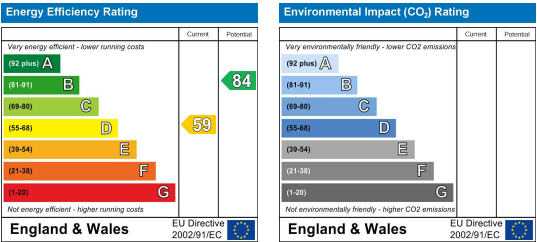

These particulars, whilst believed to be accurate are set out as a general outline only for guidance and do not constitute any part of an offer or contract. Intending purchasers should not rely on them as statements of representation of fact, but must satisfy themselves by inspection or otherwise as to their accuracy. No person in this firm's employment has the authority to make or give any representation or warranty in respect of the property.