



8 Holme Court

Goldthorpe, Rotherham, S63 9BX

£175,000



Situated in a peaceful cul-de-sac, this beautifully presented three-bedroom semi-detached home is ready to move straight into. The property features a spacious lounge, a well-appointed dining kitchen, a bright conservatory, and a modern bathroom. Externally, it benefits from off-road parking, a garage, and a well-maintained garden. With its versatile appeal, this home is ideal for a wide range of buyers.

CALL BEECROFT ESTATES TO BOOK YOUR VIEWING !



GROUND FLOOR

ENTRANCE HALL

Via a composite entrance door, sleek laminate flooring and stairs which rise to the first floor landing.

LOUNGE

A beautifully presented lounge having laminate flooring, media wall with electric feature fire, tv aerial point and radiator.

DINING KITCHEN

The well-equipped kitchen features a range of wall and base units, offering ample storage and a practical layout. The worktop surface seamlessly incorporates a sink unit with a modern mixer tap, freestanding oven, plumbing is in place for a washing machine, with dedicated space for a fridge freezer. A stylish breakfast bar creates a casual seating area, perfect for dining or socializing. Natural light fills the room through the window, while a door provides easy access to the conservatory, enhancing the flow of the living space.

CONSERVATORY

The conservatory offers a versatile additional sitting area, currently used as a stylish makeup room. Its large windows provide plenty of natural light, creating a bright and airy atmosphere. Overlooking the rear garden, the space enjoys peaceful views, making it an ideal spot for relaxation or personal use. Whether maintained as a beauty space or repurposed for lounging or dining, the conservatory adds valuable extra living space to the home.

FIRST FLOOR

BEDROOM ONE

The immaculately presented master bedroom offers a stylish and comfortable retreat, featuring a well-proportioned layout. A double-glazed window allows natural light to brighten the space, while a radiator ensures warmth and comfort. Finished to a high standard, this elegant bedroom provides a serene and inviting atmosphere, perfect for rest and relaxation.

BEDROOM TWO

The well-proportioned second bedroom offers ample space for furnishings and personal touches. A double-glazed window allows plenty of natural light to fill the room, while a radiator ensures warmth and comfort. Versatile and inviting, this bedroom is ideal for use as a guest room, home office, or additional sleeping space.

BEDROOM THREE

The third bedroom is currently used as a stylish dressing room, offering a bright and inviting space. A double-glazed window allows natural light to enhance the room, while a radiator ensures year-round comfort. The laminate flooring adds a modern touch, making this versatile room ideal for continued use as a dressing area or easily adaptable to suit individual needs.

BATHROOM

The bathroom features a modern three-piece suite comprising a bathtub with a shower over, a WC, and a wash hand basin. Part tiling to the walls adds a stylish and practical touch, ensuring easy maintenance. A heated ladder rail provides warmth and convenience, while the double-glazed window with obscure glazing allows natural light in while maintaining privacy. This well-designed space offers both functionality and contemporary comfort.

OUTSIDE

Outside, the property benefits from a driveway providing ample parking, along with a detached garage to the front for additional storage or vehicle space. To the rear, a beautifully enclosed garden offers a peaceful retreat, featuring a well-maintained lawn, a dedicated seating area perfect for outdoor relaxation, and a garden shed for added storage. This charming outdoor space is ideal for both entertaining and enjoying the fresh air in a private setting.

Area Map



Floor Plans

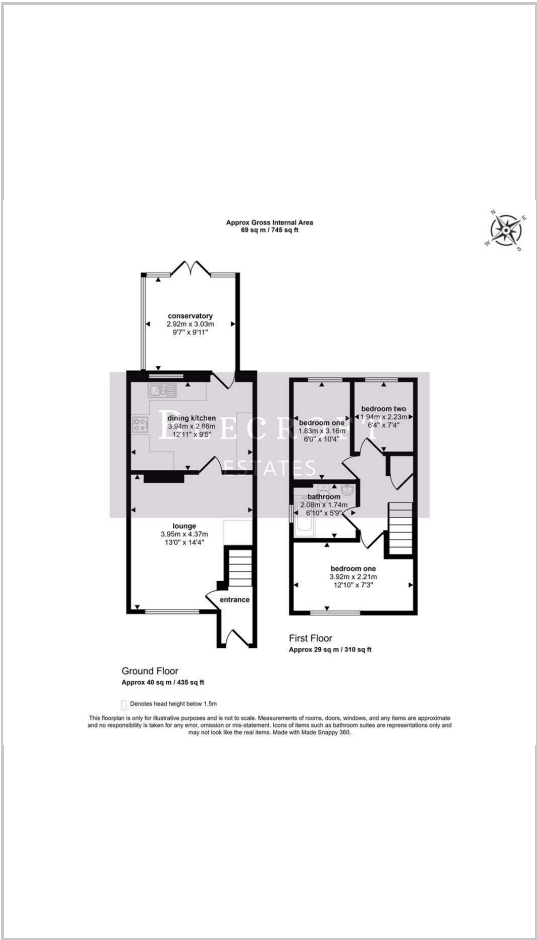

Energy Efficiency Graph

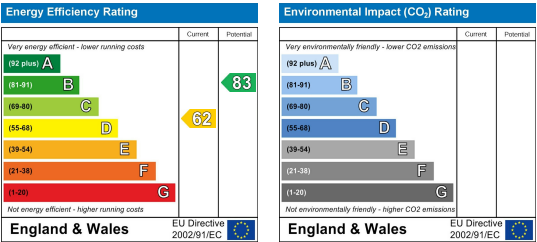

These particulars, whilst believed to be accurate are set out as a general outline only for guidance and do not constitute any part of an offer or contract. Intending purchasers should not rely on them as statements of representation of fact, but must satisfy themselves by inspection or otherwise as to their accuracy. No person in this firm's employment has the authority to make or give any representation or warranty in respect of the property.