



113 Blythe Street

Wombwell, Barnsley, S73 8LJ

£80,000



This three-bedroom terrace property, spread over three floors, presents a promising investment opportunity, particularly for those looking to expand their rental portfolio. With an expected rental income exceeding £650 per calendar month, the property holds potential for steady cash flow.

TO BOOK YOUR VIEWING CALL BEECROFT ESTATES !



GROUND FLOOR

LOUNGE

DINING KITCHEN

CELLAR

FIRST FLOOR

BEDROOM ONE

BEDROOM TWO

BATHROOM

SECOND FLOOR

ATTIC BEDROOM THREE

OUTSIDE

Area Map



Floor Plans

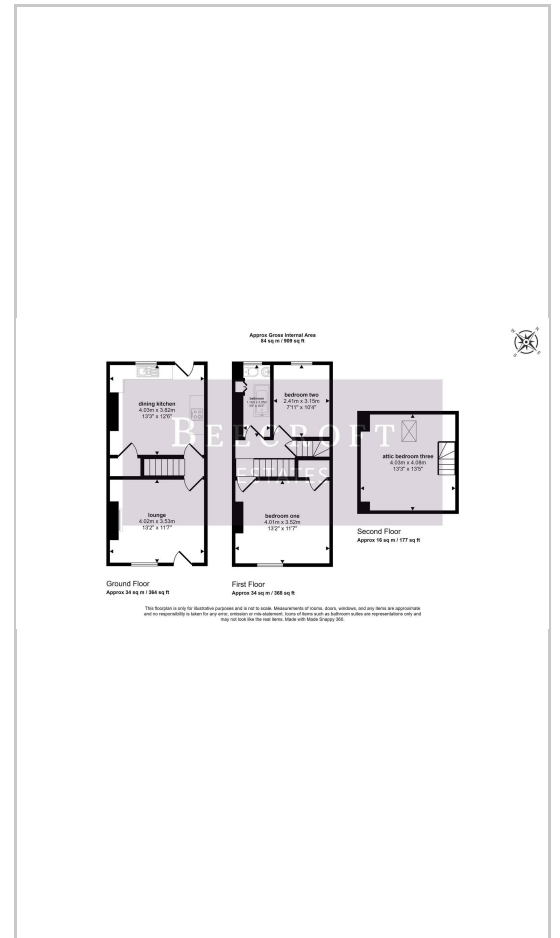

Energy Efficiency Graph

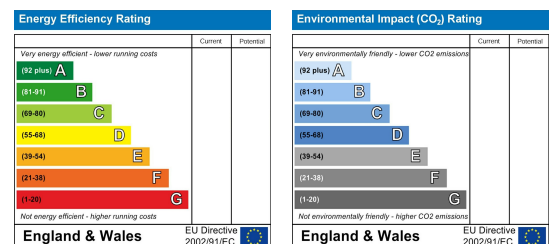

These particulars, whilst believed to be accurate are set out as a general outline only for guidance and do not constitute any part of an offer or contract. Intending purchasers should not rely on them as statements of representation of fact, but must satisfy themselves by inspection or otherwise as to their accuracy. No person in this firm's employment has the authority to make or give any representation or warranty in respect of the property.

Wombwell 6-8 Park Street, Wombwell, S73 0DJ

Tel: 01226 340110 Email: info@beecroftstates.co.uk www.beecroftstates.co.uk