



6 Bluebird Hill

Aston, Sheffield, S26 2GN

£210,000



Nestled in the sought-after locale of Aston, this residence enjoys close proximity to an array of local amenities, including esteemed educational institutions. Further enhancing its appeal is swift access to the motorway network, facilitating seamless connectivity. Sheffield and Rotherham, alongside prominent establishments such as Rotherham Hospital, Meadowhall retail complex, and Crystal Peaks shopping centre, are effortlessly within reach.

CALL BEECROFT ESTATES TODAY TO BOOK YOUR VIEWING !



GROUND FLOOR

ENTRANCE HALL

Having stairs which rise to the first floor landing.

LOUNGE

A good size reception room which has a front facing bay style window, tv aerial point, radiator and double doors lead to the dining room.

DINING ROOM

Having a rear facing double glazed window and radiator.

KITCHEN

Comprising a range of wall and base units, qworktop surface which incororates the sink unit with mixer tap, integrated oven with hob and extractor, plumbing for a washing machine and space for a fridge freezer. Rear entrance door and double glazed window.

FIRST FLOOR

BEDROOM ONE

A double bedroom having a front facing double glazed window and radiator.

BEDROOM TWO

A double bedroom having a rear facing double glazed window and radiator.

BEDROOM THREE

A good size third bedroom having a double glazed window and radiator.

BATHROOM

A three piece suite.

OUTSIDE

To the front is a garden area laid to lawn with a lengthy driveway to the side providing ample off road parking. To the rear is a good size garden area.

Area Map



Floor Plans

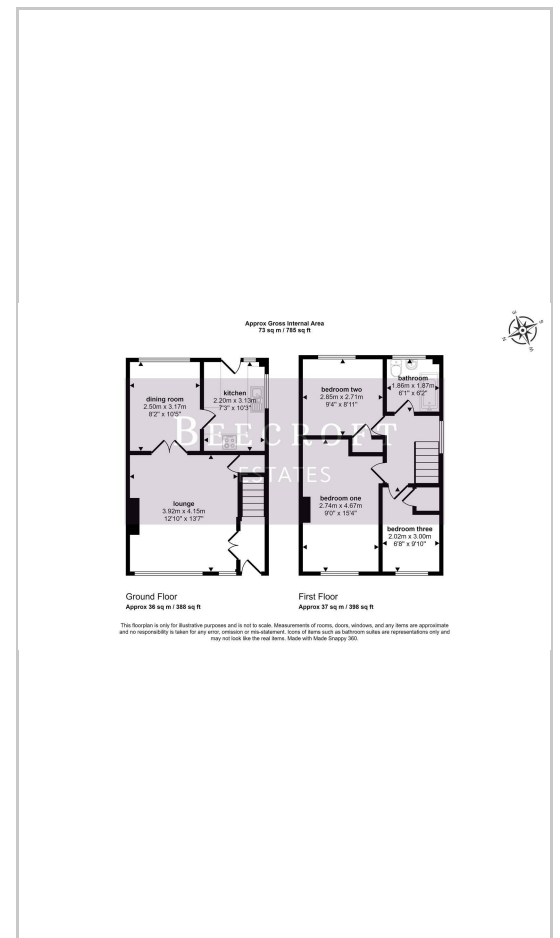

Energy Efficiency Graph

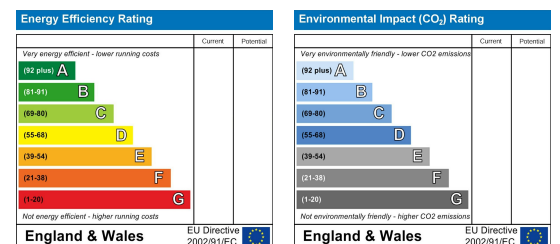

These particulars, whilst believed to be accurate are set out as a general outline only for guidance and do not constitute any part of an offer or contract. Intending purchasers should not rely on them as statements of representation of fact, but must satisfy themselves by inspection or otherwise as to their accuracy. No person in this firm's employment has the authority to make or give any representation or warranty in respect of the property.

Wombwell 6-8 Park Street, Wombwell, S73 0DJ

Tel: 01226 340110 Email: info@beecroftestates.co.uk www.beecroftestates.co.uk