



3 Ashfield Close

, BARNESLEY, S75 2PU

£365,000



Introducing a meticulously modernized 3 bedroom detached bungalow nestled in one of the most coveted areas, promising both luxury and convenience. This stunning property is situated on an expansive plot with a generously sized rear garden, offering ample space for outdoor enjoyment and relaxation. Step into contemporary elegance as this home boasts a complete modernization, featuring an outstanding kitchen and bathroom among its many highlights. With spacious interiors and versatile layout, this residence is sure to captivate a range of potential buyers seeking both style and functionality. Conveniently located near essential amenities, including the hospital and various shops, this property ensures effortless living. Its proximity to the M1 further enhances accessibility, making commuting a breeze and opening doors to endless possibilities.



ENTRANCE HALL

A fabulous and spacious entrance hall which is bright and welcoming.

LOUNGE

A good size reception room having a bay style double glazed window, side facing double glazed window, radiator and a feature electric fire.

BREAKFAST KITCHEN

This very well presented breakfast kitchen has a range of wall and base units, quartz worktop surfaces which incorporates the sink unit with mixer tap, integrated appliances include the oven, microwave, induction hob, washing machine, dish washer.

BEDROOM ONE

A double bedroom having a double glazed window and radiator.

BEDROOM TWO

A further double bedroom with a double glazed window and radiator.

BEDROOM THREE/DINING

Currently being utilised as a dining room, having a rear facing double glazed window and radiator.

OUTSIDE

Sat on an expansive plot with a generously sized rear garden, lengthy block paved driveway which in turn leads to the detached garage.

Area Map

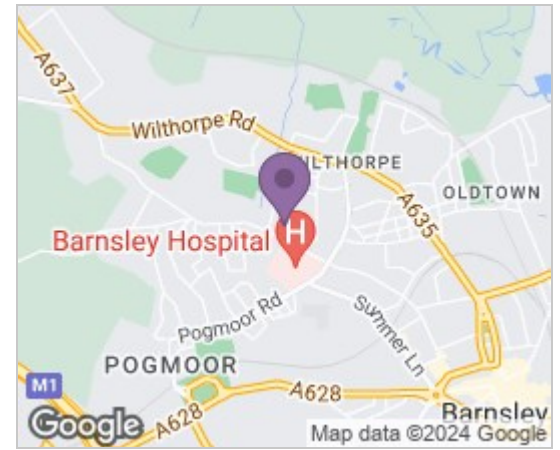

Floor Plans

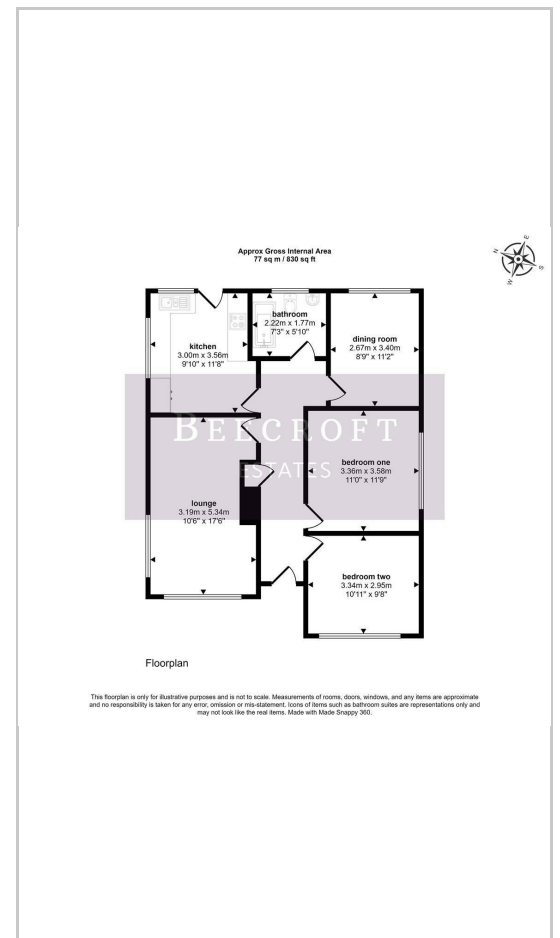

Energy Efficiency Graph

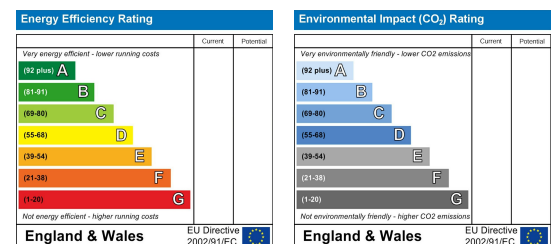

These particulars, whilst believed to be accurate are set out as a general outline only for guidance and do not constitute any part of an offer or contract. Intending purchasers should not rely on them as statements of representation of fact, but must satisfy themselves by inspection or otherwise as to their accuracy. No person in this firm's employment has the authority to make or give any representation or warranty in respect of the property.

Wombwell 6-8 Park Street, Wombwell, S73 0DJ

Tel: 01226 340110 Email: info@beecroftstates.co.uk www.beecroftstates.co.uk