



60 Woodbourn Gardens

Wombwell, Barnsley, S73 8FJ

£195,000



Nestled within a serene street, this charming home offers a blend of tranquility and convenience. Boasting a thoughtful layout across three floors, this property is well maintained and exudes a warm ambiance, making it an ideal haven for both growing families and couples alike.

The location is a standout feature, with excellent transport links and proximity to local amenities ensuring effortless daily living. Whether it's a quick commute or easy access to essentials, this residence offers the perfect balance of seclusion and accessibility.



GROUND FLOOR

ENTRANCE HALL

CONVERTED GARAGE

Currently utilised as a bedroom five but a very versatile space which could be a ground floor lounge and the first floor lounge become another bedroom.

DINING KITCHEN

DOWNSTAIRS WC

FIRST FLOOR

LOUNGE

BEDROOM TWO

BEDROOM THREE

HOUSE BATHROOM

SECOND FLOOR

MASTER BEDROOM

EN-SUITE

FOURTH BEDROOM

OUTSIDE

Area Map

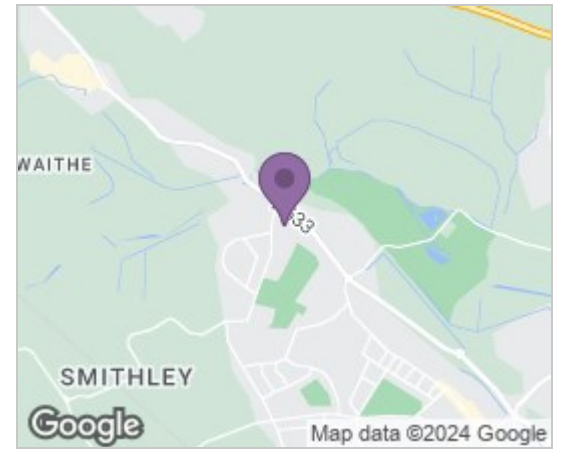

Floor Plans

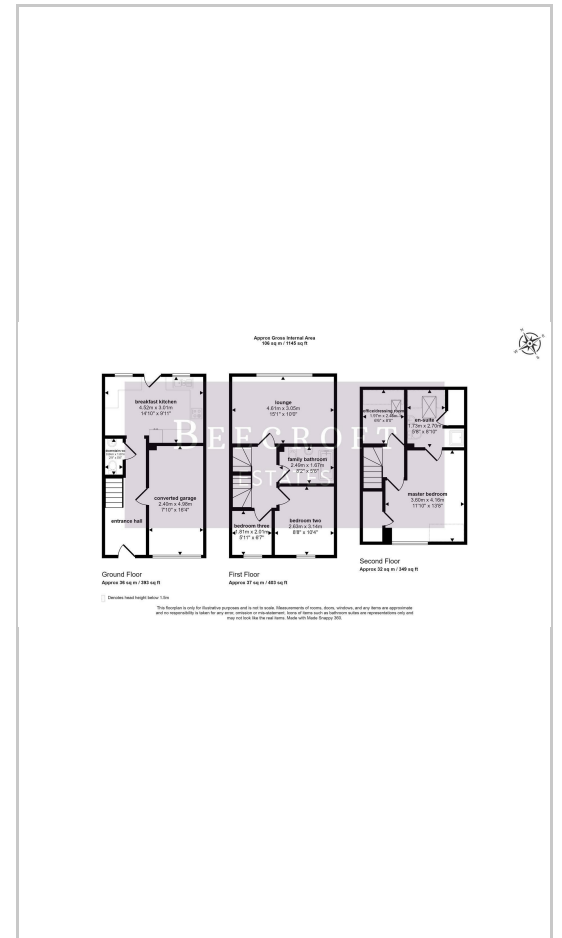

Energy Efficiency Graph

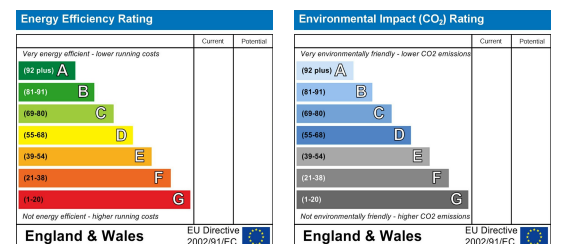

These particulars, whilst believed to be accurate are set out as a general outline only for guidance and do not constitute any part of an offer or contract. Intending purchasers should not rely on them as statements of representation of fact, but must satisfy themselves by inspection or otherwise as to their accuracy. No person in this firm's employment has the authority to make or give any representation or warranty in respect of the property.

Wombwell 6-8 Park Street, Wombwell, S73 0DJ

Tel: 01226 340110 Email: info@beecroftstates.co.uk www.beecroftstates.co.uk