



12 Victoria Road

Wombwell, Barnsley, S73 8JG

£80,000



Presenting an attractive investment opportunity, this charming two-bedroom mid-terrace is situated on a desirable road in Wombwell, offering convenient access to all local amenities. With its prime location and potential rental income of £575pcm, this property is ideal for savvy investors seeking a promising venture. Don't miss the chance to capitalize on this lucrative opportunity. Contact us today for more details!



GROUND FLOOR
 LOUNGE
 DINING KITCHEN
 BATHROOM
 FIRST FLOOR
 BEDROOM ONE
 BEDROOM TWO
 OUTSIDE

Area Map



Floor Plans

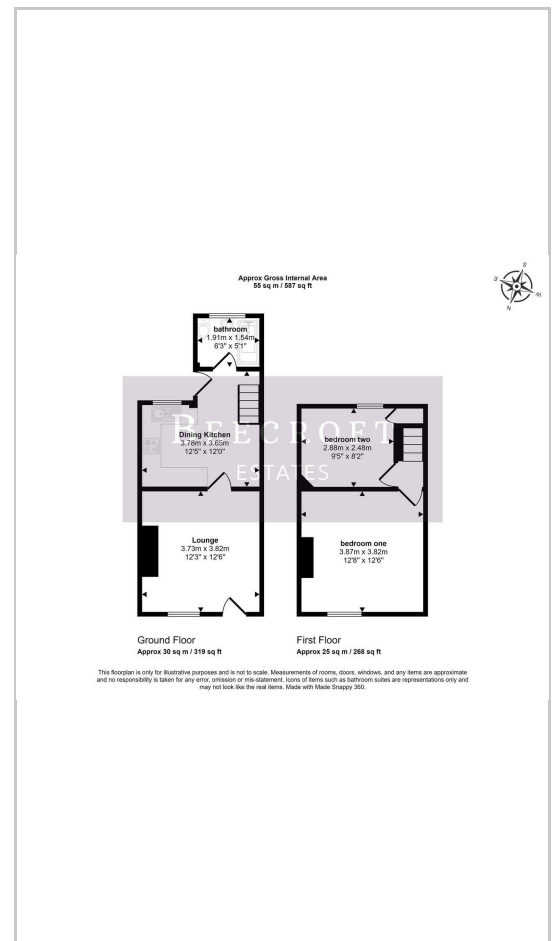

Energy Efficiency Graph

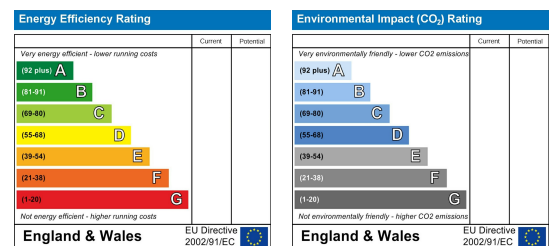

These particulars, whilst believed to be accurate are set out as a general outline only for guidance and do not constitute any part of an offer or contract. Intending purchasers should not rely on them as statements of representation of fact, but must satisfy themselves by inspection or otherwise as to their accuracy. No person in this firm's employment has the authority to make or give any representation or warranty in respect of the property.

Wombwell 6-8 Park Street, Wombwell, S73 0DJ
 Tel: 01226 340110 Email: info@beecroftestates.co.uk www.beecroftestates.co.uk