



9 Priory Gardens, Spetisbury, Dorset, DT11 9DS









**\*LOCATION LOCATION LOCATION\* - a unique opportunity to purchase this three bedroom detached bungalow, with direct river frontage onto the River Stour.**

Nestled in the tranquil setting of Priory Gardens, this spacious three-bedroom detached bungalow presents a rare opportunity to acquire a home with direct river frontage and a generous garden that leads right down to the water's edge. Perfectly positioned on a quiet residential street, the property boasts excellent potential for modernisation, allowing buyers to create their dream home in a truly idyllic location.

The accommodation includes a bright and airy dual-aspect living room with picturesque views over the garden, a separate dining room, kitchen, three well-proportioned bedrooms, a family bathroom, and an additional WC. The layout offers excellent flow and flexibility for families or those seeking single-level living.

Externally, the property shines with its beautifully stocked garden, offering mature planting, lawned areas, and a ideal spot ideal for nature lovers or boating enthusiasts. Ample driveway parking is available, along with a particularly useful lower ground floor area comprising three generous store rooms that could serve a variety of purposes, including workshop or hobby space.

While in need of updating, this home represents a fantastic opportunity to enhance and personalise a well-located riverside property.

£575,000 Freehold



# 9 Priory Gardens

Approximate Gross Internal Area  
1324 sq ft - 123 sq m

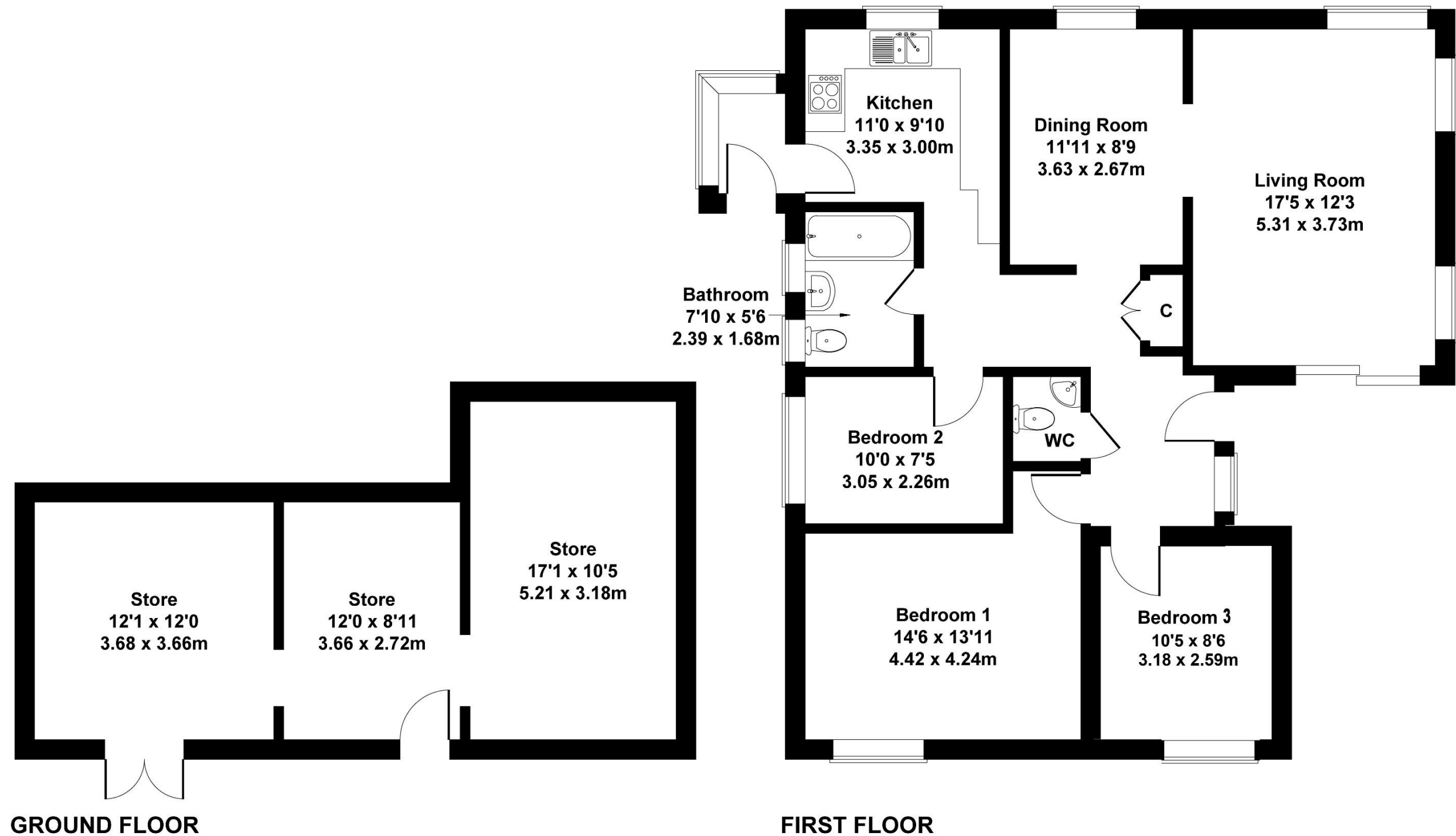

Not to Scale. Produced by The Plan Portal 2025  
**For Illustrative Purposes Only.**

Please note Forum Sales & Lettings and their client give notice that:

1. They have no authority to make or give any representation or warranties in relations to the property. These particulars do not form part of any offer or contract and must not be relied upon as statements or representations of fact.

2. Any areas, common measurements or distances are approximate. The text, photographs and plans are for guidance only and are not necessarily comprehensive. It should not be assumed that the property has all necessary Planning, Building Regulations or other consents and Forum Sales and Lettings have not tested any services, equipment or facilities. Purchasers must satisfy themselves by inspection or otherwise.

EPC Rating - C

Viewing Arrangements - Strictly by appointment with Forum Sales & Lettings

15 Salisbury Street, Blandford Forum, Dorset, DT11 7AU

Tel: 01258 459600